

LEORA COLLEZIONE

Sink Mixer 200mm Curved Spout

Product Specifications

LUCENT[®]

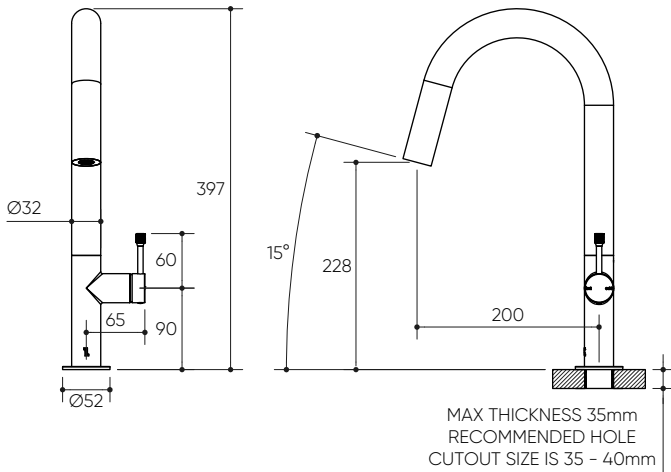

Style Switch

Specifications

Temperature Rating: 1-75°C

Pressure Rating: 150 - 1000kPa

Features

360° Swivel Spout for Enhanced Functionality

25mm Ceramic Mixer Cartridge with 20 Year Warranty

Highly Durable, Solid Brass Construction

Hidden Aerator for a Sleek, Stylish Appearance

Long Lasting, Hard Wearing, High Quality Finishes

Designed in Australia

Complete Kit Code

Finish

18003PBG	● Brushed Gold
18003CP	● Chrome
18003PBN	● Brushed Nickel
18003PGM	● Gun Metal
18003PCB	● Chocolate Bronze
18003PMB	● Matte Black



For more information, contact:
P. 1300 474 714 E. info@lucentdesigns.com.au
Lucent, 15 Activity Crescent, Molendinar, Queensland 4214 Australia

All rights reserved 2024 Lucent. The images shown are for illustration purposes only and may not be an exact representation of the product. Modifications and adjustments may occur over time and the product should be used to confirm marking out and/or rough in as line drawings shown may vary from the item supplied over time. All measurements are in Millimetres and Colours are indicative and may vary from the images shown. Commercial and residential warranties may differ. Please refer to our website for full terms and conditions. <https://lucentdesigns.com.au/pages/warranty>

