

BICYCLE BABY TRAILER



(Instruction and safety manual)

- TRAILER COMPONENTS

1. all weather cover
2. tow bar and hitch connector
3. tow bar receiver
4. removable handlebar
5. 5 point safety harness
6. push button release wheels
7. brakes
8. frontal wheels (Optional)
9. rear window
10. rear storage



- TRAILER COMPONENTS

- 1. trailer body
- 2. cover
- 3. rear wheels
- 4. tow bar
- 5. left brake
- 6. right brake
- 7. hex key
- 8. safety flag
- 9. hitch connector
- 10. frontal wheels with screws (Optional)
- 11. rear handbar



MAIN FRAME ASSEMBLY

1. Remove all the trailer parts from the box
2. Open the rear storage area
3. While holding the upper frame in the raised position, pull the seat frame (A) back and towards you.
4. Close the paddle latches on each side of the frame to lock the frame in place
5. Check that both paddle latches are engaged and secure
6. To fold the trailer simply reverse the above steps. The trailer can be folded with or without the wheels on. If the wheels are removed, they can be stowed inside the trailer when not in use.



MOUNTING THE WHEELS

1. Push in the rubber button on the outside of the wheel hub
2. Insert the wheel axle into the axle receiver on the trailer frame
3. Pull firmly on the wheel to confirm the axle is fully engaged and locked
4. To remove the wheels push in the rubber button and pull the wheel out

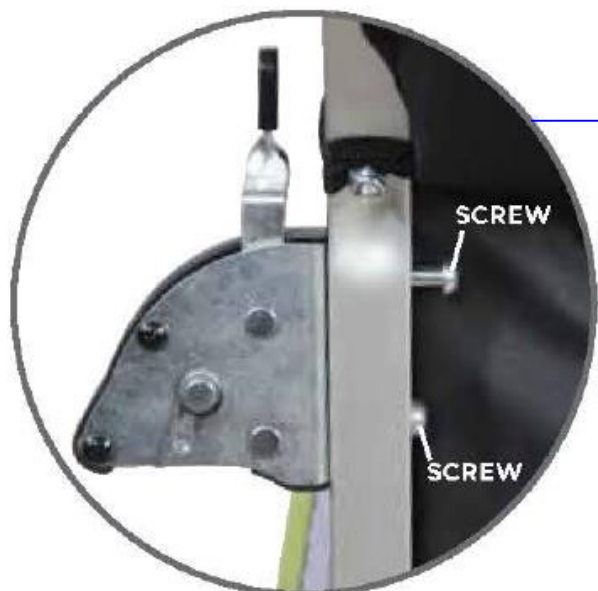

INSTALLING THE BRAKES

1. Lean the trailer backwards so that it rests on the handlebar and front of trailer is pointing upwards
2. Locate the two holes in the trailer frame just forward of the rear wheels
3. Place screws through holes in frame, from inside to outside, as shown
4. Place the brake assembly against the frame and use the hex key wrench provided to tighten the screws until snug



USING THE BRAKES

To operate brake, simply move lever outward to contact tire. Release by pushing the lever in toward frame as shown.

NOTE: this brake is self-adjusting to tire wear, but for best function, make sure to keep tires within the recommended pressure on sidewall and replace tires when you notice visible signs of wear

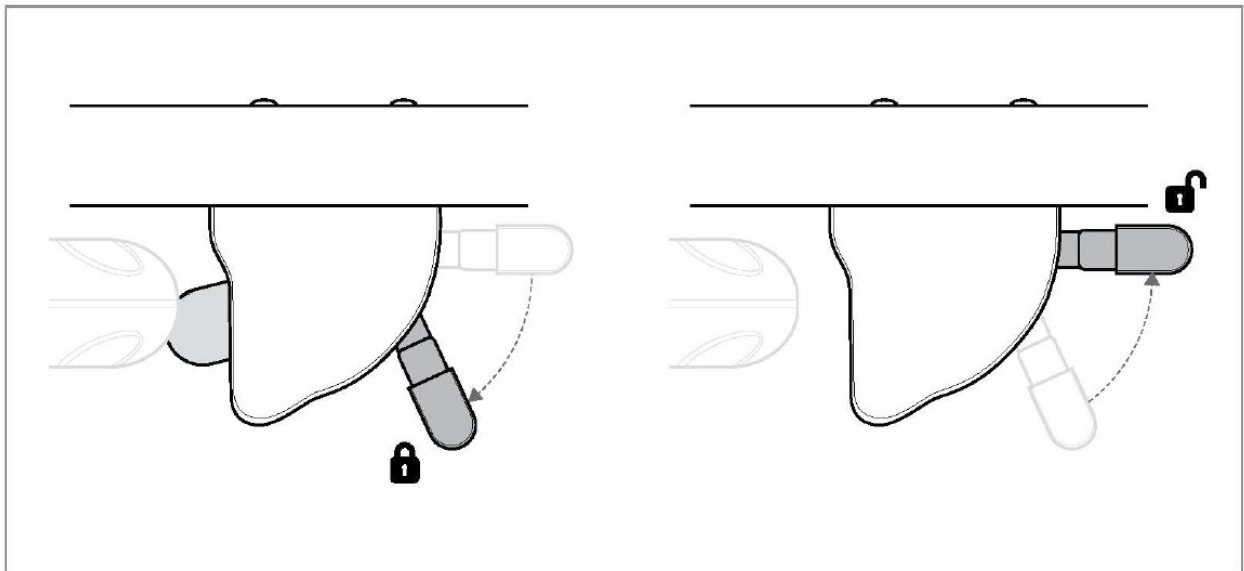

ATTACHING THE COVER

1. Clasp the top and bottom buttons
2. Make sure the buttons tightly on both sides



SECURING YOUR CHILD

1. *Unclip the buckles on the crotch strap and waist belt.*

Place your child in the seat.

2. *Place the padded shoulder harness onto the child's shoulders and adjust the vertical straps as needed. Buckle the crotch strap to the shoulder harness.*

3. *Buckle the waist strap and adjust so you can fit average size fingers between belt and your child. The buckle should be centered in your child's abdomen*

NOTE: before loading or unloading your child, the rear brakes must be engaged to prevent rolling.

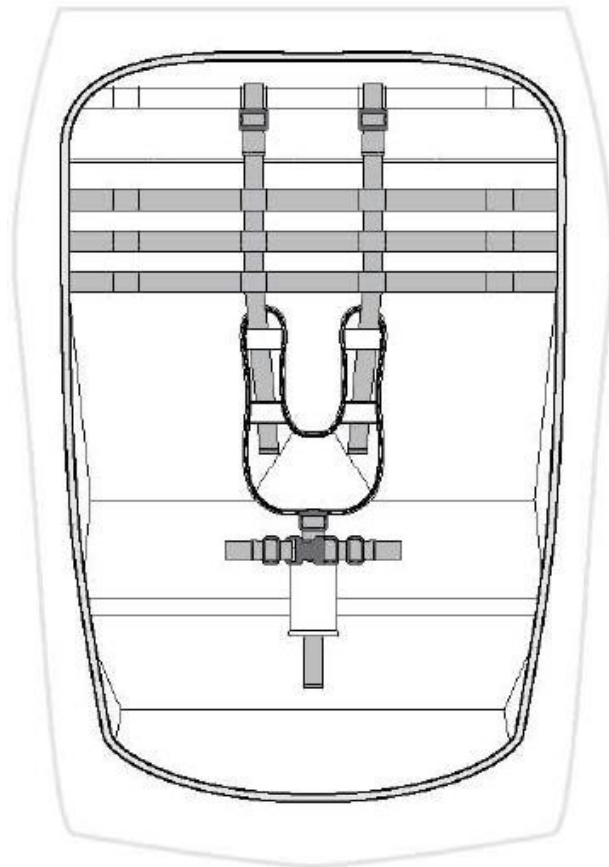

ADJUSTING THE SHOULDER HARNESS

Adjust the vertical straps so the shoulder harness fits snugly on your child's shoulders and the bottom of the harness is centered in your child's lower chest.

You can increase or decrease the number of loops the vertical straps are fed through to raise or lower the height of the shoulder harness



Your trailer is designed to attach easily to just about any full-size bicycle (with “quick release” or “hexagonal nuts”. Once installed the hitch connector can be left on the bicycle and the trailer released using the lock pin. The hitch connector must be attached to the left rear axle of the bike. Do not attach to any cycle where it cannot attach to the axle. This trailer is not designed to be used with electric bikes or motorcycles. Additional hitch connectors for use on multiple bikes can be purchased at www.papilioshop.it

MOUNTING THE TOW BAR

1. Unlock the lock pin and unfold the tow bar under the trailer
2. Fix the tow bar in the new position

IMPORTANT: Ensure that lock pin is securely locked, because it may cause a loss of control of the trailer while riding.

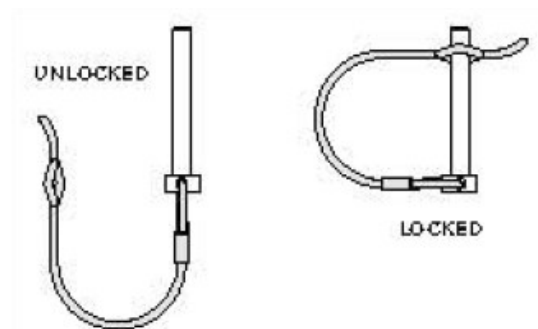

ATTACHING THE HITCH CONNECTOR TO A BIKE

1. Remove the quick release or hexagonal nut from the left side of the bikes rear axle
2. Install the hitch connector between the quick release or hexagonal nut and the bike frame
3. Tighten the quick release or hexagonal nut

Additional hitch connectors for use on multiple bikes can be purchased at www.papilioshop.it

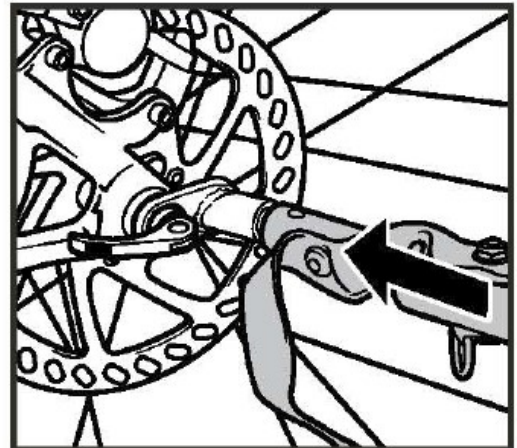
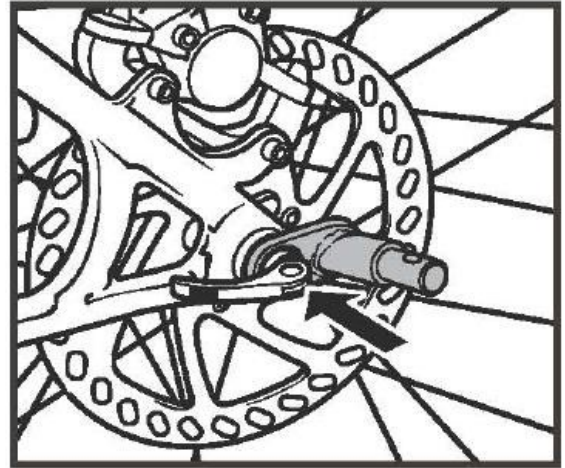

ATTACHING/REMOVING THE TRAILER TO A BIKE

1. Insert the hitch connector in the tow bar and line up the 2 holes
2. Insert the lock pin through the tow bar and into the hole in hitch connector. Once the pin is through, rotate the spring clip up and over until it snaps into place over the pin head. Give the pin a tug to be sure it is secure
3. Wrap the safety strap around the frame of the bike and latch to the D-ring on the tow bar
4. To remove the trailer reverse the above steps. The hitch connector can remain on the bike when the trailer is removed

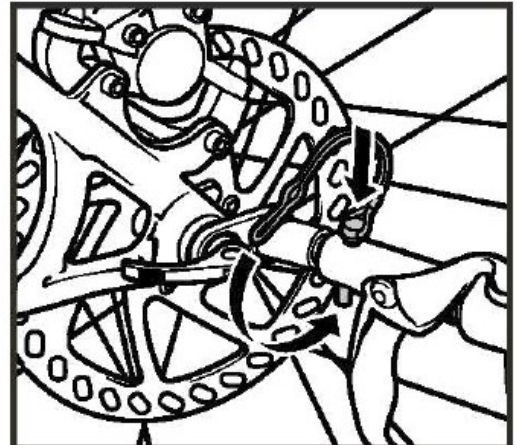

ATTACHING THE SAFETY FLAG

1. Assemble the flag
2. Insert the end into the small sleeve on the right side of the trailer body

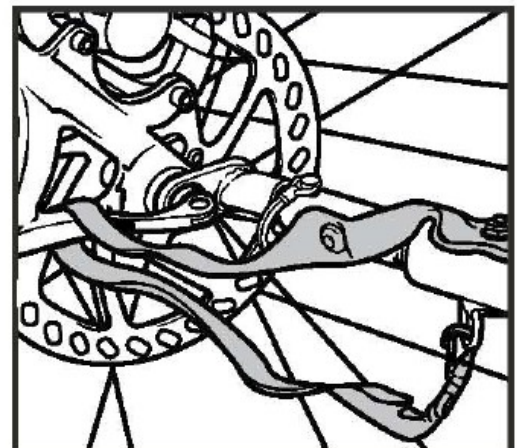
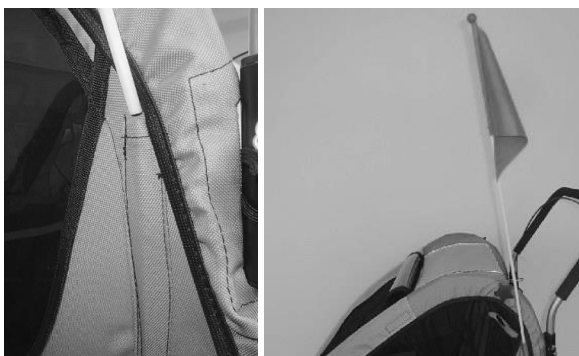



(STROLLER MODE)-(Optional)



MOUNTING THE PUSH BAR

1. Take out the push bar from carton
2. Insert the push bar on the bracket
3. Install the quick release pin and make sure it locked

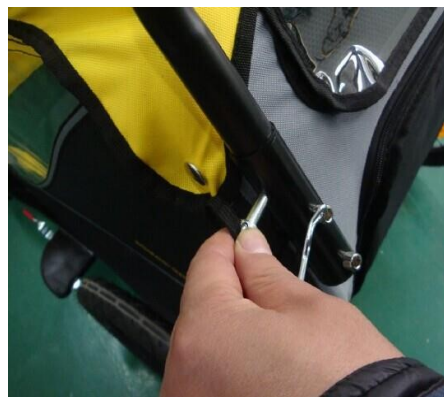

MOUNTING THE FRONTAL WHEELS

1. Insert the stroller kit on the bracket
2. Lock with screw



GENERAL MAINTENANCE

From time to time check your trailer for loose hardware, worn parts, torn materials or stitching. Repair or replace parts as needed.

Do not make any modifications to the trailer. Be sure that the trailer and bike are in good working conditions. A bike dealer can help you with inspection and maintenance.

Do not use cleaning solvents, clean only with mild soap and water.

1. *Inspect the trailer and its parts before and after each use*
2. *Do not use with children under 8-10 months*
3. *Children should wear approved safety helmets*
4. *Have always wear seat belts to children*
5. *Never leave children in the trailer unattended*
6. *Do not overload the trailer beyond the weight limit (40kg)*
7. *Do not place more than 5kg in storage compartment. Accessories or parcels placed in trailer may cause it to change balance and become unstable.*
8. *Do not exceed the maximum speed of 16 km/h*
9. *Do not use the protection of rain in the hot days*
10. *When not in use place the trailer in a dry place away from direct sunlight. Do not expose to extreme heat the trailer or rigid and high humidity*
11. *Before each trip check the integrity and condition of the trailer*
12. *The tire pressure should be 40 to 65 PSI (2.0 to 2.8 BAR) or as indicated on tire sidewall.*
13. *Use only on paved roads*
14. *Do not use at night*
15. *This trailer is not suitable for the installation of gear, car seats, bouncers, etc..*