

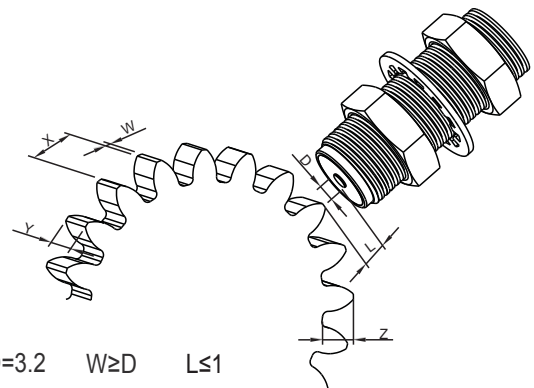

This sensor applies induction to measure the speed, and it has big output signal, good anti-interference, no need of amplification or external connection of power supply. It can be used under severe circumstances, such as, smog, oil, moisture, etc.

Model	Description
MPU	Magnetic Pick-Up Sensor

Resistance	1200 Ohms @ 25°C
Inductance	560 mH @ 1 KHz
Insulation resistance	> 2MΩ
Cable length	550 mm
Protection	P65
Working temperature	-25°C ~ +85°C
Quake-proof level	accord with QC/T 413

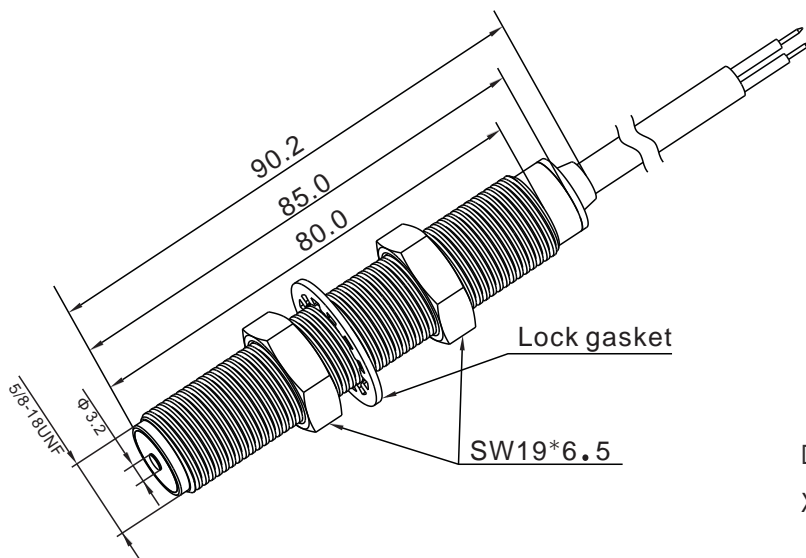

Proudly distributed by:



16 Parkinson Lane  
O'Connor WA 6163  
Australia

**Phone** +61 8 9331 3100  
**Fax** +61 8 9331 5150  
**Email** [mail@amelec.com.au](mailto:mail@amelec.com.au)  
**Web** [www.amelec.com.au](http://www.amelec.com.au)