



HEAVY DUTY TAILORED CAR SEAT COVERS

Dear Customer,

Your covers are custom-made and tailored to fit your exact vehicle. As opposed to universal covers, the fit should be tight and snug, and fitting times will vary depending on your vehicle. It is advisable to allow up to 45 minutes to install these. If your covers initially appear ill-fitting, don't be afraid to push/pull the cover to fit the contours. Ensure all ties, latch hole provisions or gaps for armrests (if applicable) are fitted correctly.

Please refer to the fitting instructions overleaf.

GETTING IN TOUCH

If you have any questions, or if, for some reason, you are unhappy with the fit of your product, please send a photo of your covers fitted or attempted to be fitted to: admin@airplex.co.nz in the first instance. A member of our team will be in touch to solve any issues as quickly as possible.

WARRANTY AND GUARANTEE

Your custom-fit covers are protected by a minimum 12-month manufacturer's warranty and are guaranteed to be free of defects in material and workmanship at the time of sale. Please refer to the Terms and Conditions on our website for full information regarding what is and what is not covered by our warranties.

We thank you for your business!

The team at Airplex

CAUTION: Use caution when feeding straps through under seat. Sharp edges could be present.

AIRBAG DISCLAIMER

This product is suitable for cars with or without static seat side airbags. Correct initial fitting & securing of this seat cover to your vehicle is essential to allow deployment of seat airbag. Incorrect fitting can prevent the seat airbag from being correctly deployed.

These seat covers must only be used for cars that have an integrated side airbag where the unfolding of the airbag takes place using an inflation control seam. The airbag deploys from the centre of the side of the seat closest to the car door. (Please note the "airbag deployment zone" in the illustration). The seam is located in the area from forward edge (A) to the outside rear edge (B) of the seat back. Airbag labels and seams are sewn on both sides of the seats.

If the seat cover is moved from its intended placement for any reason, you must ensure it is placed in its correct position before use. See illustration and fitting instructions.

If for any reason the side airbag fails to open, the manufacturer will not be held responsible.



Airplex Industries Ltd

PH: 0800-AIRPLEX | E: info@airplex.co.nz | 21 Saleyards Road, Otahuhu, Auckland 1062

1. Identify Each Piece bases may look the same but there are slight differences to the measurements both sides of each back rest Fig 12. Next look for the base label - DRIVER or PASSENGER. Often the bases may look the same but there are slight differences to the measurements.

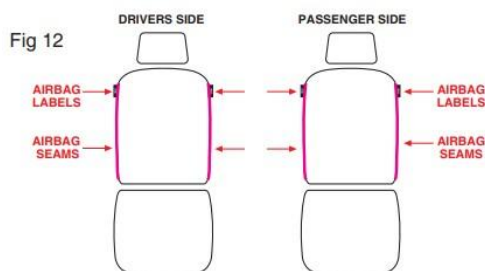

2. Seat Preparation

Remove head rests

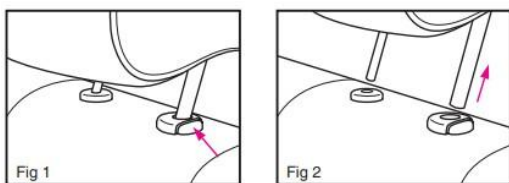

1. Depress button
2. Slide out head rest
Note some head rests might require an additional step to disengage the headrest from the seat. Check owners manual for more information. Modern vehicles may have active head rests and may not be removable. If this is the case our pattern has been designed to be fitted without removal Fig 1 & 2

3. Fitting base Cover

Unhook flap. Many modern vehicles today have a protective flap at the base of the backrest. If your vehicle has one this needs to be temporarily moved out of the way to feed through the ties. Fig 3 & 4.

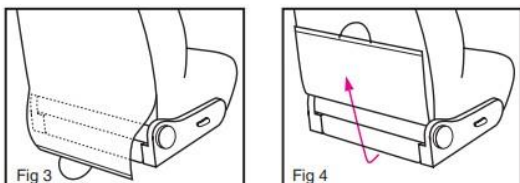

Fit the base cover by aligning the seam edges with the edge of the seat, push the D ring through back rest and base section Fig 5A. Feed front tie Fig 5B underneath seat towards rear. Side velcro ties can either be threaded between plastic side trim & cushion or wrapped around plastic sides. Then from under the seat feed B through A Fig 5. Mate C & D together Fig 6 after removing red fabric.

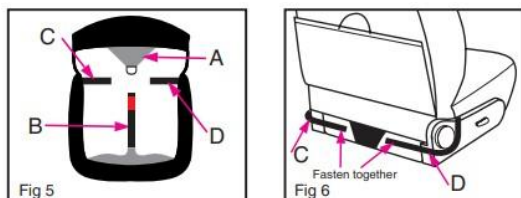

4. Fitting Back Rests

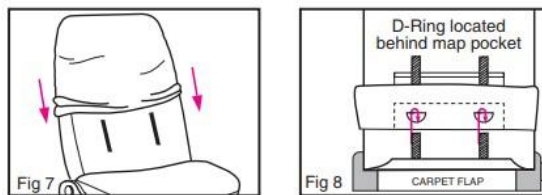

Fit the backrest section of the seat cover by sliding it down back and forth until the top of the cover reaches top of the seat. Align seams with edge of seat, fit so face panel is not twisted and smooth out fabric against seat to reduce creases Fig 7.

Feed the front velcro through backrest and seat base so the velcro can be connected at the rear of the seat. From the rear feed velcro through plastic D ring located behind map pocket then connect on to itself Fig 8. Then connect male velcro to carpet flap. If no carpet flap fitted on seat then cut velcro off.

Tying Back Rest Covers

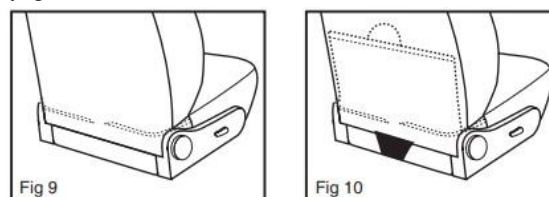

At this stage of fitment you can choose to replace the flap and feed the ties either side of the flap Fig 9.

OR leave the flap folded up inside the seat cover and tie the front backrest ties to the rear backrest ties Fig 10.

5. Fitting Head Rests

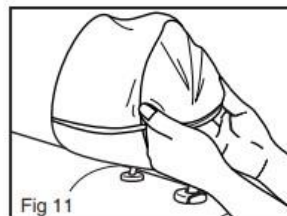

Refit head rest into the seat before fitting the head rest cover. Slide head rest cover on from side to side and smooth any wrinkles.

To get the best out of your seat covers below are some important tips:

1. Properly fitted seat covers will not slip and slide and will last longer than poorly fitted seat covers.
2. The ties are designed to keep them in place, they do not need to be over tensioned.
3. Tuck and tidy straps, consider if you cut ties it might be hard to fit again if you wash your covers. 4. After 1 month it is recommended to re-tension ties if required.