

FITTING INSTRUCTIONS FIT1364

PLEASE READ INSTRUCTIONS COMPLETELY BEFORE INSTALLATION

ROLLING LID – MANUAL KIA TASMAN

RL131M-K

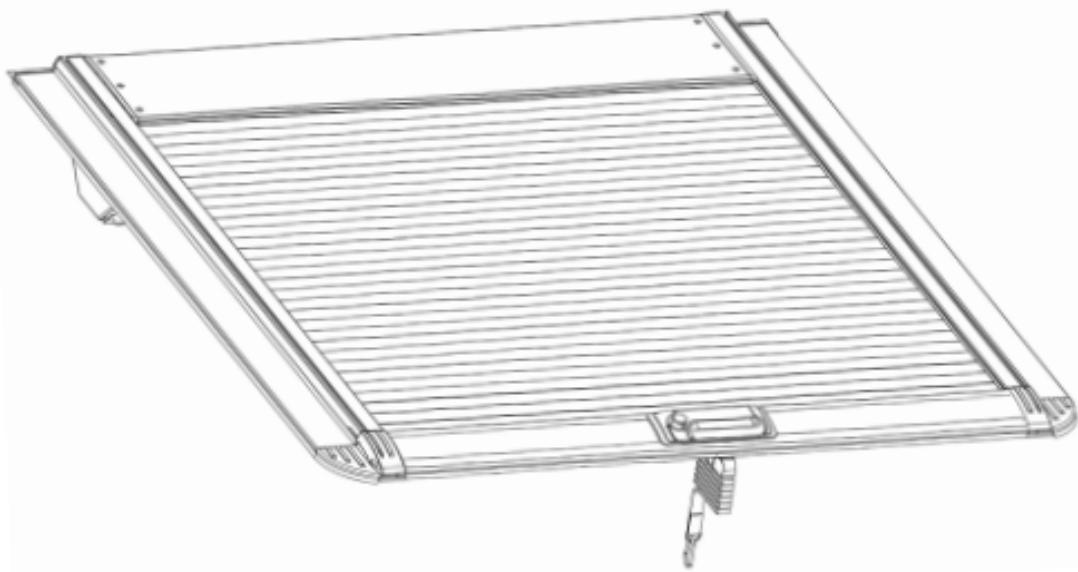

1. Matters need attention:

1. Please install the parts in a safe environment, and wear the corresponding safety protective equipment.
2. Please read this manual carefully before installing the product, pay attention to protect the surface of the vehicle, and avoid scratches during the installation process.
3. Check whether the parts in the package are complete before installation.
4. Please regularly check whether all the parts connected to the car are loose to ensure the safety of use.
5. Use traces between the slide track and the rolling curtain are normal test traces.
6. this curtain has no load-bearing function, do not place the heavy object above the curtain.
7. The drainage pipe passes through the drainage hole of the rear tail box.
8. Before folding up the curtain, make sure to ensure that the surface is clean to avoid foreign bodies involved in the box.

2. Kindly reminder:

1. When the curtain is opened or closed, pay attention to check whether there is foreign body, avoid the human body contact with the opening and closing area, and avoid pinching.
2. When the box body and the side rod slide rail are installed, the rolling shutter has the automatic return function. Please pay attention to the stability to prevent clamping.
3. Please do not close the pet or person in the closed rear tail box, which may cause suffocation.
4. The number of people installing the curtain is recommended to be 2, and the installation time is about 45 -60 minutes.



KIA TASMAN

Catalogue

1. Product Introduction.....	2
1.1 Bill of Material.....	2
1.2 Product Components.....	4
2. Installation.....	5
2.1 Preparation.....	5
2.2 Assembly.....	9
2.3 Assemble the bracket.....	14
2.4 Installation.....	19
2.5 Inspection(Gage M4 orT)	24
3. Product Introduction.....	29
3.1 Manual Lock Introduction.....	29
3.2 Benefits.....	29
3.3 Manual lock operation.....	30
3.4 Function Introduction.....	30
3.5 LED Light.....	31
4. Maintenance.....	32
4.1 Daily Maintenance.....	32
4.2 Common Problem Solution.....	32
5. Helpful Maintenance Hints.....	33

1. Product Introduction

1.1 Bill of Material

M1

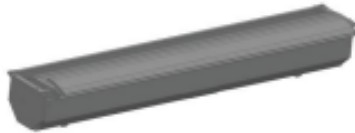

1X

M2



1X

M3



1X

M4



1X

Adjust the accessories M5/M6 according to the actual situation

M5



1X

M6



L1+R1

Parts list (different parts for different models, but same way of installation)

A



6X

B



10X

C



2X

D



2X

E



2X

Foam

F



One-sided vinyl (Eva)1600*30*5

2X

G



One-sided black adhesive1515*30*30

1X

List of bracket accessories

H



L1+R1

I



6X

J



M6*20

6X

K



M6

6X

L



M8*30

6X

M



8.6*16*1.5

12X

N



M8

12X

Maintenance

Sealant

















1X

Silicone oil



1X

Maintenance				
 Sealant 1X		 Silicone oil 1X		
Tool class (to be brought)			Accessory part	
N1  S=5 1X	N2  S=5 1X	N3  S=8/10 1X	 BTW 2X	
Assistive tools (to be brought)				
		 Φ20mm		 Φ28mm
				

1.2 Product Components

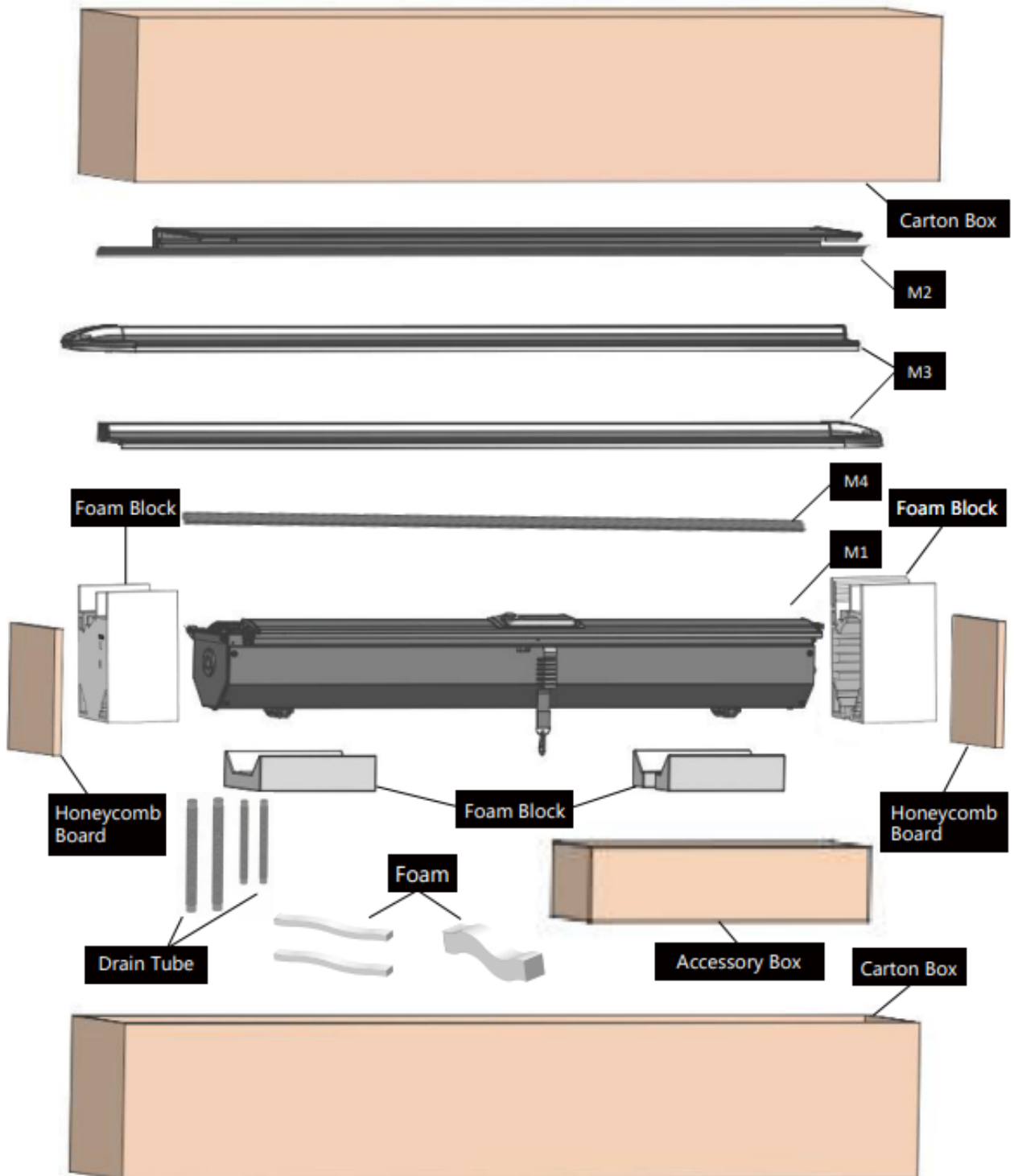

2. Installation

2.1 Preparation

1

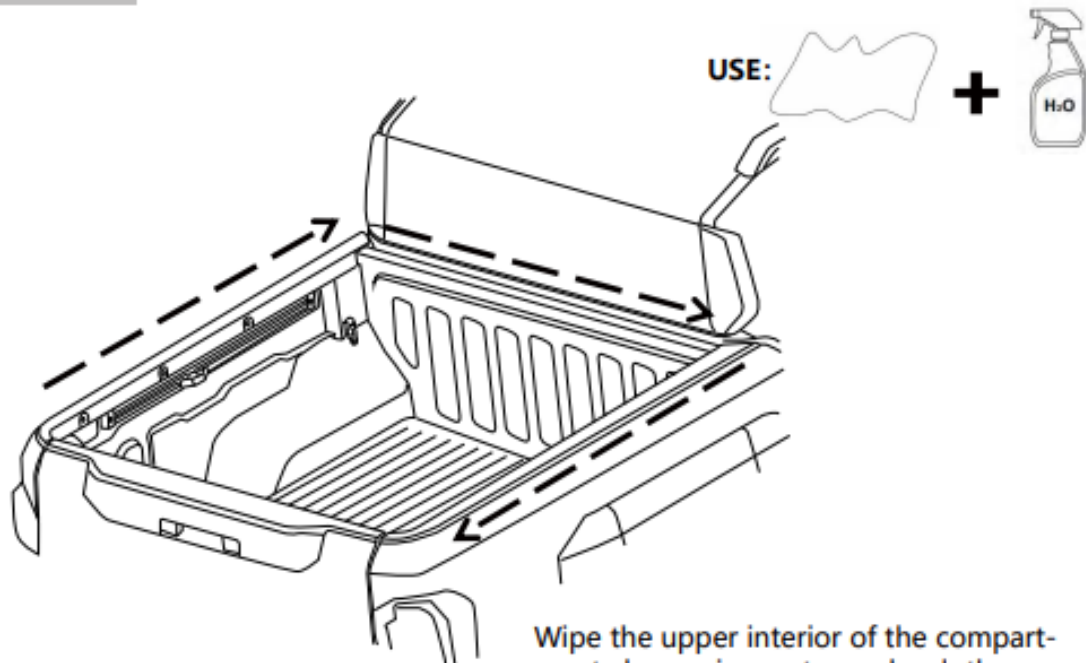

For applying foam to the compartment, there are two options. Choose according to the specific situation.

2

Option1:

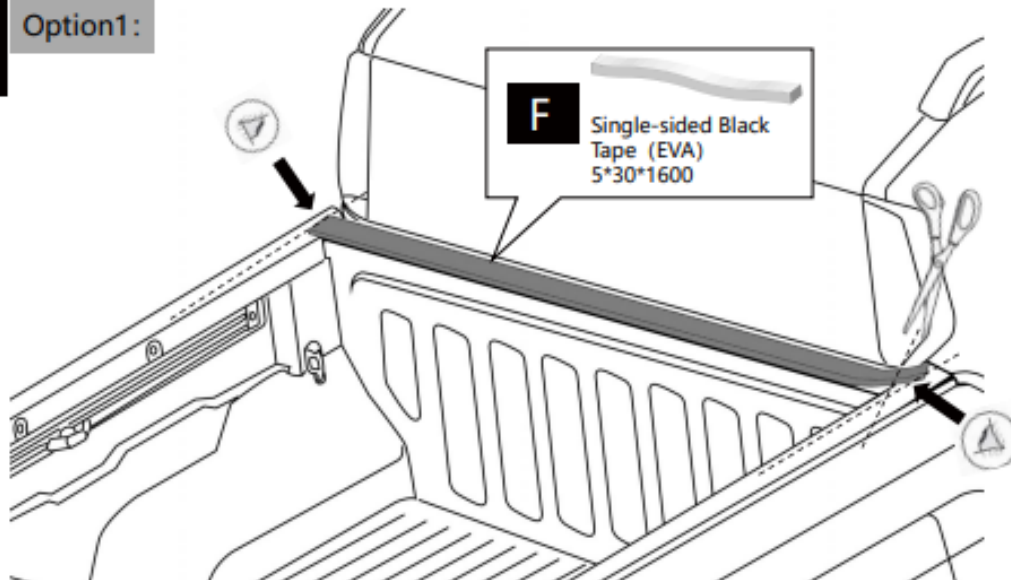

If the compartment is equipped with a bed liner, apply the (F) thin foam to the upper front edge. Then, trim off any excess with scissors, ensuring the foam is aligned with both sides of the compartment.

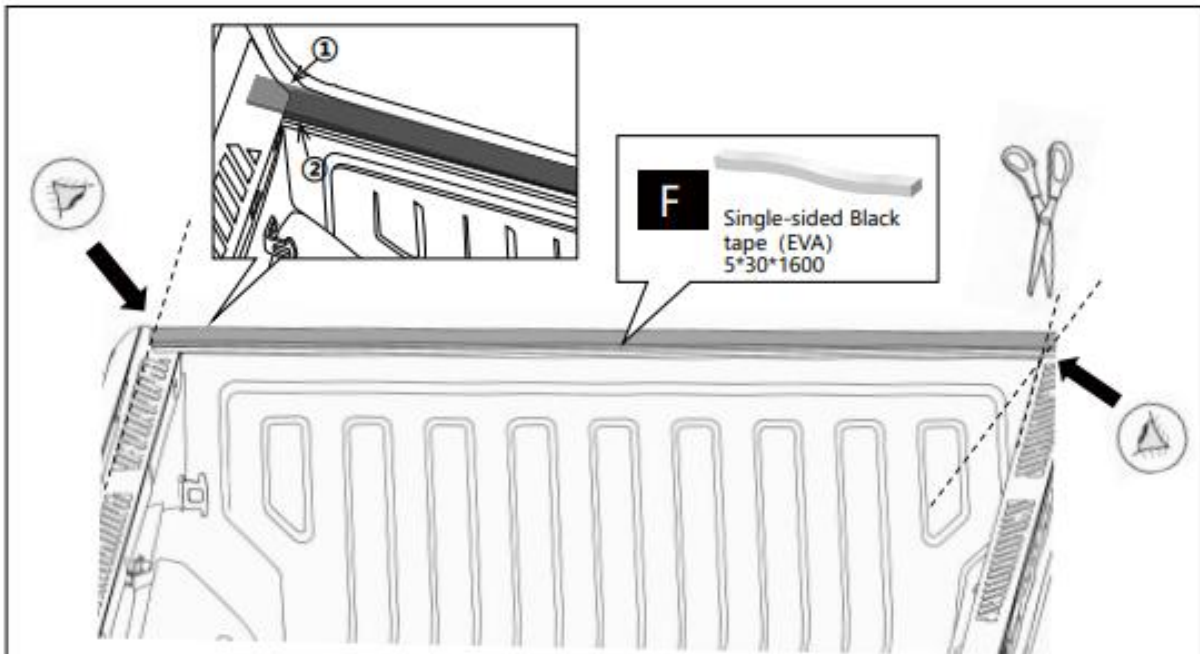

Then, apply an additional strip of (F) thin foam directly over the previous one. Trim off any excess with scissors, ensuring the two strips are as flush as possible.

3

Option 2:

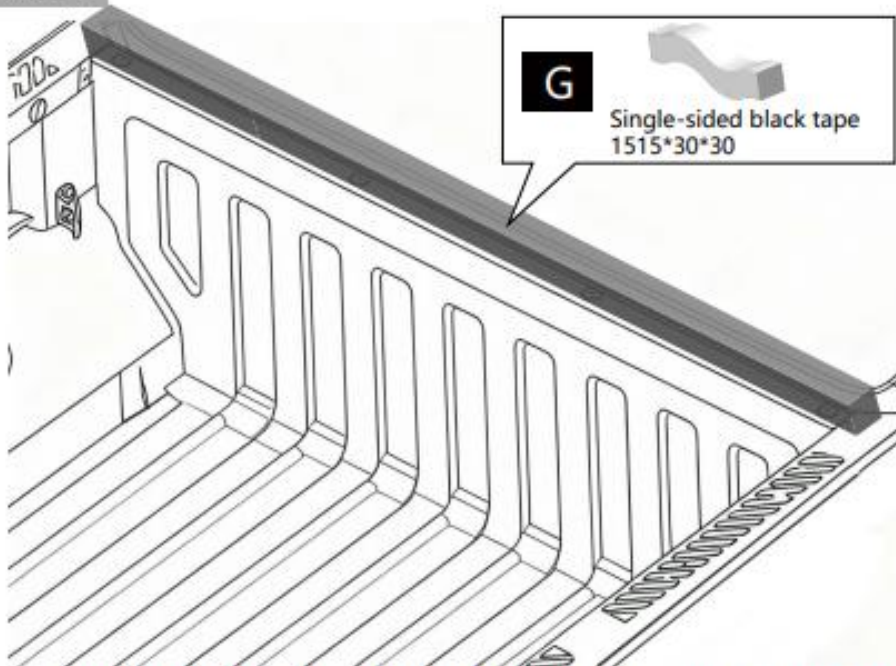

If the compartment is not equipped with a bed liner, apply the (G) thick foam to the upper front edge. Ensure the foam is aligned with both sides of the compartment.

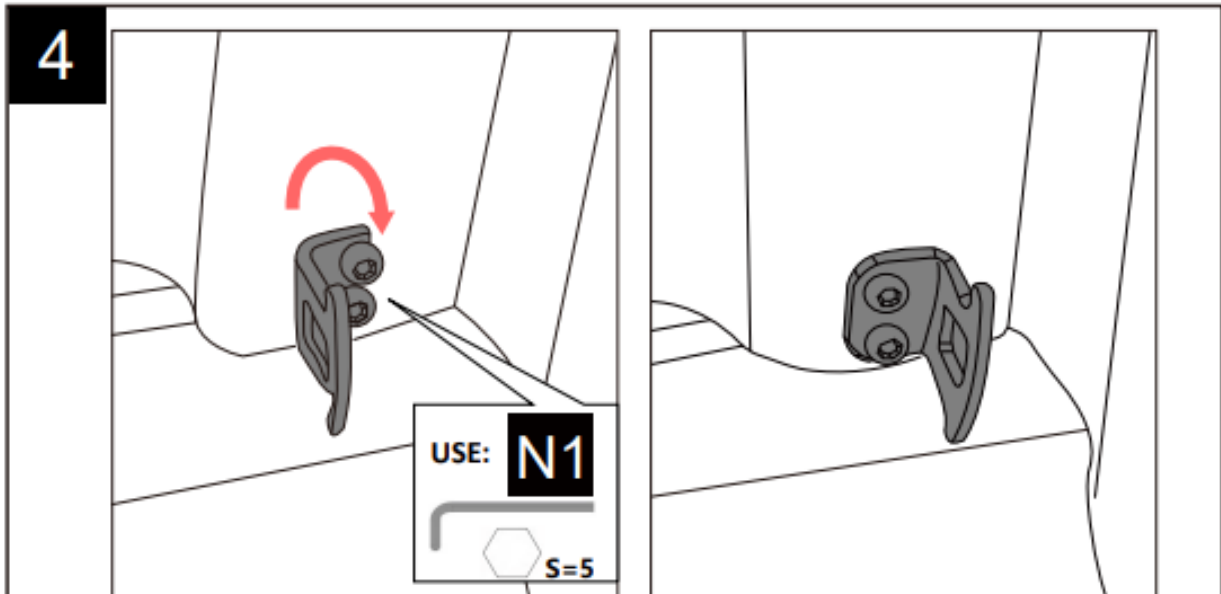

To prevent the original front hook from scraping against the bottom of the roller shutter box, it is necessary to remove it with a wrench and reinstall it in the flipped orientation (see illustration). The same modification applies to the hook on the right side.

Important: If the original hook is not flipped during installation, it will result in direct contact and scraping against the bottom of the roller shutter box.

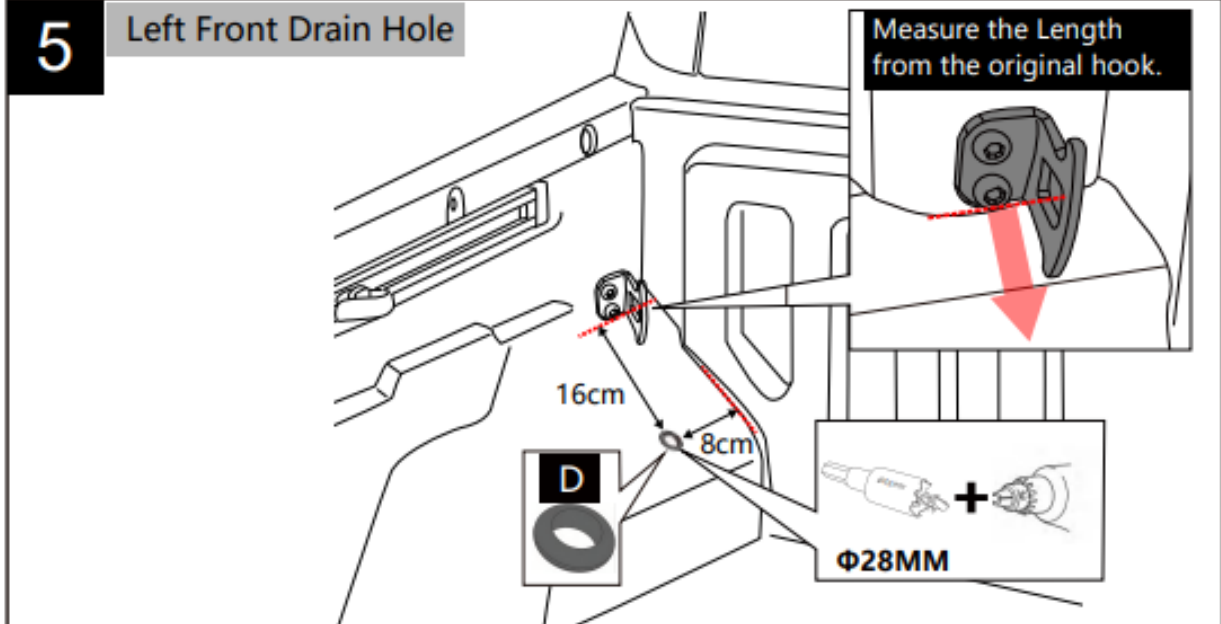

1. On the left side of the compartment, using the original hook as a datum, mark a drilling point measuring 16cm long by 8cm wide.
2. Using a $\Phi 28$ mm drill bit with a power drill, drill a vertical hole.
3. Deburr the hole, install the rubber grommet to secure it, and exercise caution around the fuel line during the operation.

Caution: When drilling the left drain pipe, be mindful of the fuel line.

6

Right Front Drain Hole

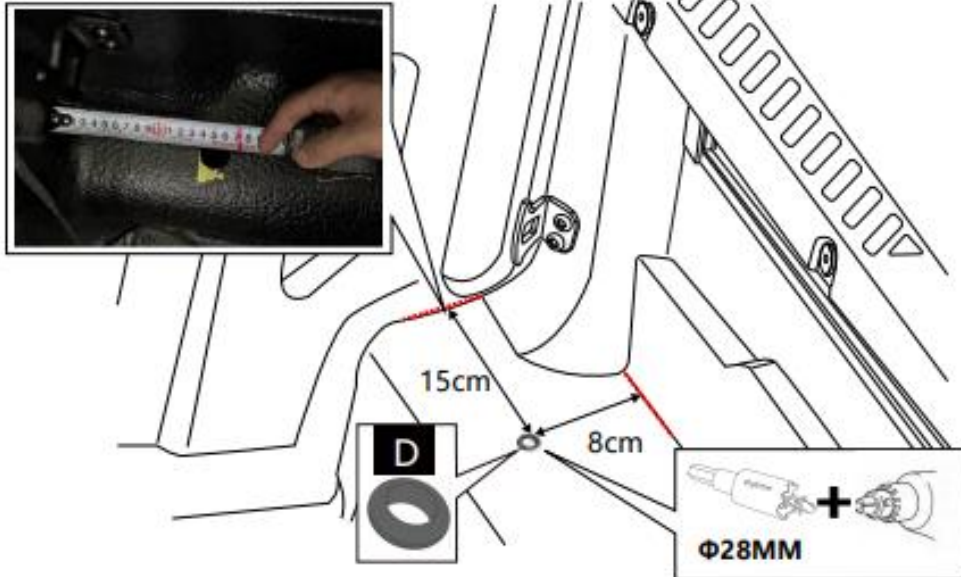

1. On the right side of the compartment, using the vehicle's fender liner as the datum (as shown), measure and mark a drilling point at 15cm long by 8cm wide.
2. Using a $\Phi 28$ mm drill bit with a power drill, drill a vertical hole.
3. Deburr the hole and install the rubber grommet to secure it. Avoid damaging the bushing during operation.
4. Important: Before installing the drain pipe, the power cable must be routed through it.

Note



When drilling the right drain hole, the wheel liner must be removed first to prevent damage. The liner is held in place by simple clips (as shown) and can be directly detached. Remember to reinstall it after the operation.

Caution: The wheel liner must be removed for this operation, or risk damaging it during drilling.



7 Rear Drain Hole

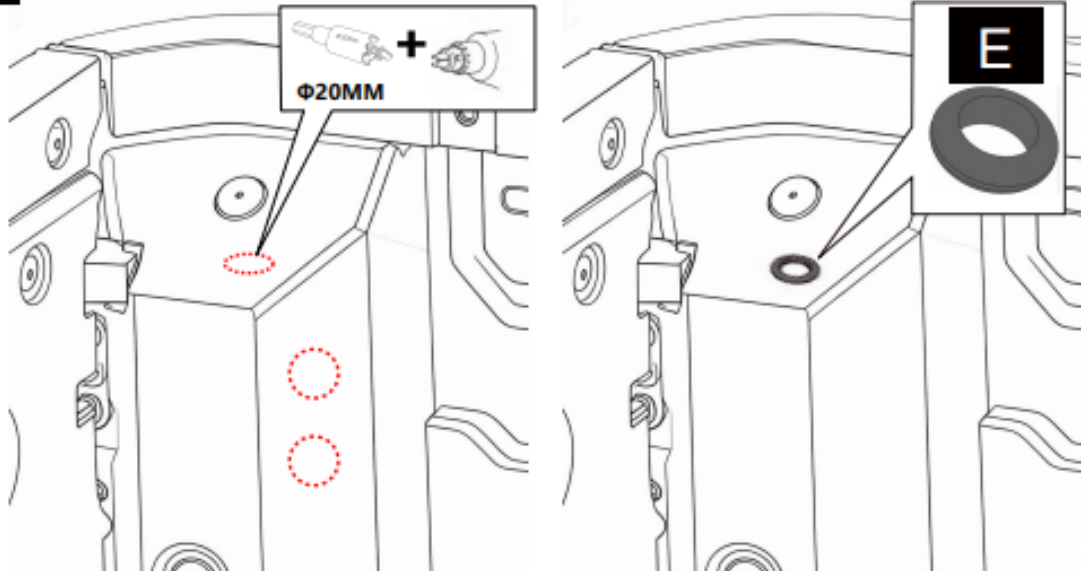

Use a $\Phi 20\text{mm}$ hole opener with a hand drill to punch holes in the carriage. (as shown, three circles are used to punch holes. Choose one of the three holes.) After the holes are drilled, a burr cape needs to be removed. Then (E) rubber rings are installed to prevent water leakage, same on the right.

2.2 Assembly

8

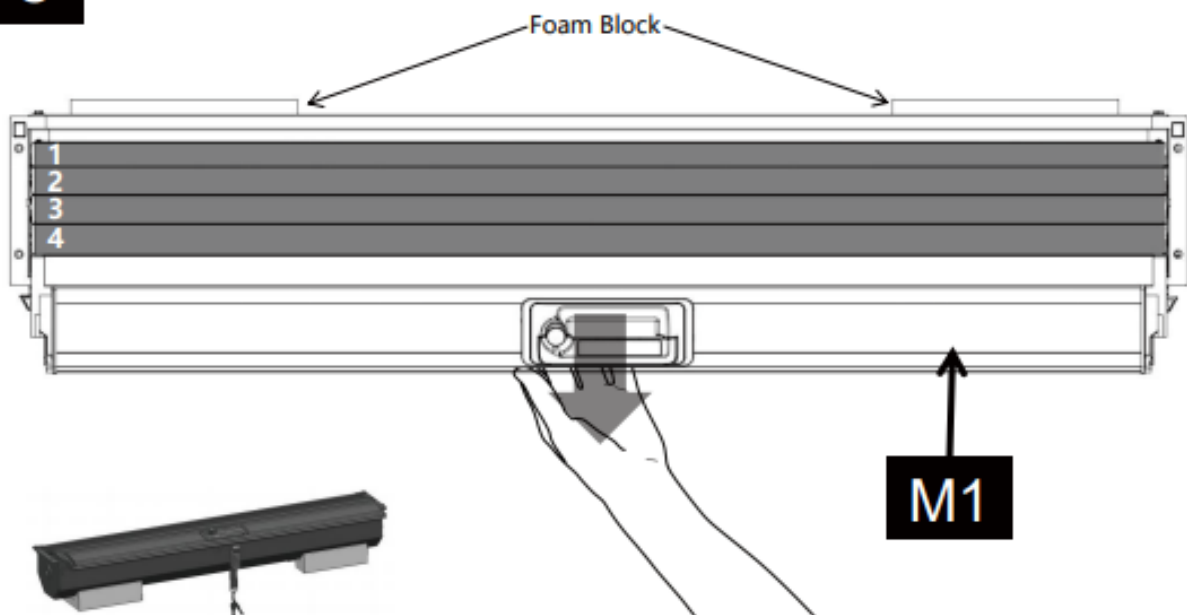

Tips: Put the canister on the foam block for assembly to avoid scratch.

Pull out 4 aluminum bars from the canister.

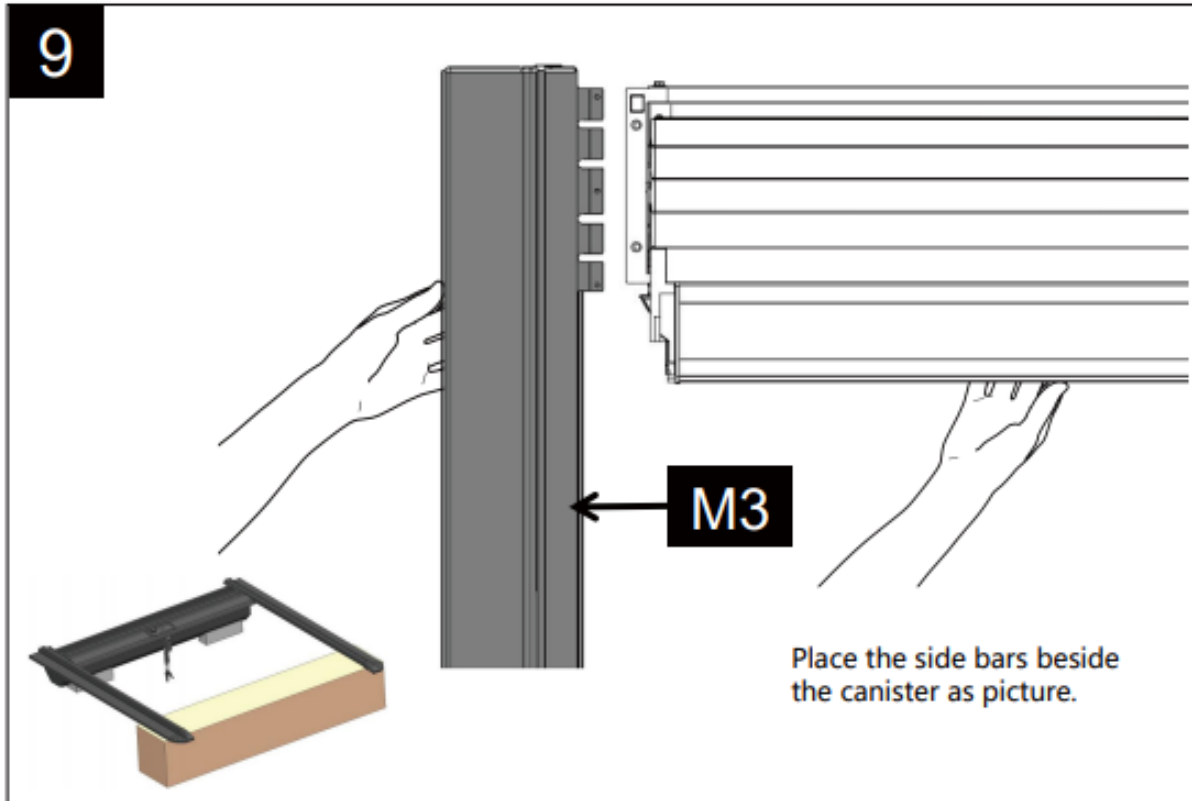

Tips: Place the side bars on carton box to avoid scratch.

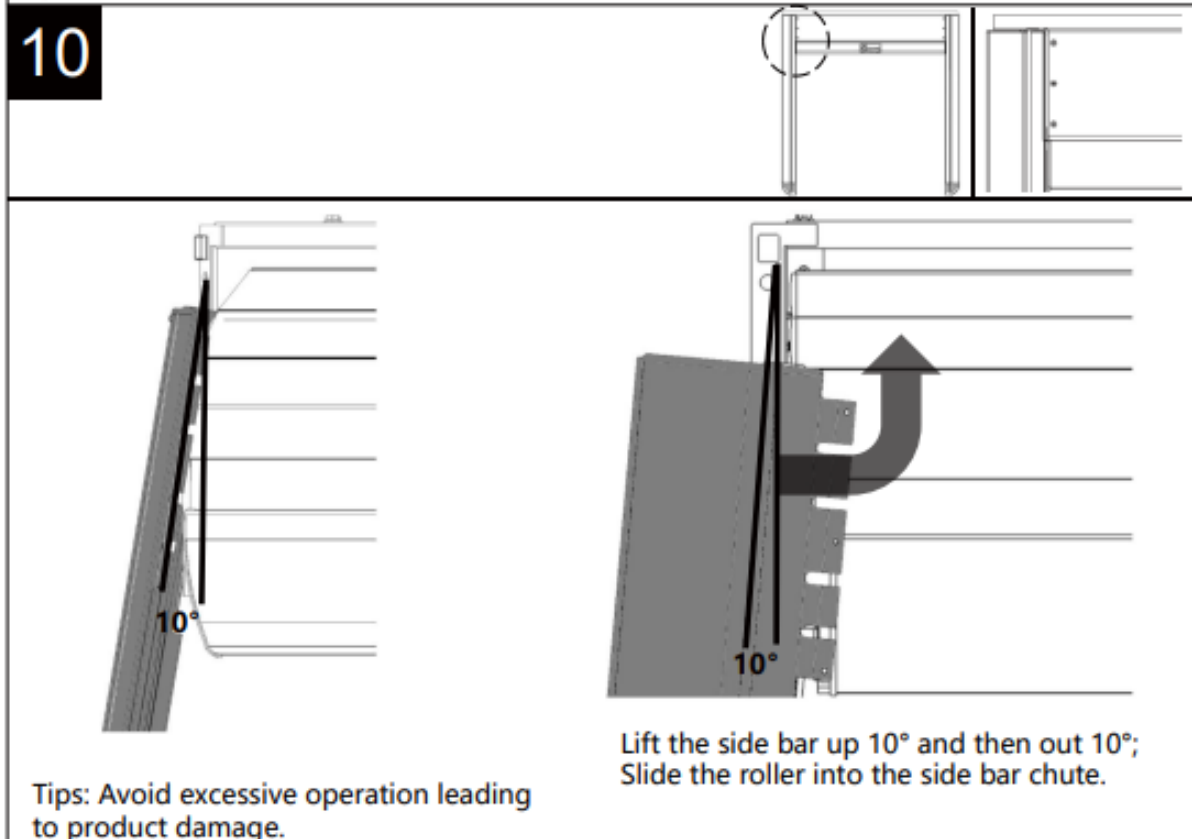

11

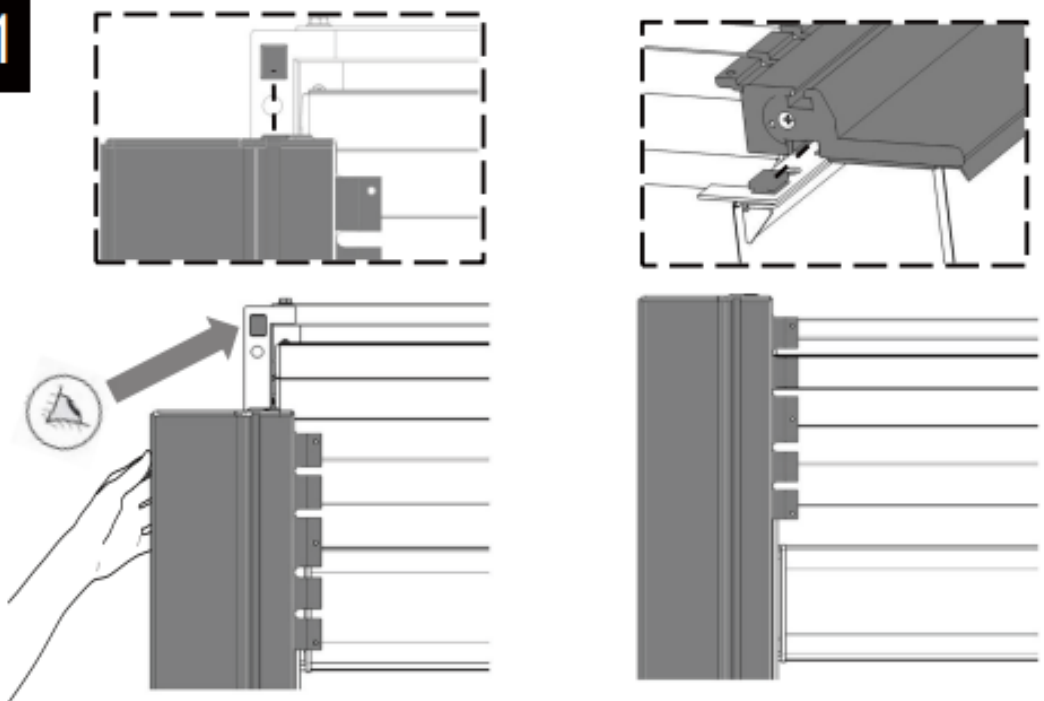

Tips: Avoid excessive operation leading to product damage.

Align the side bar groove with the raised T-block and push the side bar until it can not move forward.

12

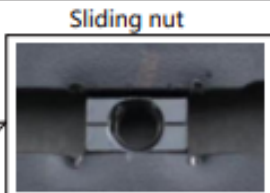
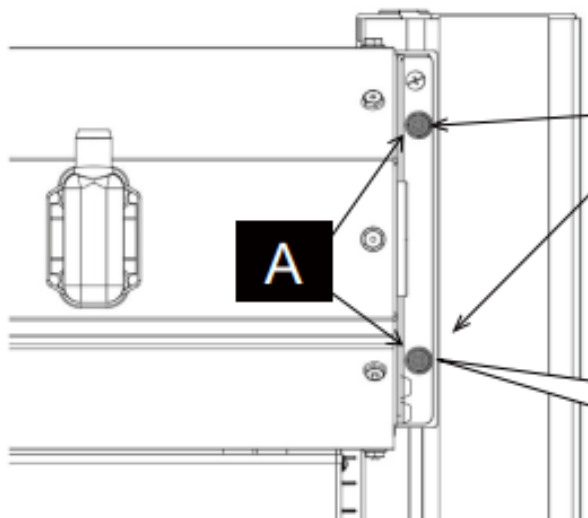
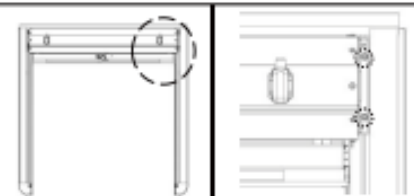

Sliding nut

Note: After the first screw is half-way in, start installing the second screw. Fully tightening the first screw may make installing the second screw difficult.

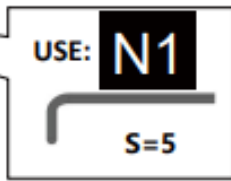

TIPS: This operation need to reverse the canister. If the bolts can not be fixed, please adjust the side rail and the canister hole alignment.

Using a (N1) hexagon wrench, tighten the (A) Bolt.

13

Before fully fixing the side bar, make sure that the roller shutters are in line (distance A = A).

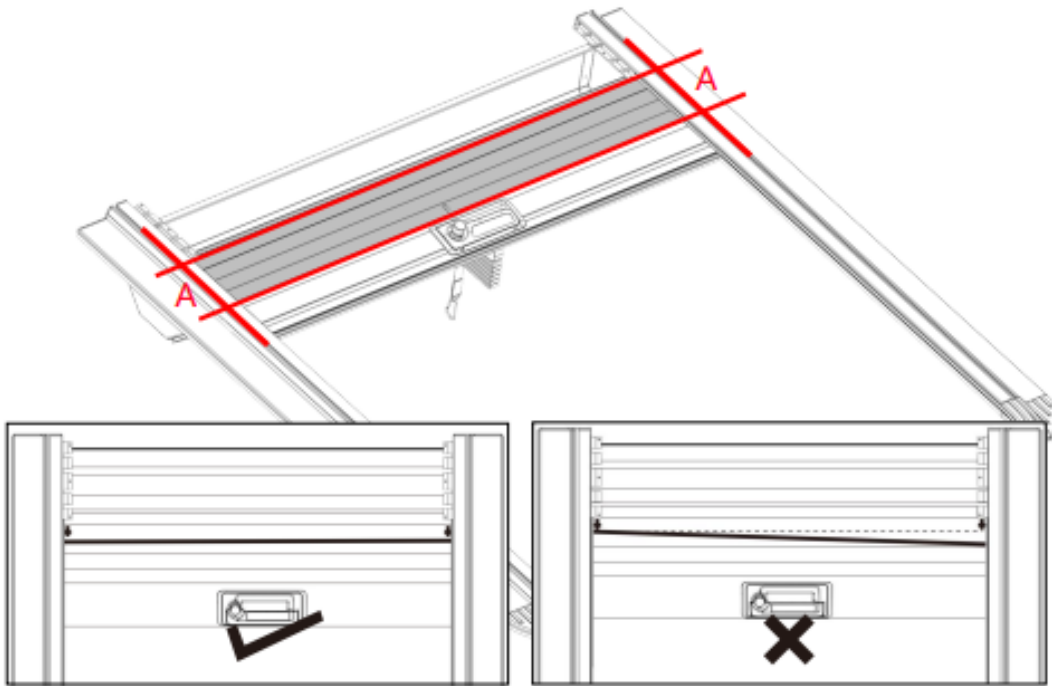

14

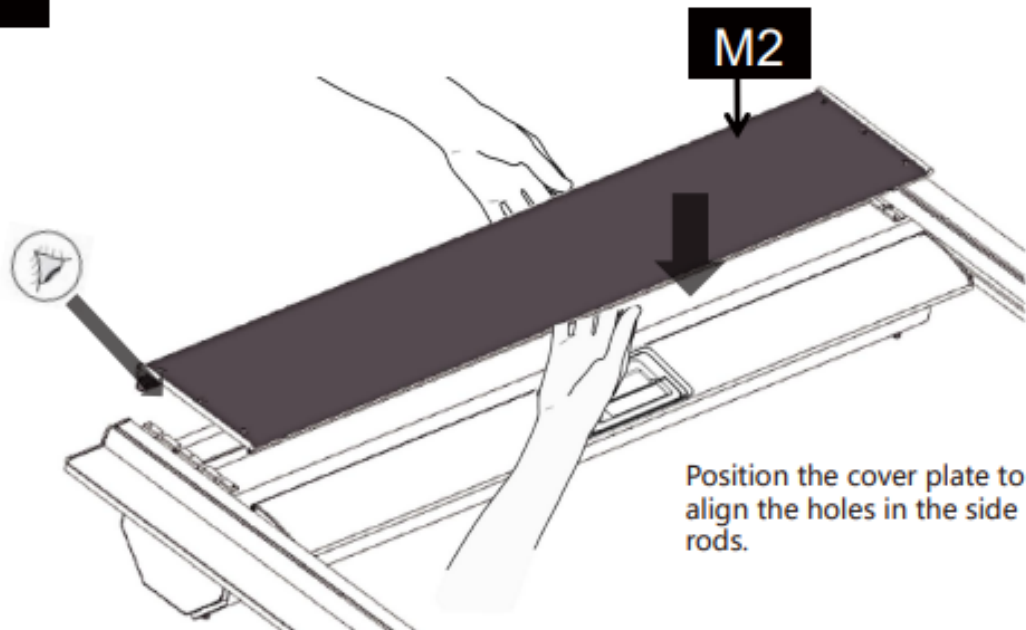

TIPS: The cover needs to be aligned, taking care not to scratch the box.

15

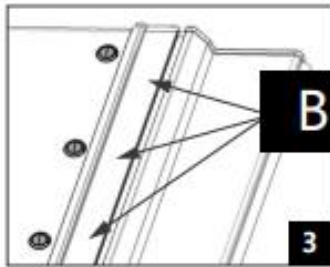
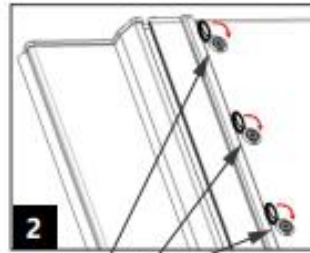
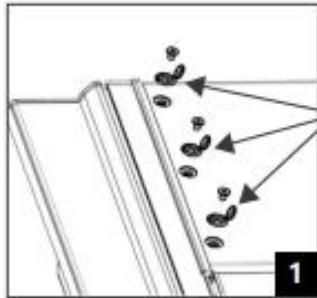
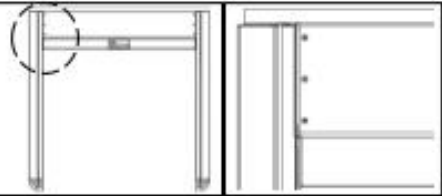

The holes on the cover plate are arranged with (B) base and bolts in turn. Tighten the bolts using a (N2) cross wrench. Finally close the (B) lid.

TIPS: Pre-tighten the left side bolts first, then tighten them all at once after installing the right side bolts.

16

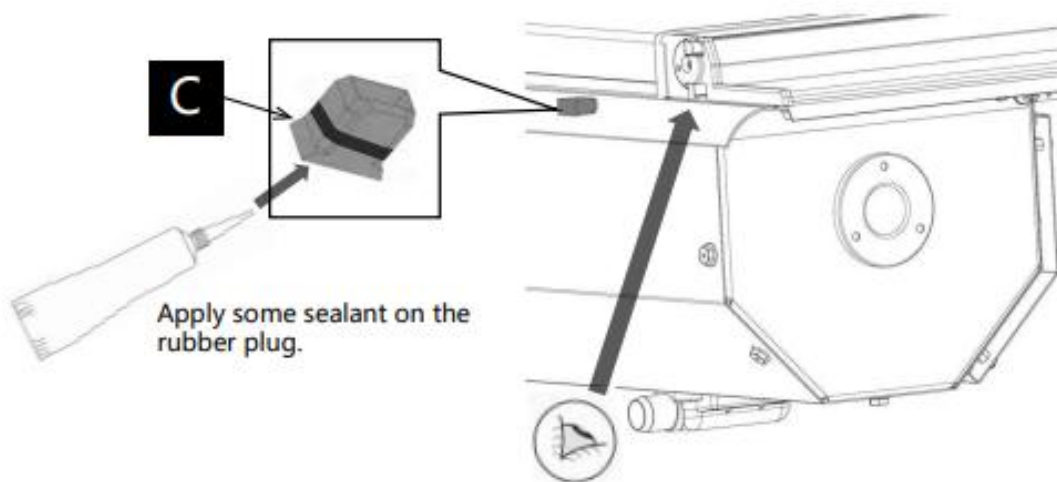
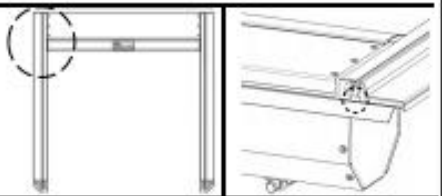

Tips: (C) the narrow part of the stopper should face down

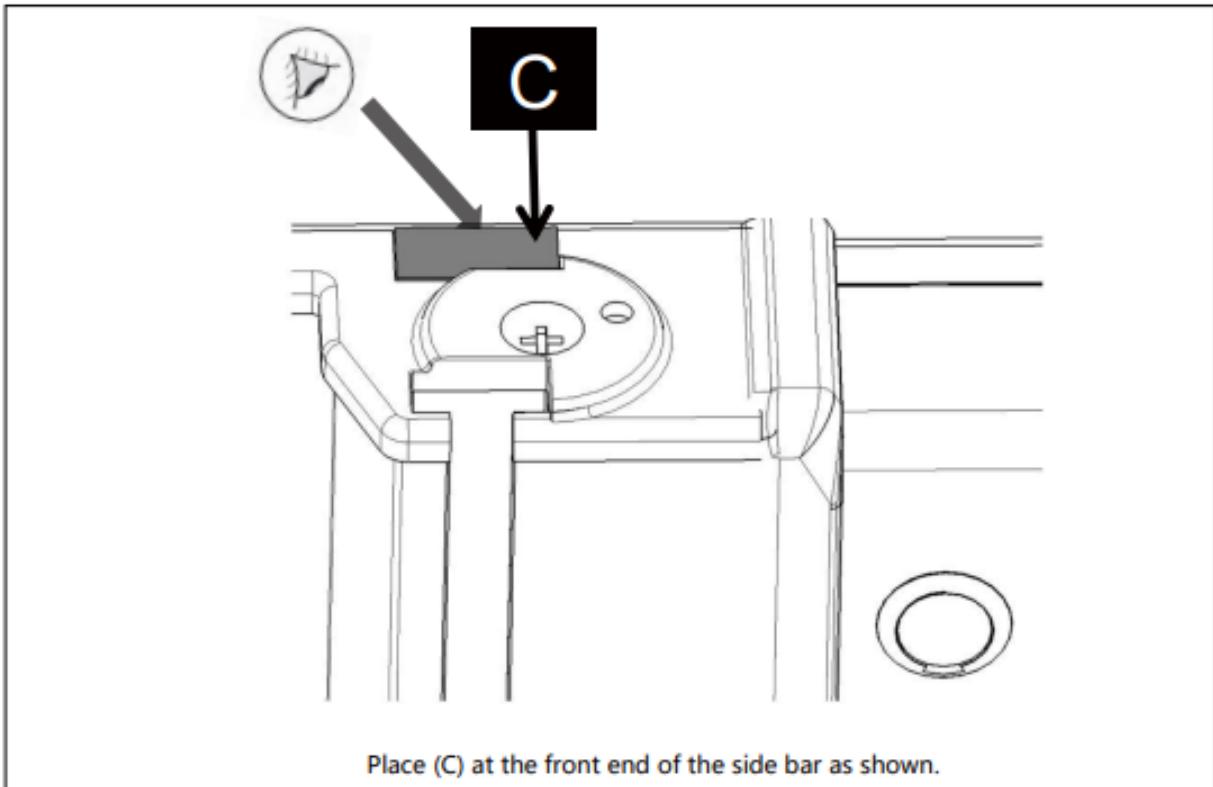

17

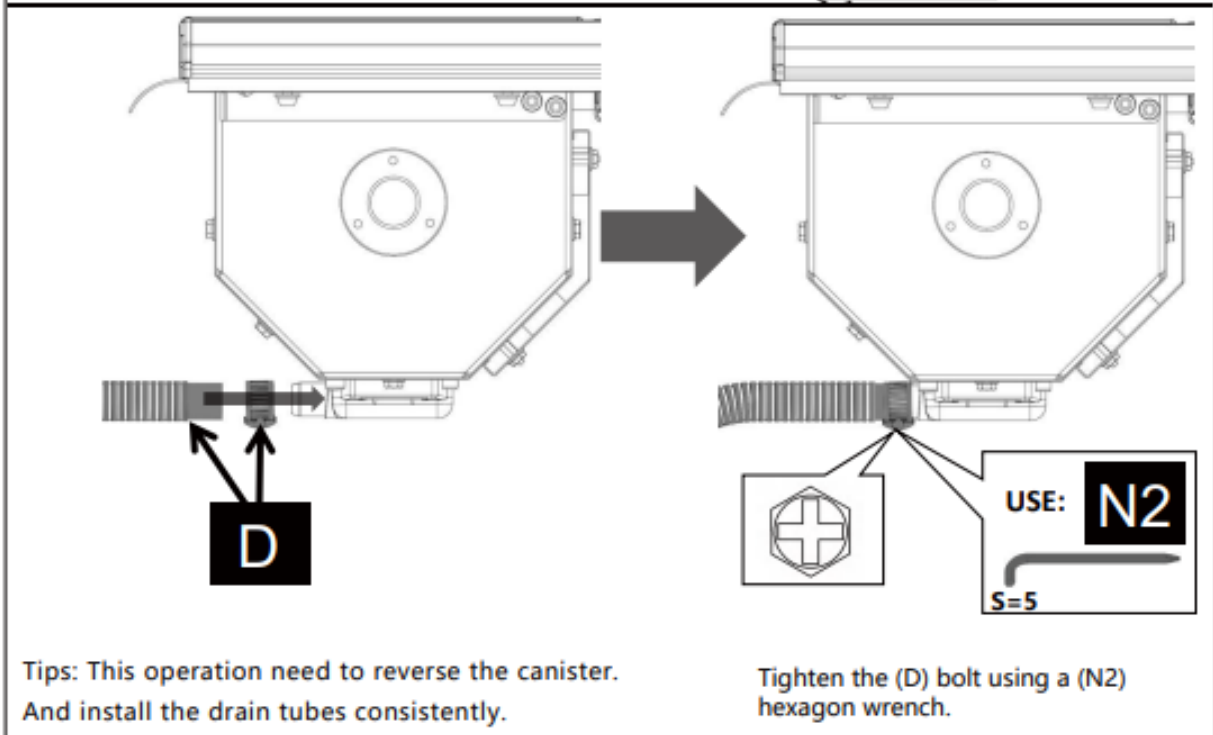

18

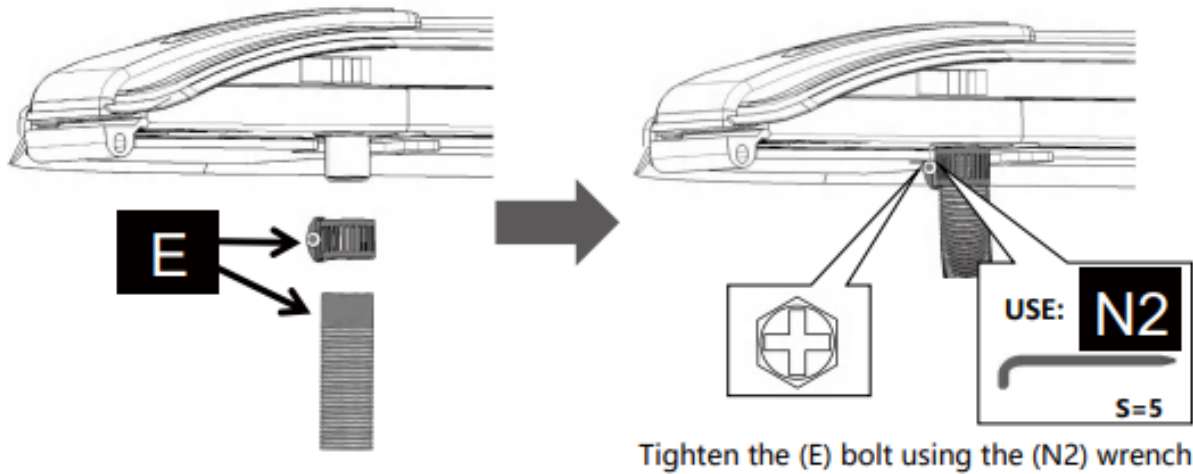

Tips: Install the drain tubes consistently.

2.3 Assemble the bracket

19

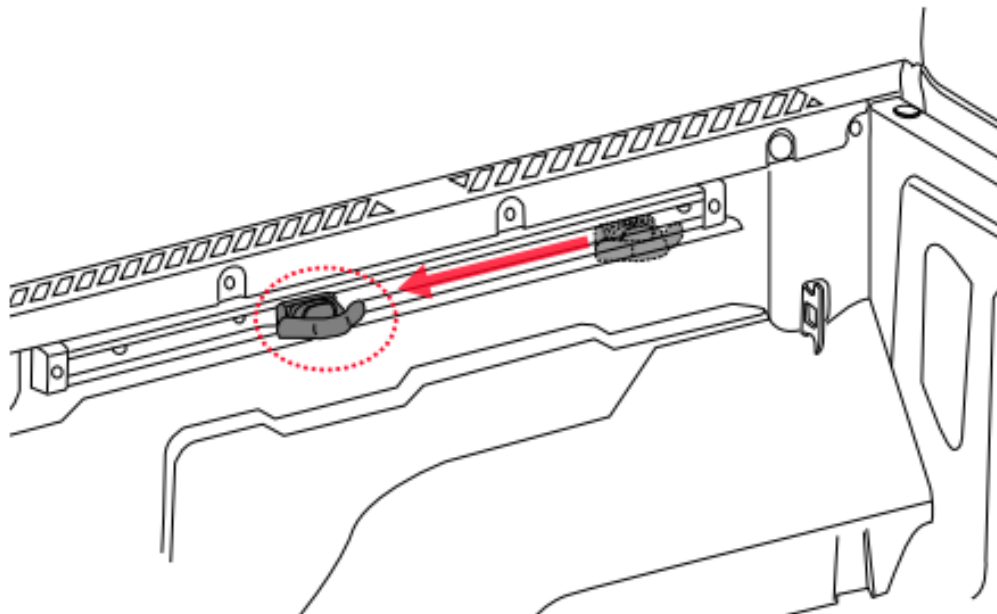

Prior to loading the roller shutter onto the vehicle, the handles of the original left and right sliding rails must be moved backward. Otherwise, once the roller shutter is in place, the case will not seat properly as it will be obstructed by these handles.

20 Install the front bracket (as shown). Repeat the same for the right side.

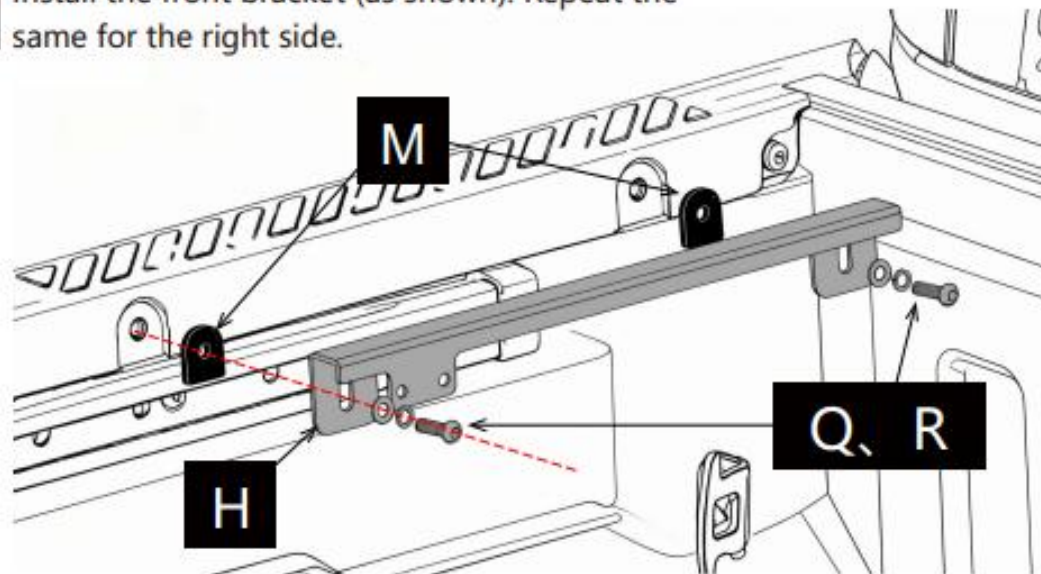

1. To prevent bracket tilt, install two (M) washers into the original vehicle screw holes to ensure a level and stable base.
2. Then, sequentially pass a (Q) M8 screw, a spring washer, and an (R) washer through the (H) front bracket, the shim, and into the original vehicle screw hole.
3. Secure both sides of the compartment following this procedure.

21

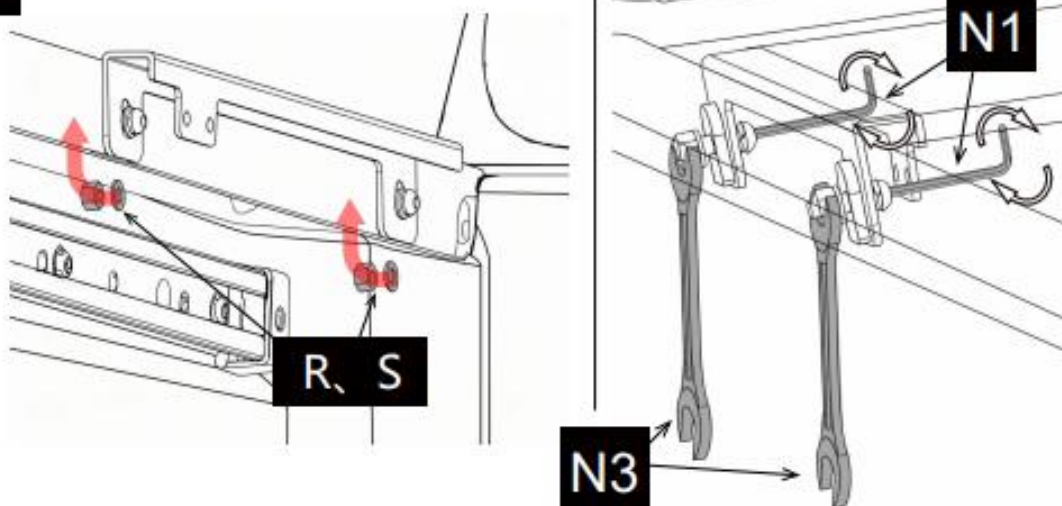

1. Assemble the (R) washer and (S) M8 nut together. From underneath, extend them into the interior side of the compartment and thread the M8 screw into them from below.
2. Use the (N3) wrench to counter-hold the nut inside the compartment.
3. Simultaneously, use the (N1) hex key to tighten the bolt from the outside.
4. Secure the front bracket following this method (as shown). Repeat the same procedure on the right side.

22

Install the secondary bracket onto the front bracket (as shown). Repeat for the right side.

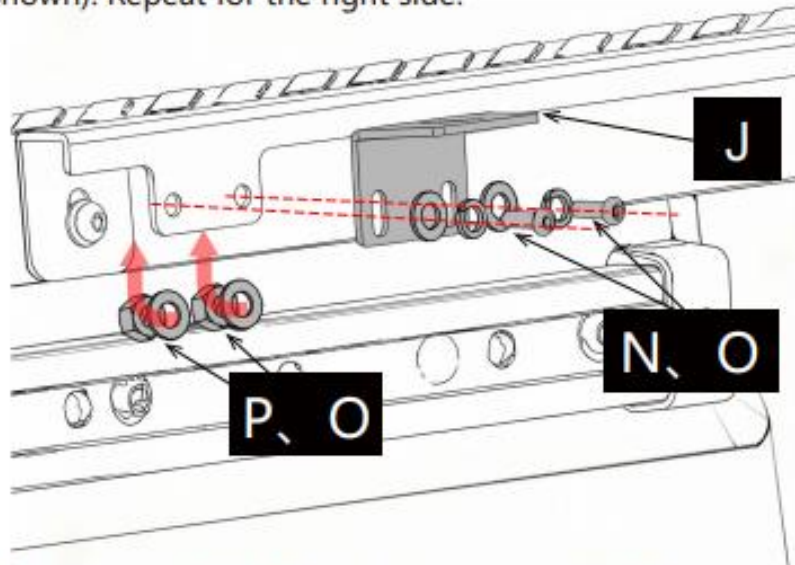

1. Align the small bracket with the screw hole on the front bracket.
2. In sequence, pass the (N) M6 screw, a spring washer, and the (O) washer through the (J) small bracket.
3. Secure them into the screw hole on the front bracket.

23

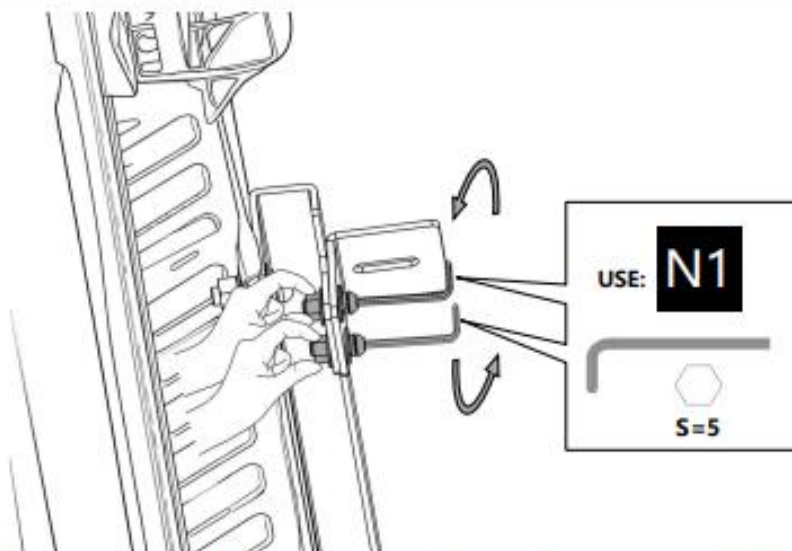

1. Reach into the inner side of the compartment from below and thread the (P) M6 nut combined with the (O) washer onto the M6 screw (as shown).
2. Use the (N1) hex key to tighten the bolt only slightly.
3. Repeat the same procedure on the right side.
4. Critical: Do not fully tighten the screws at this stage to allow for subsequent adjustment of the roller shutter.

Tips: Do not tighten the screw to allow for subsequent adjustments.

24 Install the rear bracket (as shown). Repeat the same for the right side.

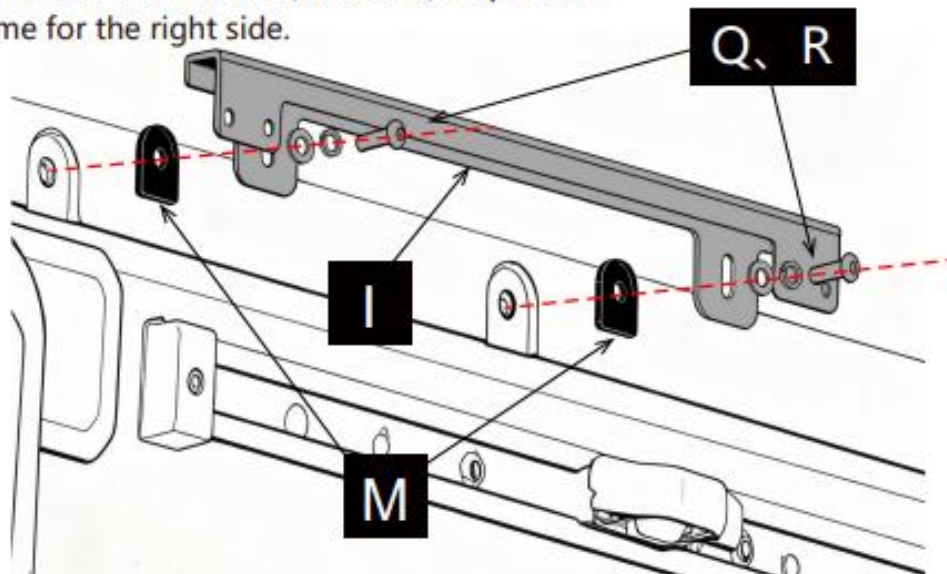

1. To prevent bracket tilt, install two (M) washers into the original vehicle screw holes to ensure a level and stable base.
2. Then, sequentially pass a (Q) screw, a spring washer, and an (R) washer through the (I) rear bracket, the shim, and into the original vehicle screw hole.
3. Secure both sides of the compartment following this procedure.

25

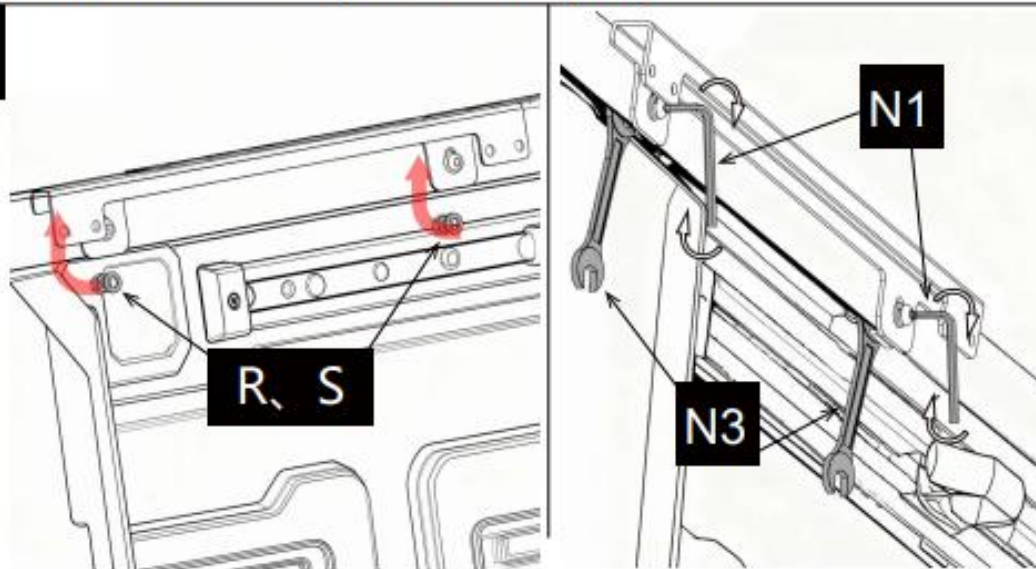

1. Assemble the (R) washer and (S) M8 nut together. From underneath, extend them into the interior side of the compartment and thread the screw upward into them.
2. Use the (N3) wrench to hold the nut securely in place inside the compartment.
3. Simultaneously, use the (N1) hex key to tighten the bolt from the outside.
4. Tighten the rear bracket using this method (as shown). Repeat the same procedure on the right side.

- 26** Install one secondary bracket to each rear bracket (as shown).
Repeat the same for the right side.

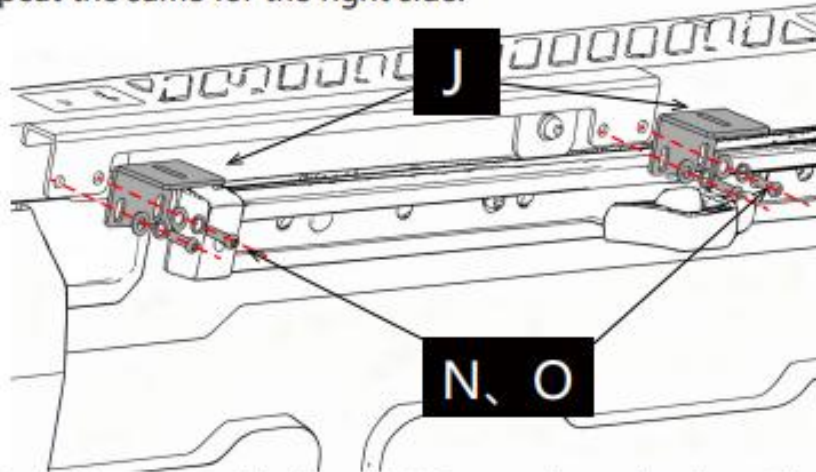

Align both small brackets with the screw holes on the rear brackets. Then, for each one, sequentially pass an (N) M6 screw, a spring washer, and an (O) washer through the (J) small bracket and into the screw hole to secure it

27

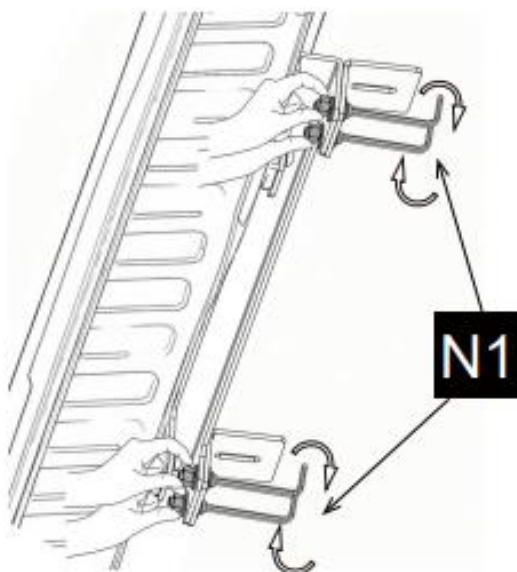
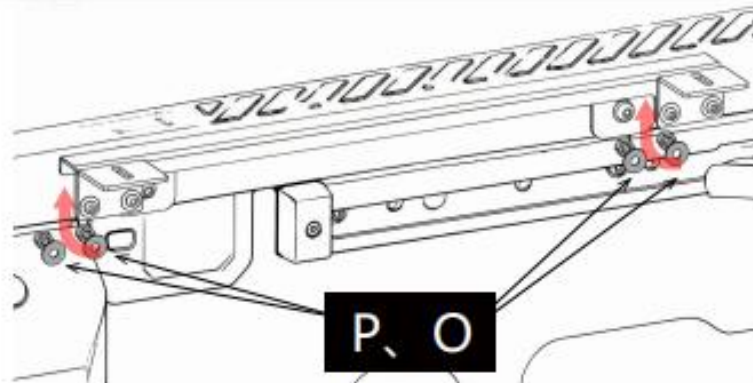

1. Reach into the inner side of the compartment from below and thread the (P) M6 nut combined with the (O) washer onto the M6 screw (as shown).
2. Use the (N1) hex key to tighten the bolt only slightly.
3. Repeat the same procedure on the right side.
4. Important: Do not fully tighten the screws at this stage to allow for subsequent adjustment of the roller shutter.

Tips: Do not tighten the screw to allow for subsequent adjustments.

2.4 Installation

28

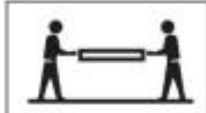

Lift the product
onto the truck
bed.

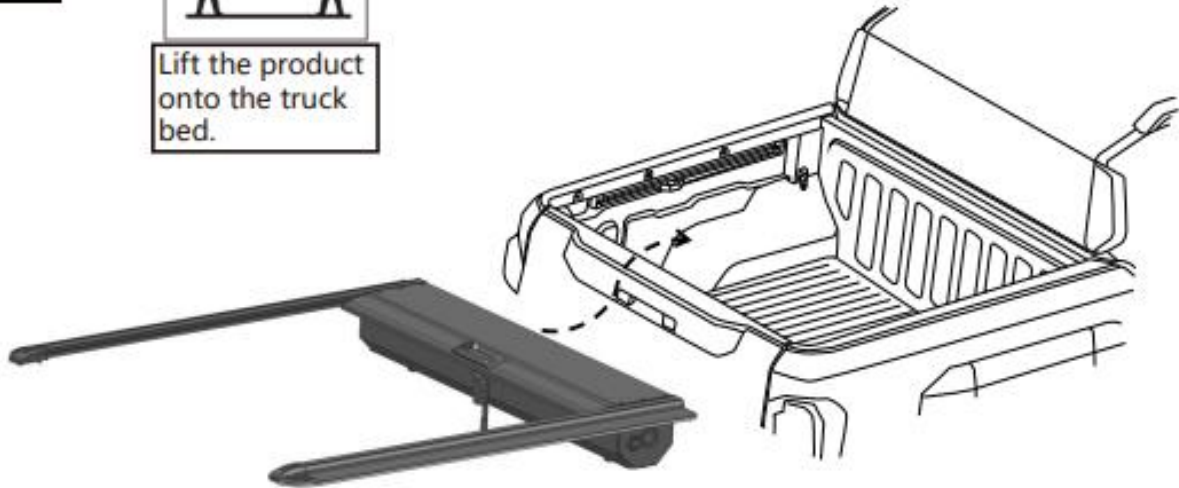

Tips: Installation requires 2 people to lift the product onto the truck bed for safety of personnel and product. Please pay attention to avoid any scratch on vehicle and product surface.

29

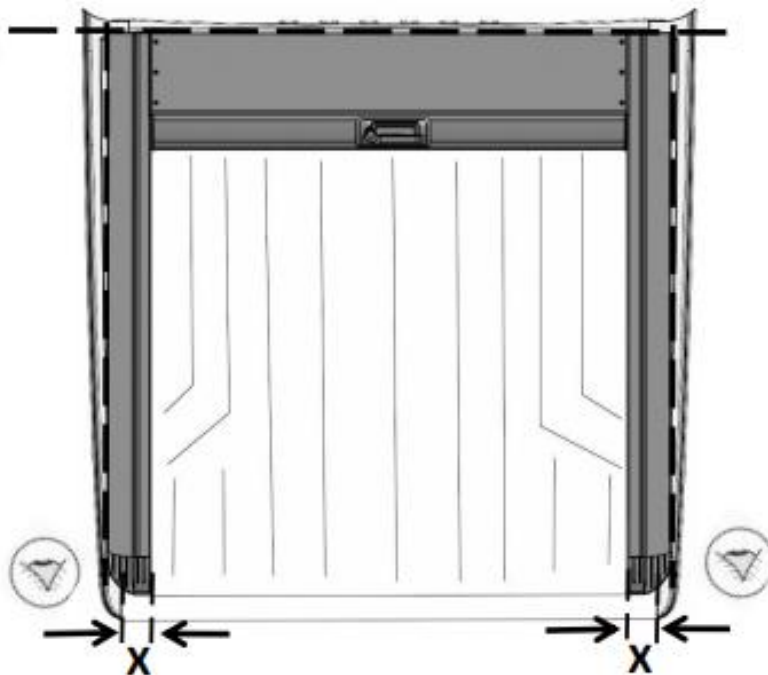

Tips: If the end cap is not covered on the tailgate for 1-2cm, you need to move the cover backward slightly.

Push the roller to the end; Keep the same distance on both sides.

30

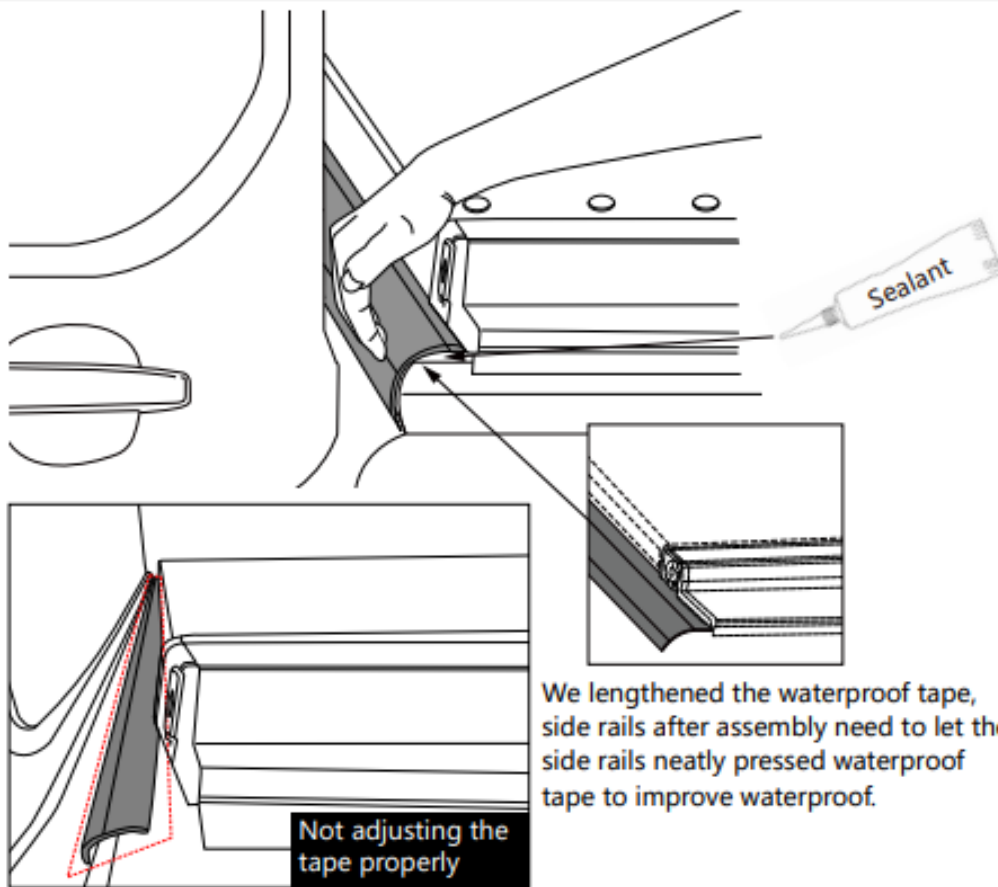

31

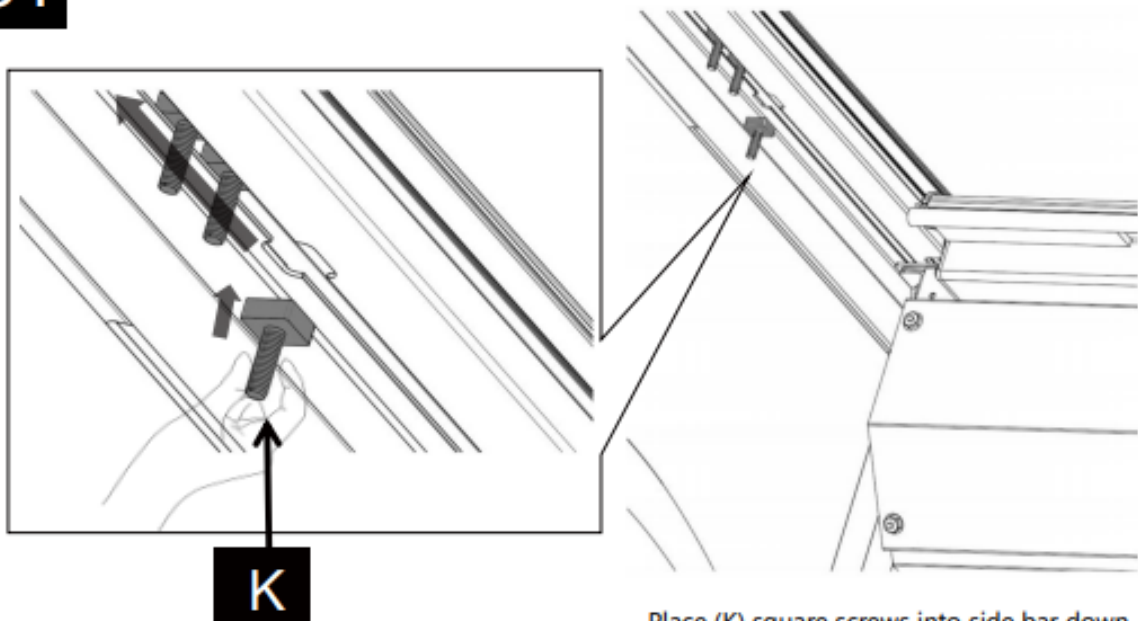

32

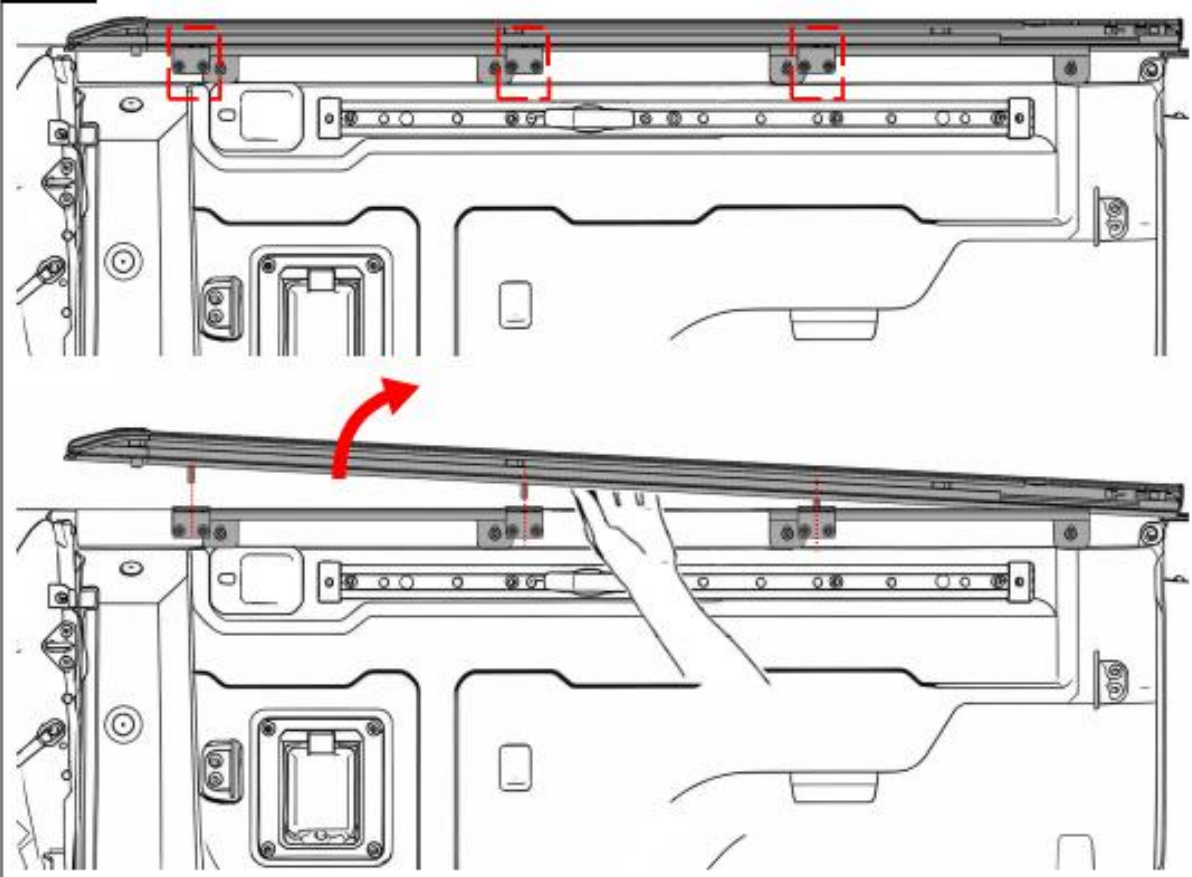

After slightly lifting the side rail,
insert the (K) square-head screw into
the hole of the bracket.

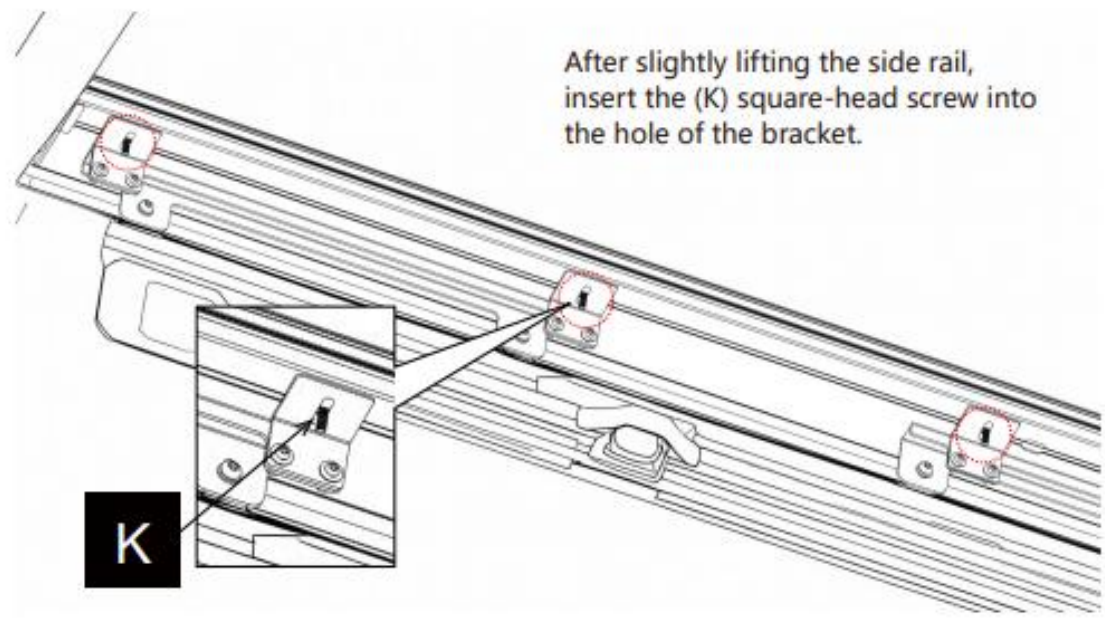

K

33

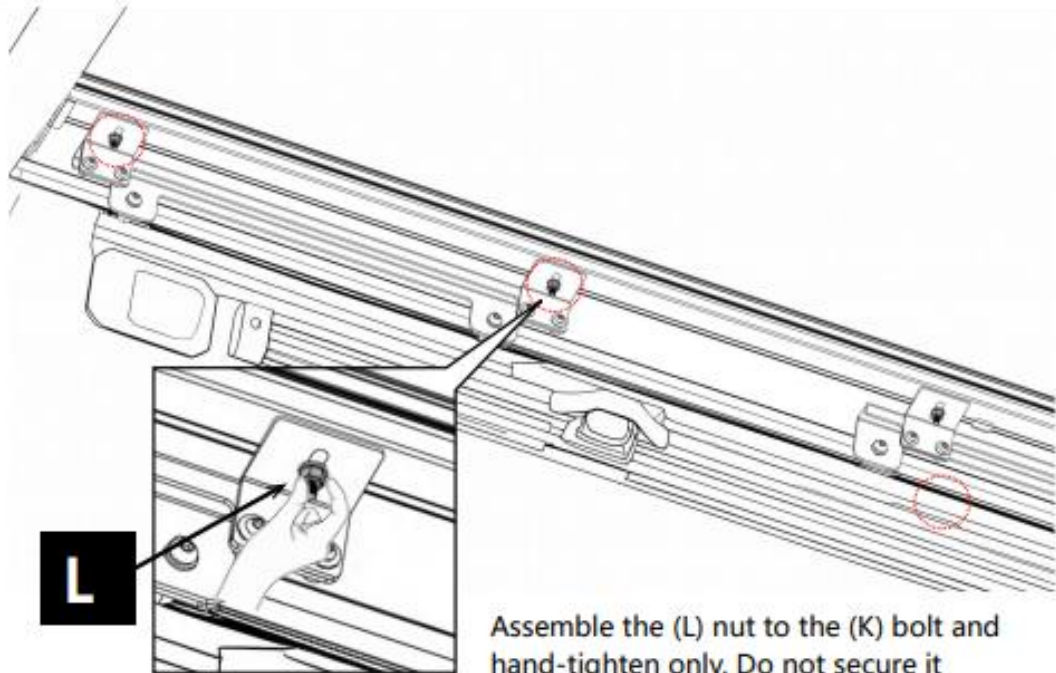

Assemble the (L) nut to the (K) bolt and hand-tighten only. Do not secure it firmly.

TIPS: The screw only needs to be snug enough to hold the side rail while still allowing for its adjustment.

34

Insert the left front drain pipe into the canister.

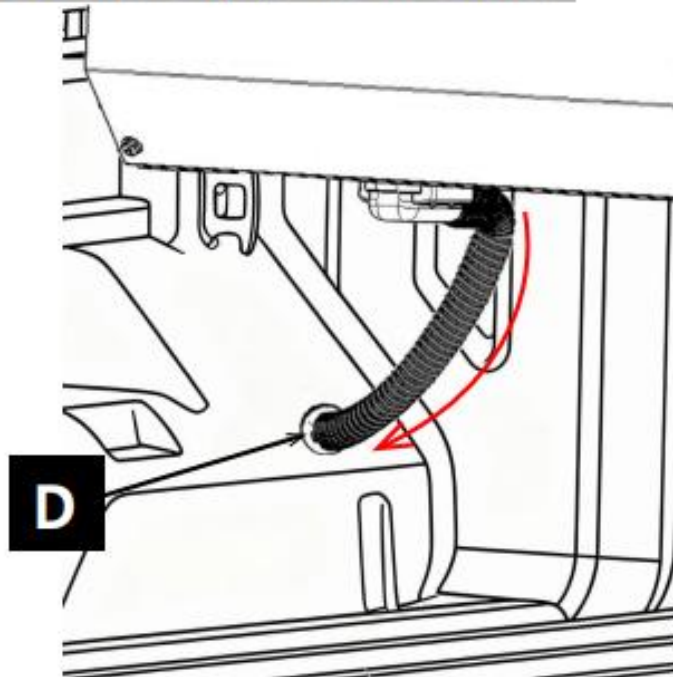

Route the left front drain pipe of the case through the rubber grommet to the outside of the compartment, as shown.

35

Insert the left front drain pipe into the canister.

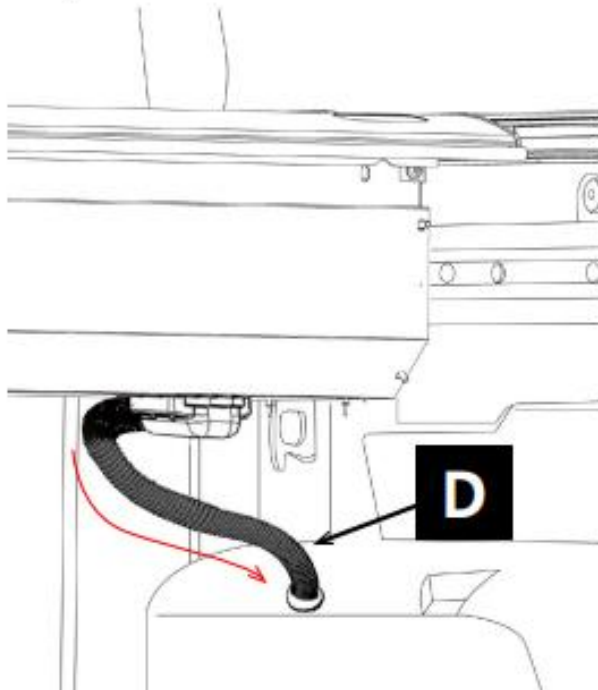

Route the right front drain pipe of the case through the rubber grommet to the outside of the compartment, as shown.

36

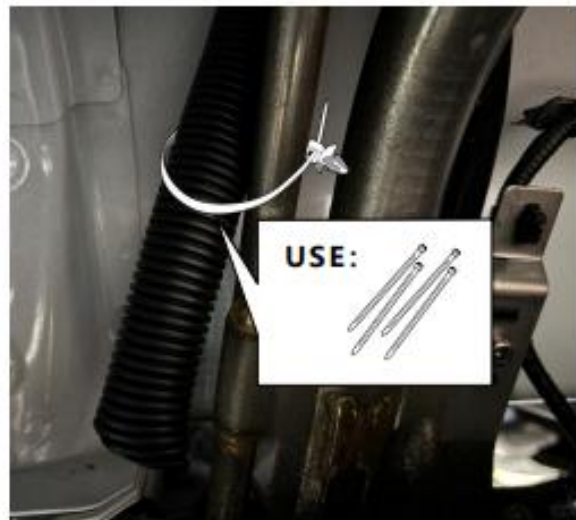

Drain pipe is longer, inconvenient drainage, so must cut short drain pipe, and need to drain pipe with cable fixed on the frame.

37

Insert the rear drain pipe into the side bar.

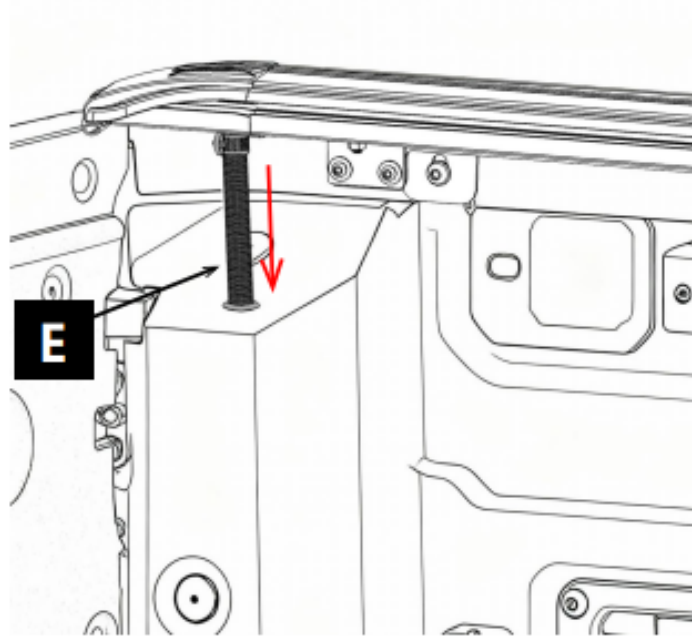

Route the rear drain pipe of the side rail through the rubber grommet to the outside of the compartment, as shown

2.5 Inspection(Gage M4 orT)

38

Option 1: Gage M4

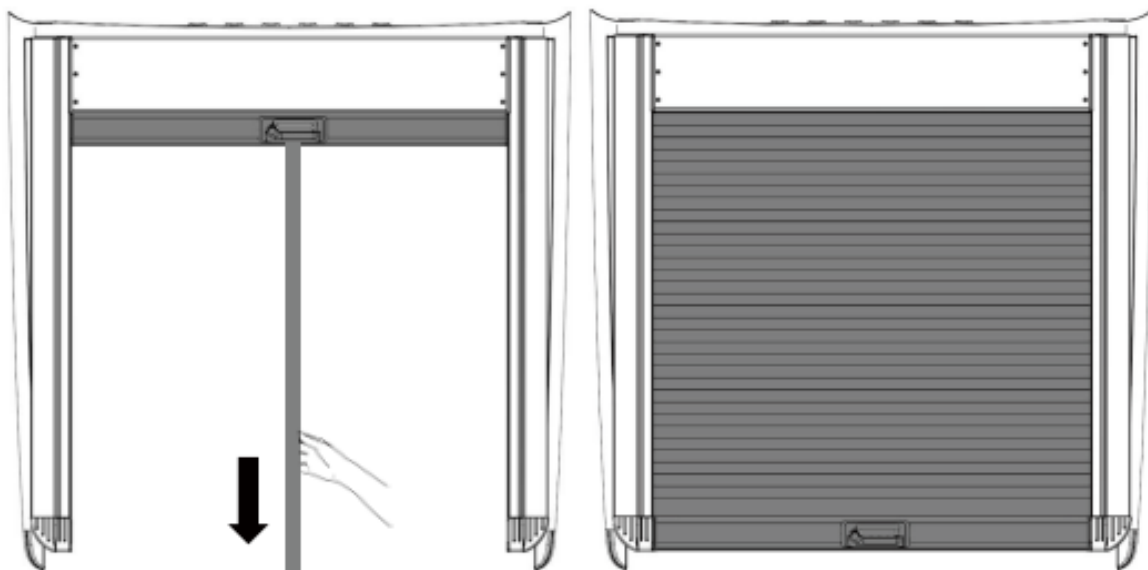

Pull the rope to the end to close the cover.

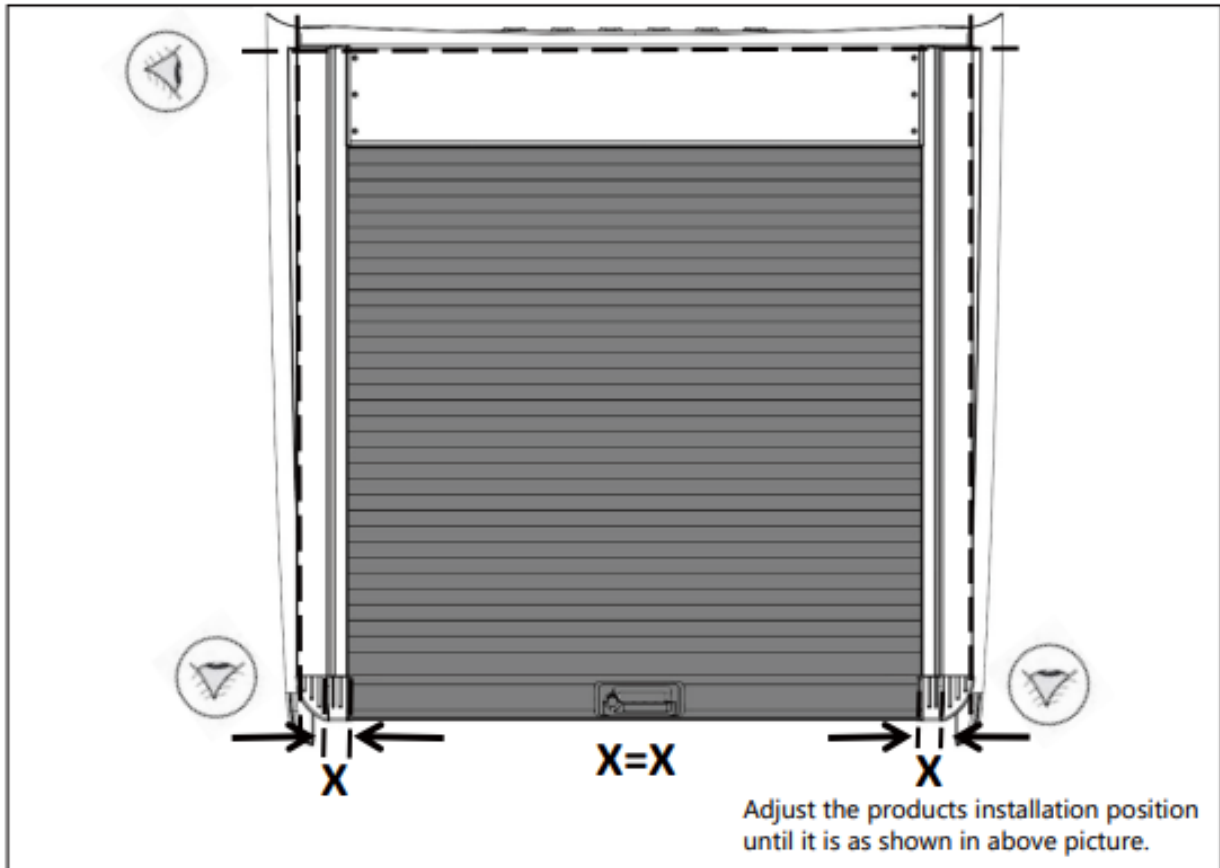

39

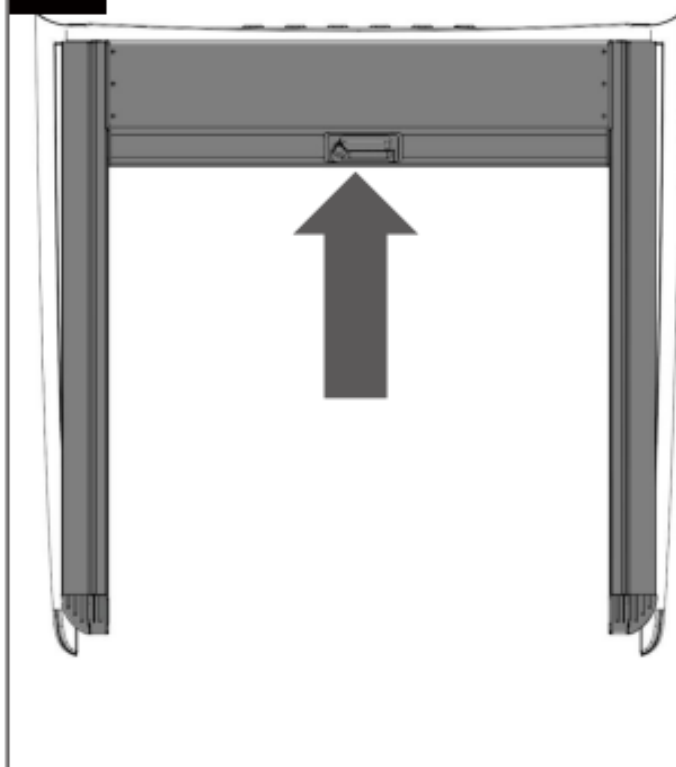

Unlock method1:

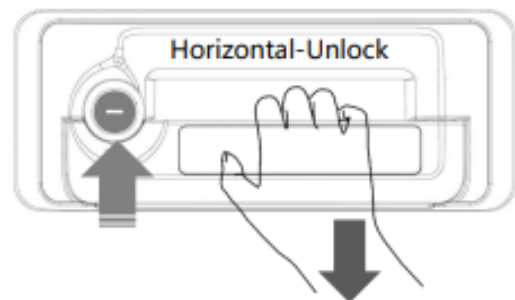
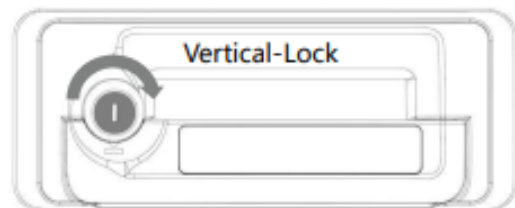

Open the shutter, insert the key into the lock, and turn the lock into a horizontal position. Pull back the handle first, then press the lock to open the lock.

40

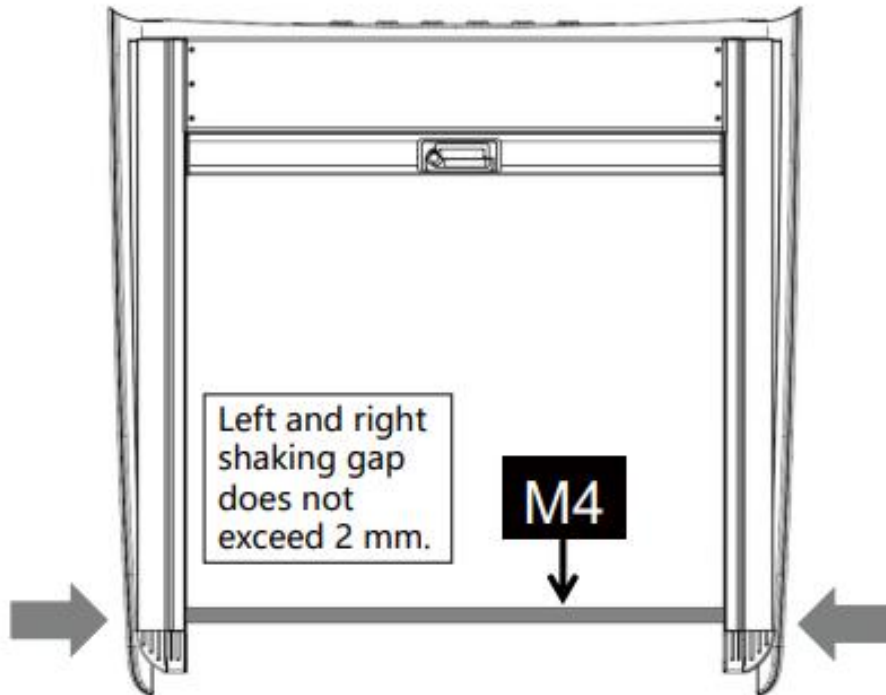

Place the (M4) adjusting lever into the side lever and test the roller shutter for smooth installation several times in parallel back and forth inside the side lever, and finally hold the tail end. Both sides, while pushing the side bar to the middle, a slight force can be adjusted.

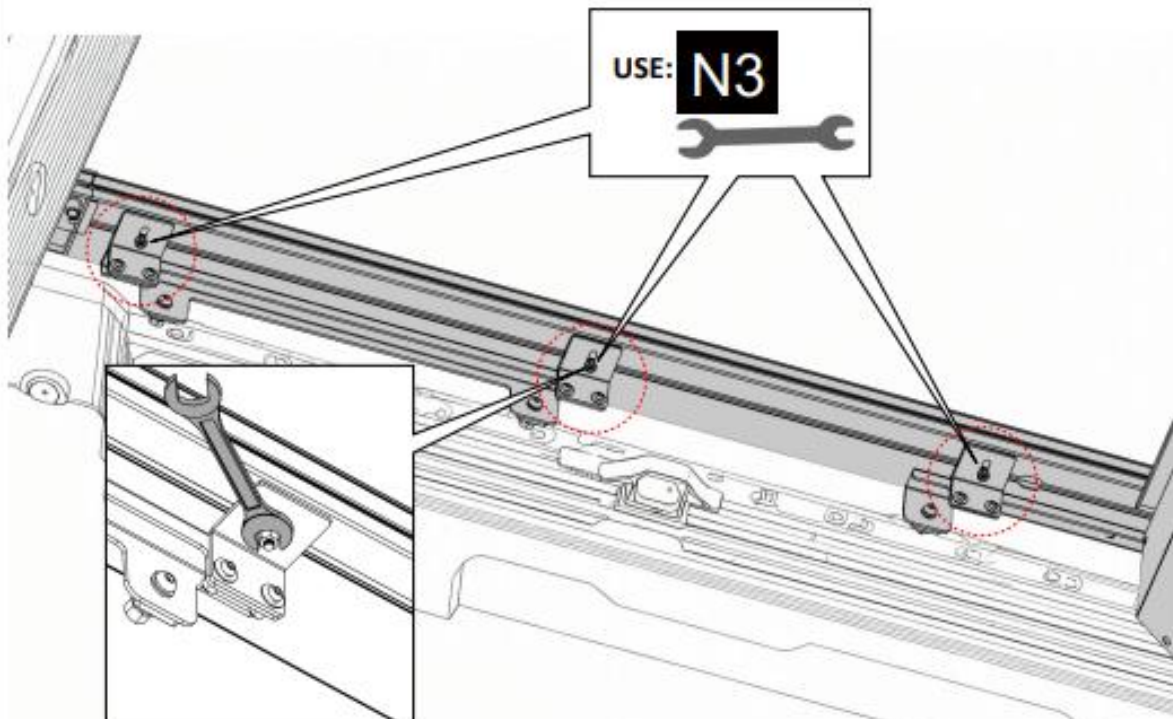

Tips: Remove gauge M5 after tightening the bolt.

Tighten the nut of the aluminum clamp using the (N3) wrench.

Option 2: Gage T

41

T

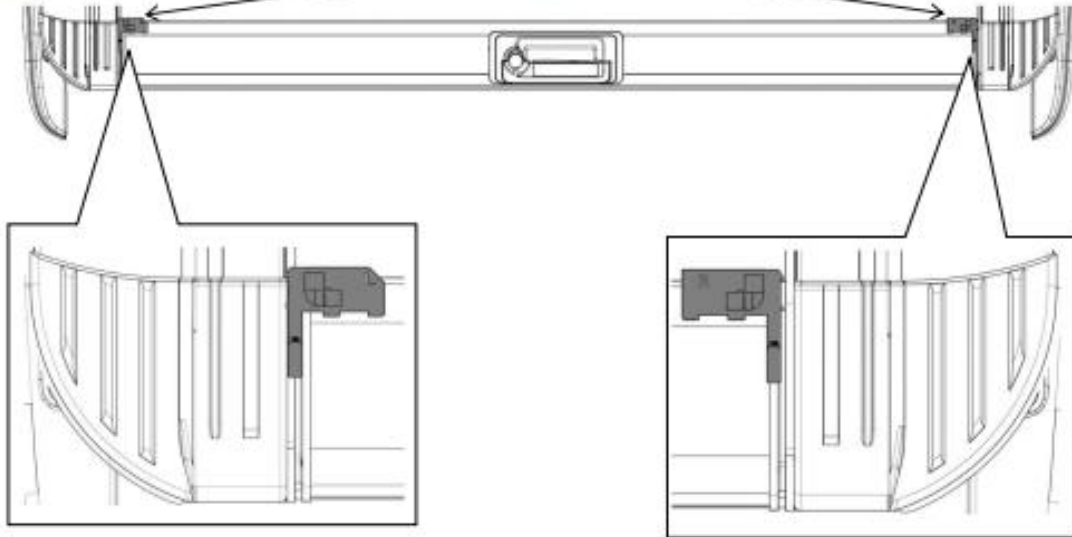

TIPS: This is another way to adjust.

Close the shutter and place the gage between the tailgate stem and the end of the side stem. A gap of 7-9 mm is optimal.

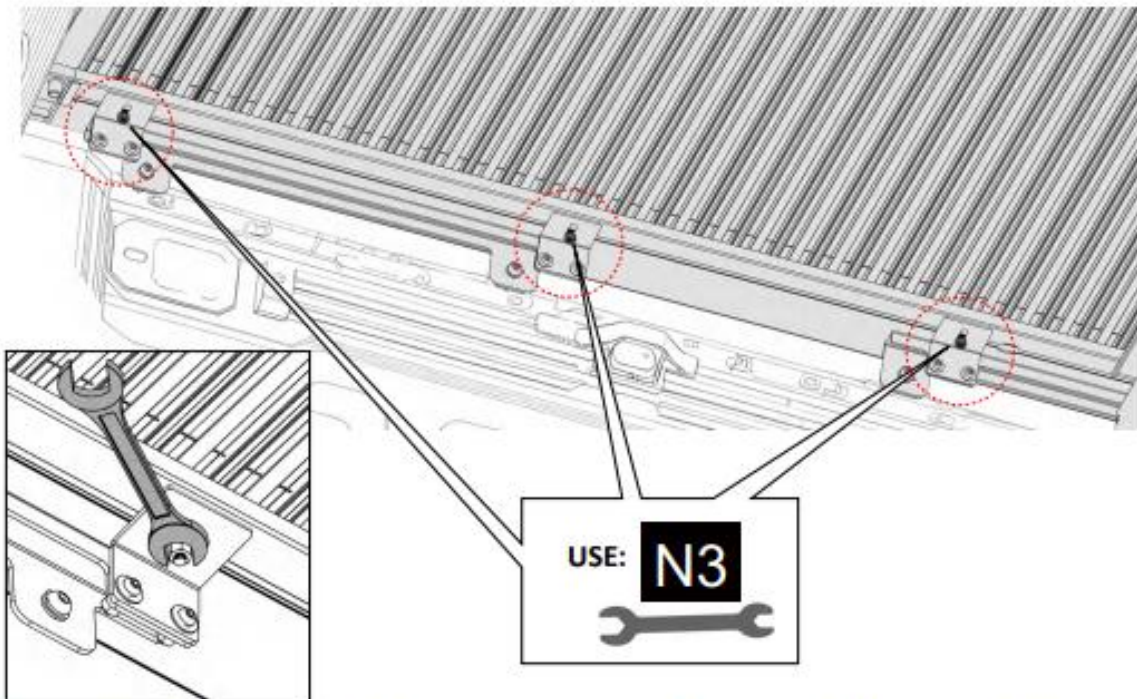

TIPS: After securing the nuts of the rear brackets on both sides, remove the gage (T) and open the shutter.

Use a wrench (N3) to tighten the rear bracket nuts on both sides, then open the shutter and tighten all bracket nuts.

42

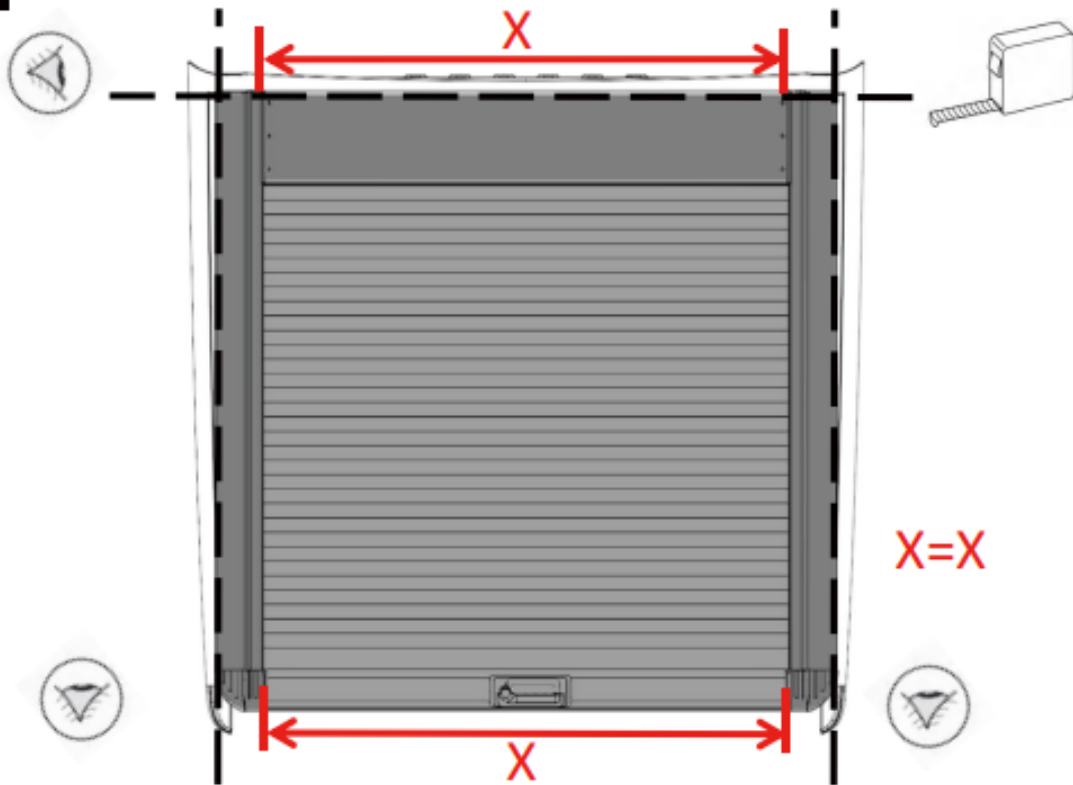

Make sure that all the bolts are tightened, close the shutter, observe whether the product is parallel, can use a ruler to measure the gap between the front end and the back end of the product is consistent, the difference is within 2 mm is the best state.

3. Product Introduction

3.1 Manual Lock Introduction.

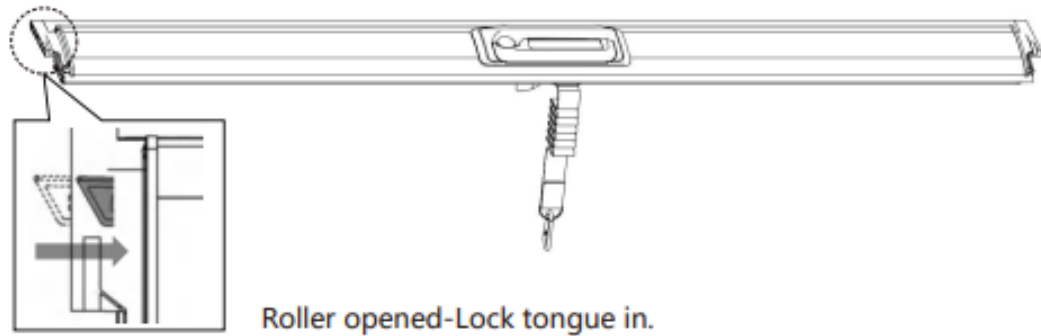
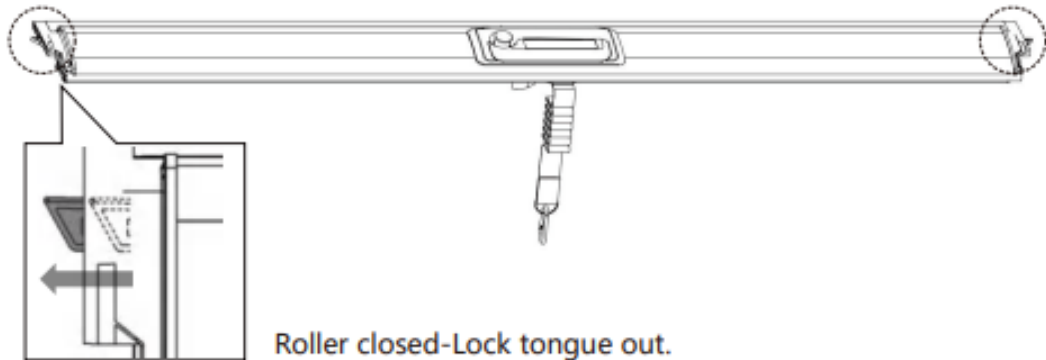

3.2 Benefits.

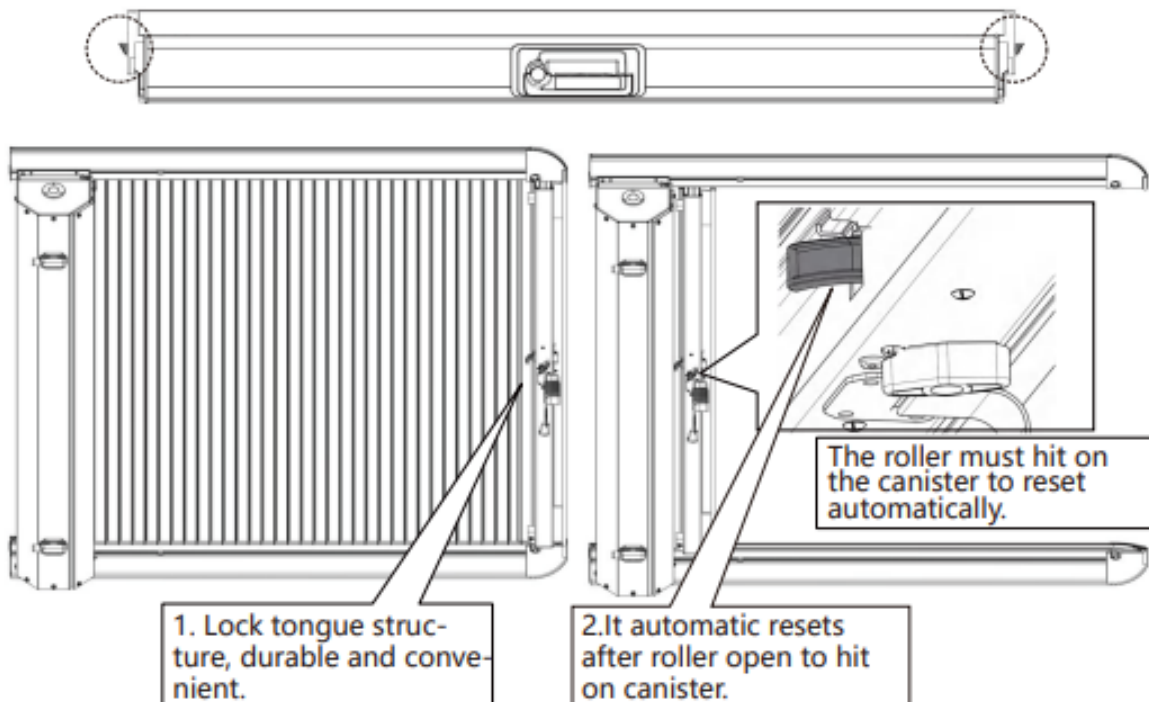

3.3 Manual lock operation.

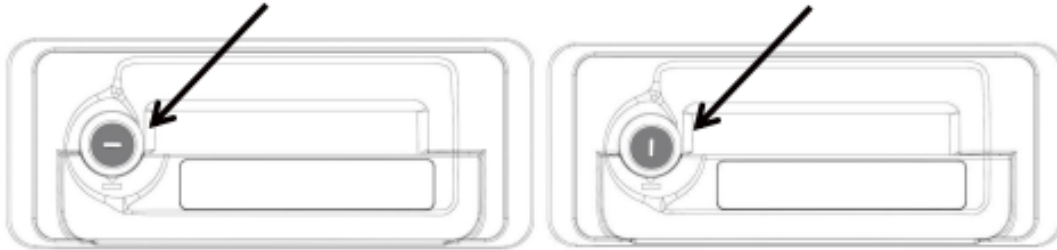

1.Unlock: Horizontal key-hole--Pull the handle backward and press to unlock.

2.Lock: Close the roller--turn the keyhole to vertical direction to lock.

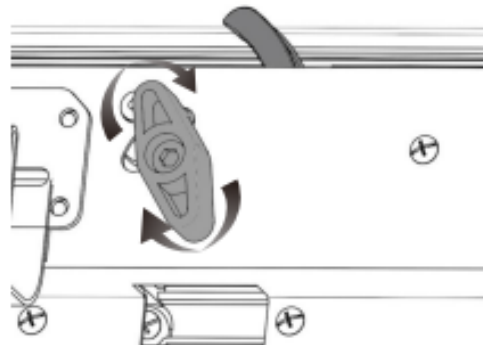
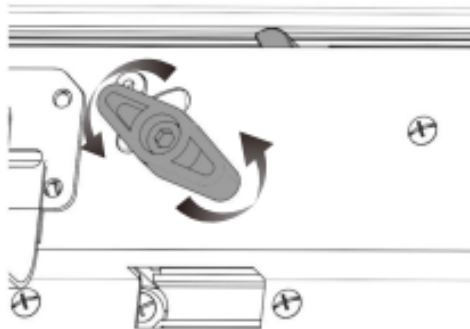

3.Rotate the block to unlock as below.

4.Rotate the block to lock as below.

3.4 Function Introduction.

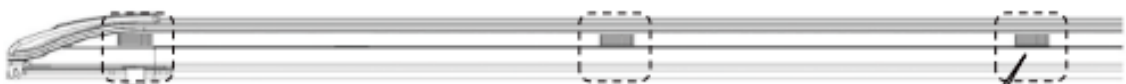

The cover can be unlocked in three positions, and this function can be used based on different needs.

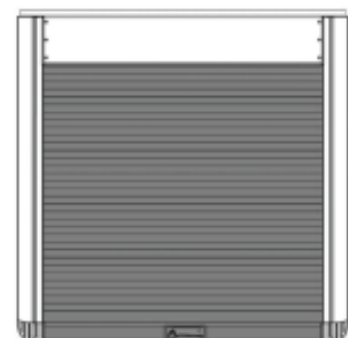

3.5 LED Light.

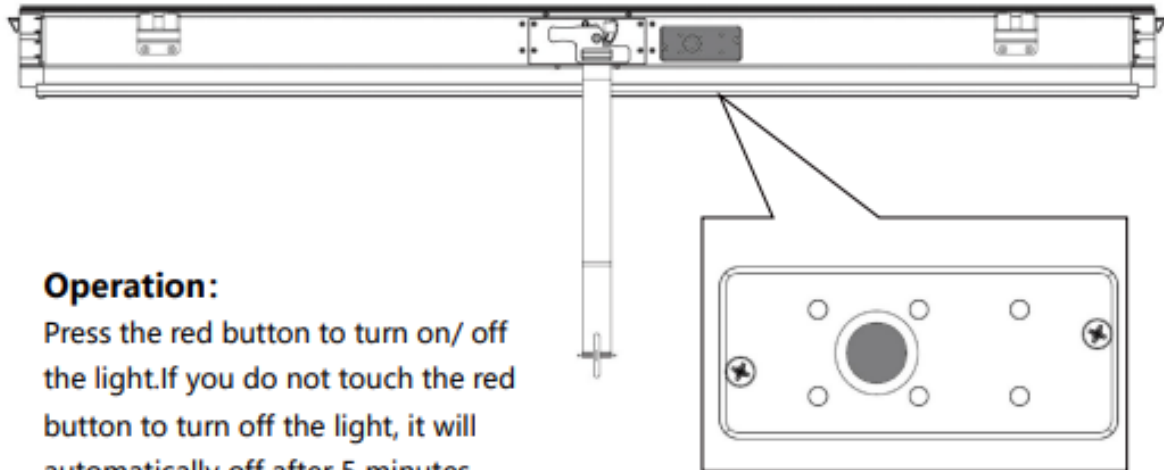

Operation:

Press the red button to turn on/ off the light. If you do not touch the red button to turn off the light, it will automatically off after 5 minutes.

Change the batteries for LED Light:

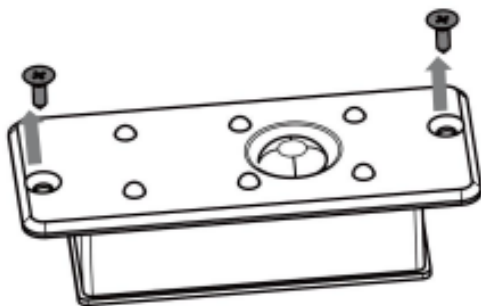

Unfasten the screws on both sides to take out the light box.

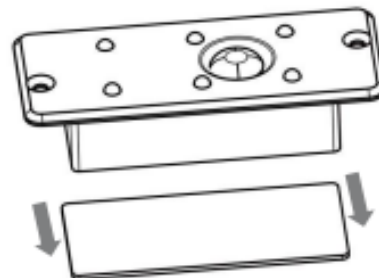

Unfasten the screws under the light box.

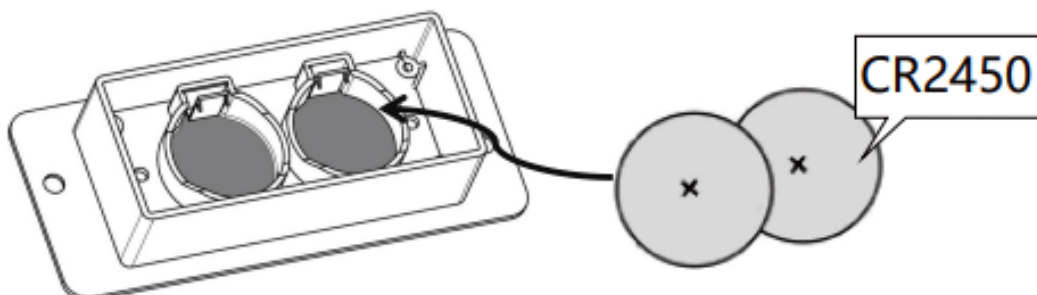

Replace with new batteries and install the light box back to the roller. Please pay attention to the +/- pole of the batteries during installation.

4. Maintenance

4.1 Daily Maintenance.

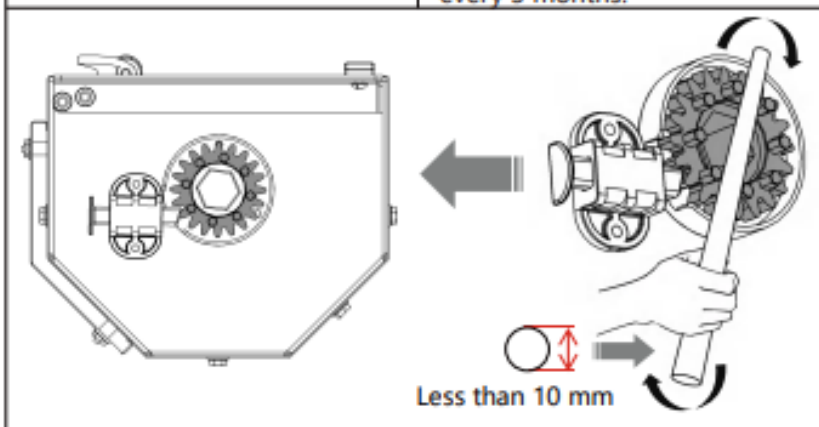
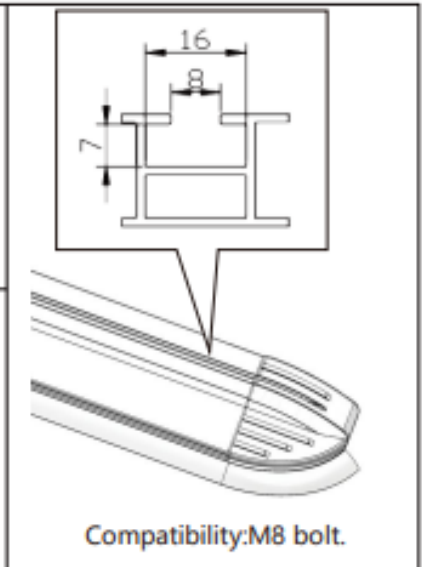
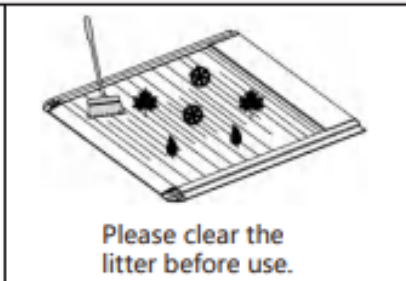
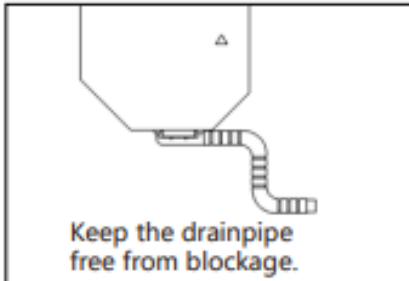

If the shutter recovery speed is slow, strength is small, you can use a screwdriver, hexagon wrench and other stick objects, clockwise rotation can be. Note: this operation does not need to pull the torsion spring control block.

5. Helpful Maintenance Hints

1. To assure quiet and smooth operation of your roller, please regularly clean and lubricate the rail tracks and canister. It is recommended every 3 months or 6,000 km, or when you use it in muddy water, desert, Gobi desert, etc. Please focus on cleaning the side rails and the spiral track inside the container which may have sand, sludge, gravel and other sundry inside. Please use the lubricants we offered or other brand silicone oil-type lubricants after cleaning, and increase the frequency of using lubricants based on actual situation. Avoid using petroleum-based product on rubber seals. Lighter oil spray lubes with PTFE (Teflon) seem to work the best when regularly wiped out and reapplied.

2. Avoid the thicker grease type because they tend to get sticky and gather a lot of dust and debris and then later dry out. Also Avoid the silicone dry lubes as they tend to cause squealing noise between the sliding components.

3. Please make sure the roller is in a stop status before cleaning/lubricating, to avoid causing extrusion or collision injury.

4. To clean the rail tracks and the spiral track inside the container, please apply the lubricant to a rag and wipe it .

inside of the rail tracks, along the underside of the sweep seal and the top of the wear strip. Repeat until the dust has been removed. You can also use a high-pressure water gun if necessary and then make sure all components have been lubricated. Please do not direct aiming the high-pressure water gun to the motor/ECU/connector when cleaning, and do some necessary waterproof protection for connectors/plugs.

5. To clean the canister, remove the rail stops, or vertical rails as required, and run the cover out far enough that you can get into the canister. Apply the lubricant to a rag and wipe the inside of the canister, including all components inside the canister. Ensure the Drain Tubes are clear of any debris or blockage. Reassembly the cover .

6. If you find that the brightness of the remote control signal indicator light is obviously weakened, or the button indicator light does not on, please replace the battery in time (battery model: CR2450).

7. To keep the roller in tip-top condition, we recommend washing it the same as caring for your truck finish. A lack of proper cleaning and maintenance can affect the operation of the product and reduce its life.

8. Do not attempt to drive with the tail panel in the partially open position.

9. Tonneau cover must be free of foreign material including snow and ice before opening panels.

10. Do not tow your vehicle from the rear with the tonneau on your truck.

11. Do not operate vehicle with objects on top of cover.

Failure to follow these cautions may result in severe damage and will void your warranty!