



RAV4

Accessory Part Nos: PZQ4442121

PZQ4442131

OCTOBER 2018 PRODUCTION ONWARDS

Fitting Time: 45 minutes

Side Steps

Fitting Instructions

— Parts Supplied —

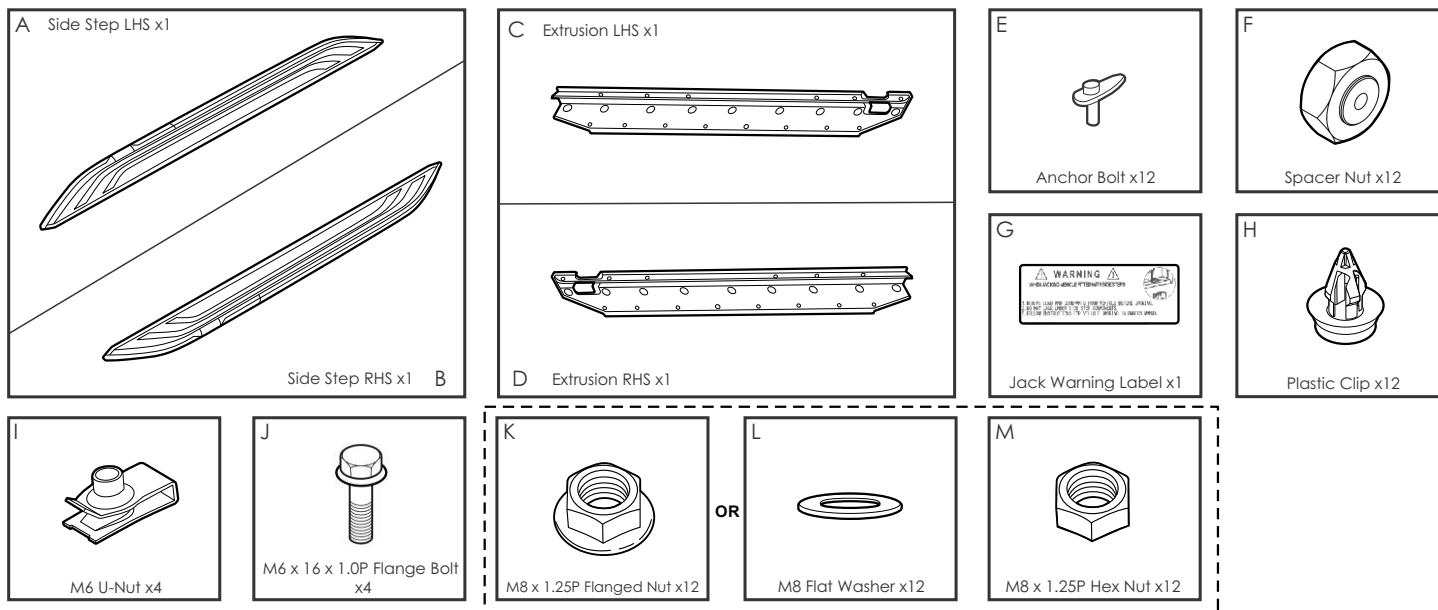

— Tools and Materials Required —

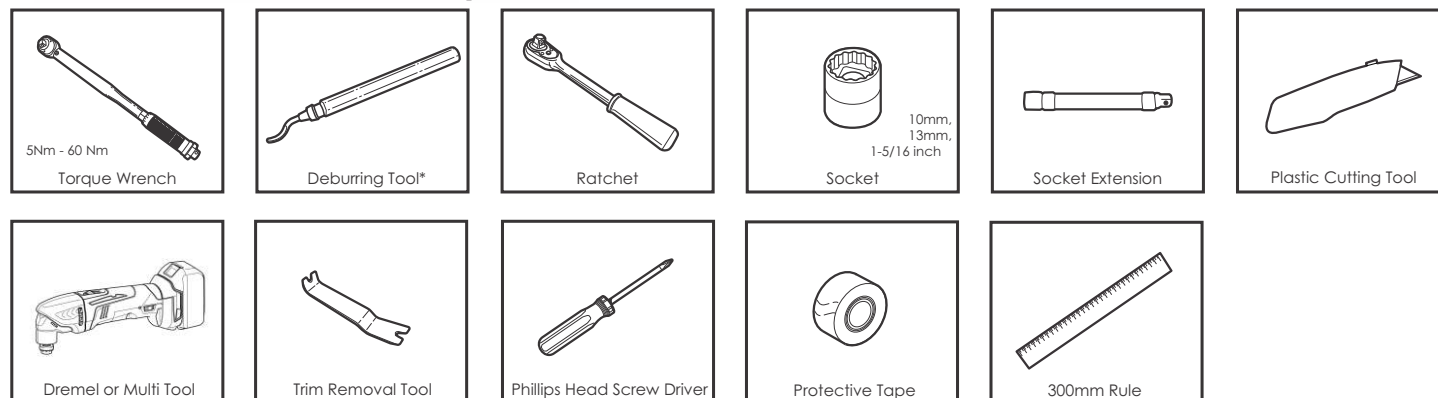

— General Notes

- Read through the fitting instructions before installation of accessory.
- Always install the accessory following the fitting instructions. Failure to do so may cause damage to the vehicle or the accessory.
- Ensure all recyclable discarded vehicle accessory components and packaging are recycled following local recycling regulations.
- It is always recommended that this accessory is fitted by a qualified Toyota Technician.
- Safely store and protect any removed vehicle components.
- Ensure all bare metal surfaces are protected using Automotive Bare Metal Primer and touch-up paint.
- Remove all metal swarf and dust from all vehicle surfaces if surface is used for accessory installation.

— Safety Notes

- Check that all work practices comply with safety standards.
- Please wear appropriate clothing and use safety equipment.



— Fitting Time



45 minutes

— General User Information

Caution

- To maintain your Side Step, wash regularly using car wash detergent, hose off and chamois dry.
- Can be maintained with Autosol® metal polish or similar.
- Plastic components can be maintained with Nulon Ezy-Glide® silicon spray or similar.

– Layout Diagram

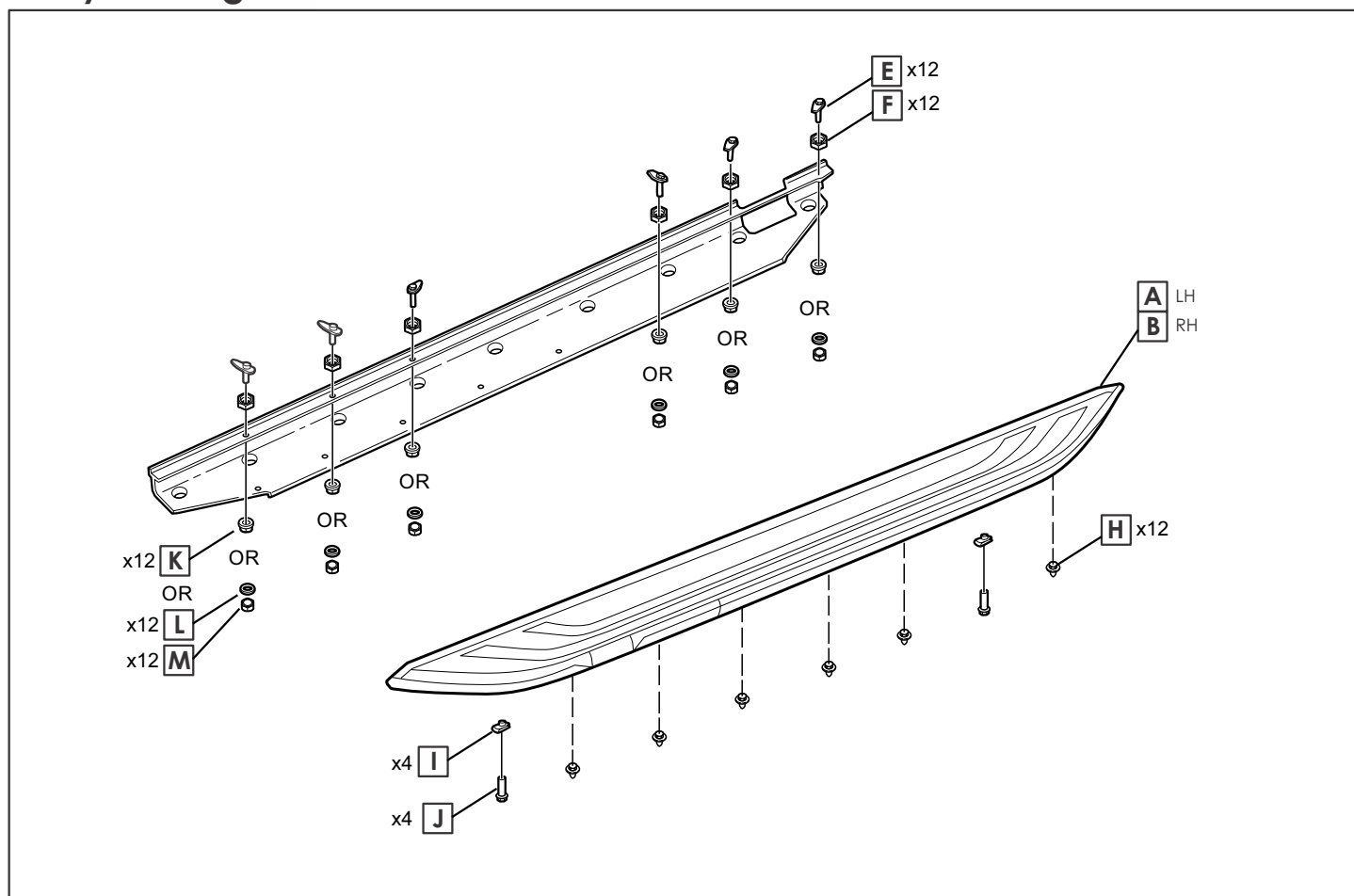

– Step 1

Important



Always refer to the vehicle's Workshop Manual when removing vehicle components.

- Remove all parts from carton and discard packaging.
- Check contents of carton to ensure all parts are present.
- Separate the plastic step from the aluminium extrusion.
- Remove and retain 1 x screw (1) and 1 x clip (2) from rear wheel wind deflector (3).
- Release clip (4) to remove and retain rear wheel wind deflector.

Important



Do not pull off rear wheel house trim, as the double sided tape will disengage.

Tools Required:



Trim removal tool

Ratchet

10mm socket

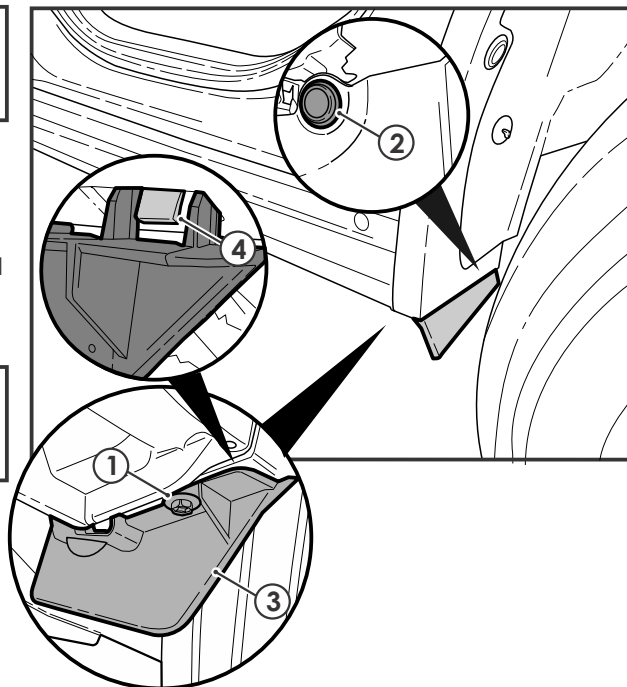

– Step 2

- Remove and retain 8 x plugs (1), 2 x clips (2) and 2 x screws (3) from the sill moulding (4).
- Apply temporary protective tape to rear wheel arch trim (5), front wheel arch trim (6) and front of sill moulding (7).
- Pull sill moulding outboard to release 9 x plastic clips behind moulding.
- Remove plastic clip (8) from front of sill moulding to create clearance.
- Push sill moulding towards the front of the vehicle to release from the rear wheel arch moulding, then pull the sill moulding rearward and clear of the vehicle.

Tools Required:



Phillips's head screwdriver

Trim removal tool

Protective tape

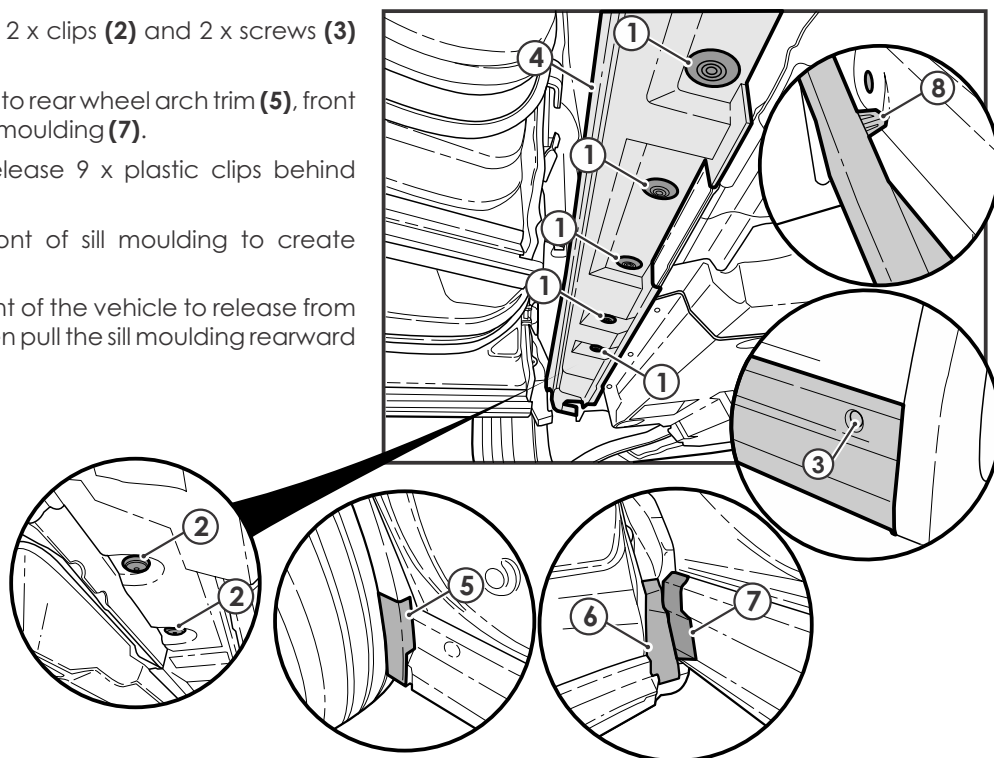

— Step 3

- Trim sill moulding along bold line as shown (1).

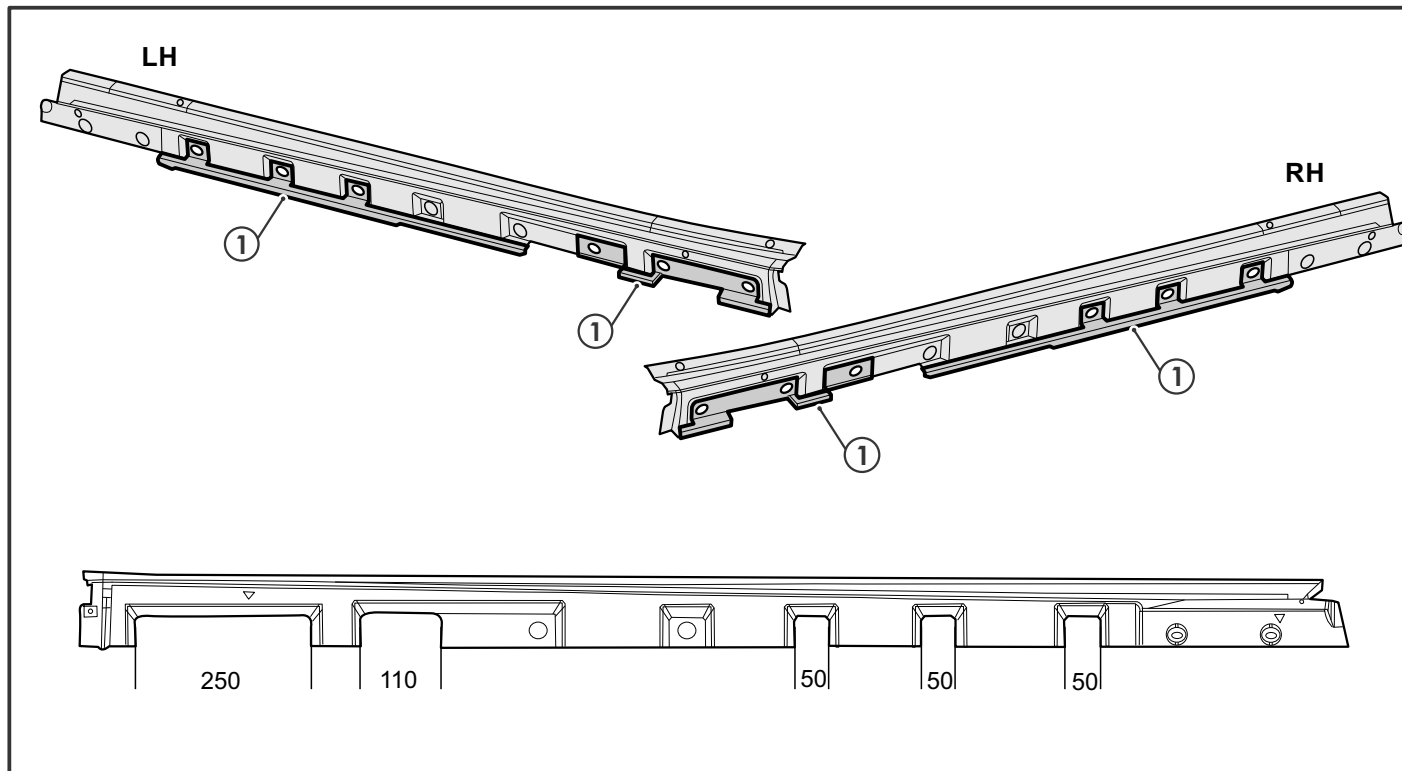

Tools Required:

Multi tool

Plastic Cutting Tool

– Step 4

- Install spacer nut (1) on to anchor bolt (2) until the end of the bolt is approximately flush with the bottom of the spacer nut.
- **NOTE: Ensure correct spacer nut orientation (boss towards vehicle).**
- Install anchor bolts into sill section of vehicle using following procedure:
 - Insert long side through hole first followed by short side.
 - Rotate bolt to orientation shown in image (3).
 - Orientation of 3rd (4) and 4th (5) bolts from front is critical for correct side step fitment.
- Pull down so mating surfaces of anchor plate and sill are flush
- Push back until bolt is central to hole. Note: Short end of plate sits under sheet metal in some locations.
- Tighten spacer nuts by hand.

Important



Ensure that the spacer nut is flush against the sill surface, and the boss is inside the hole.

- Torque spacer nuts to 45Nm.

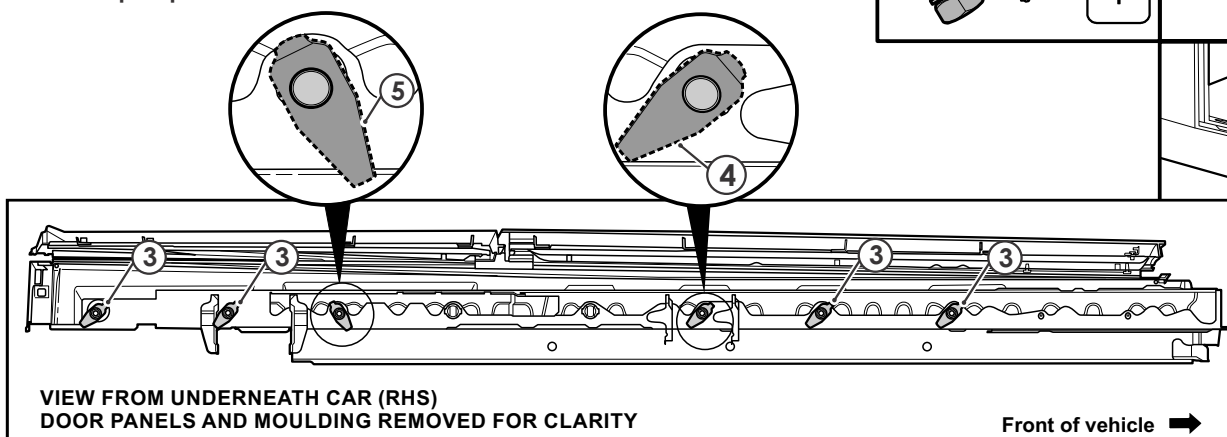
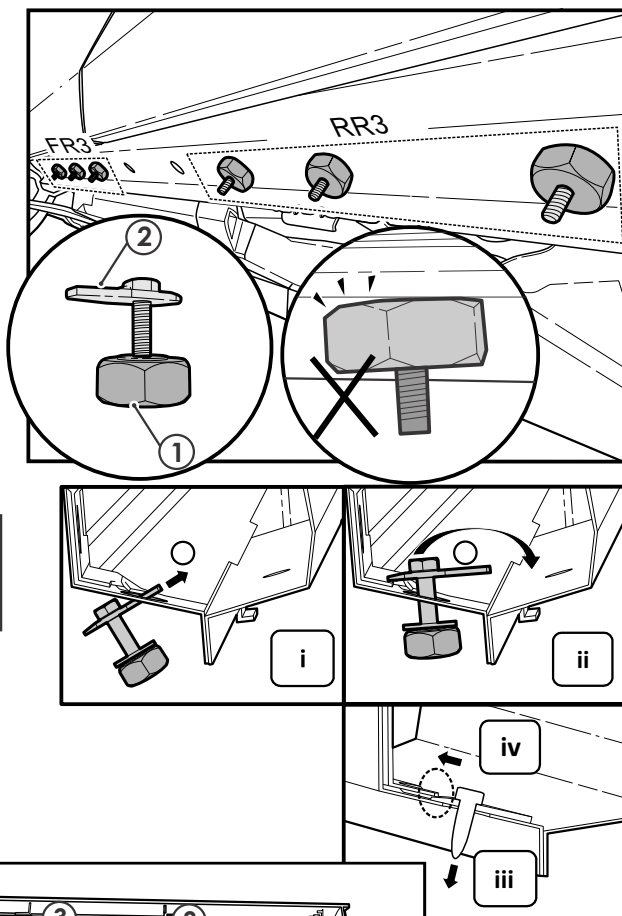

– Step 5

- Re-install sill moulding (1) in reverse order of removal with 2 x plugs (2), 2 x clips (3) and 2 x screws (4). Discard remaining plugs.
- Re-install rear wheel mud guard with original fasteners. Tighten until just tight.
- Remove temporary protective tape.

Tools Required:



Phillip's head screwdriver

Ratchet

10mm socket

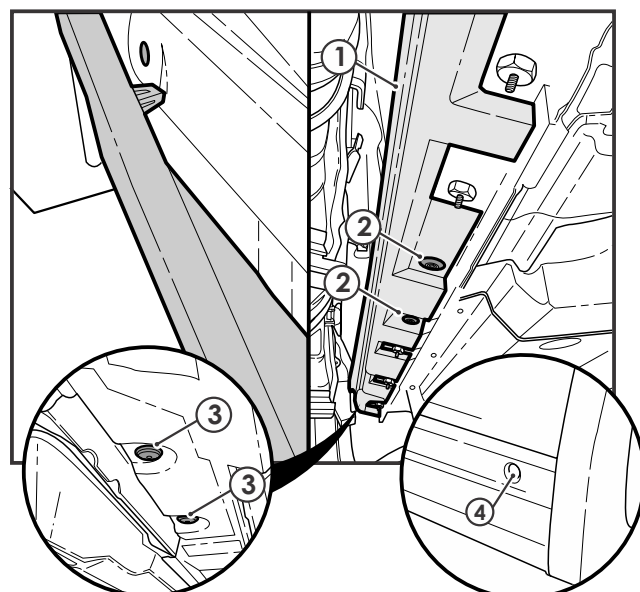

– Step 6.1

- For Side Steps provided with a M8 Flanged Nut in the fitting kit, continue with this step.
- For Side Steps provided with a M8 Flat Washer and M8 Hex Nut in the fitting kit, go to step 6.2.
- Install extrusion (1) to vehicle.

Important



Take care not to scratch the vehicle while installing extrusion.

- Install M8 flanged nuts (2) to anchor bolts.
- **Torque M8 flanged nuts to 24Nm.**

Tools Required: 

Torque wrench

13mm socket

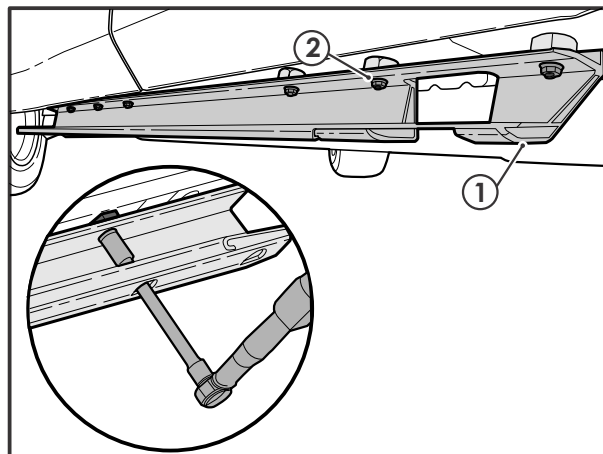

– Step 6.2

- Install extrusion (1) to vehicle.

Important



Take care not to scratch the vehicle while installing extrusion.

- Install M8 flat washers (3) and M8 hex nuts (4) to anchor bolts.
- **Torque M8 hex nuts to 24Nm.**

Tools Required: 

Torque wrench

13mm socket

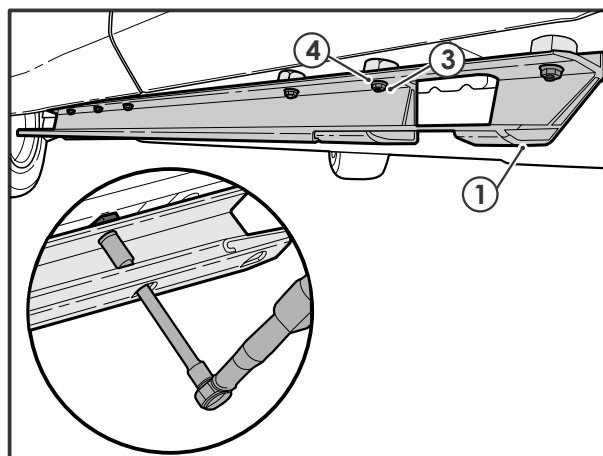

– Step 7

- Install 6 x plastic clips (1) and 2 x U-nuts (2) into the plastic step.
- **NOTE: Ensure correct U-nut orientation.**

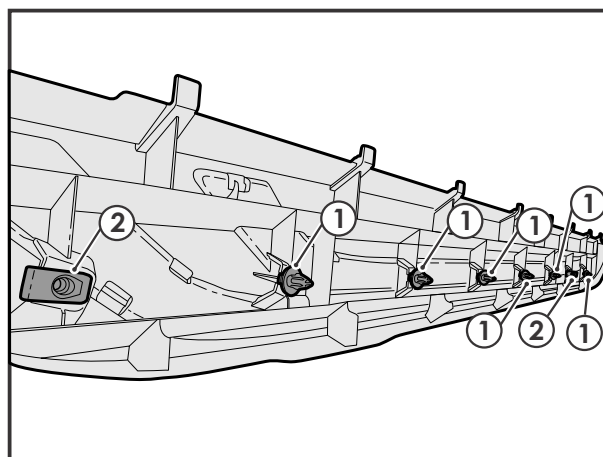
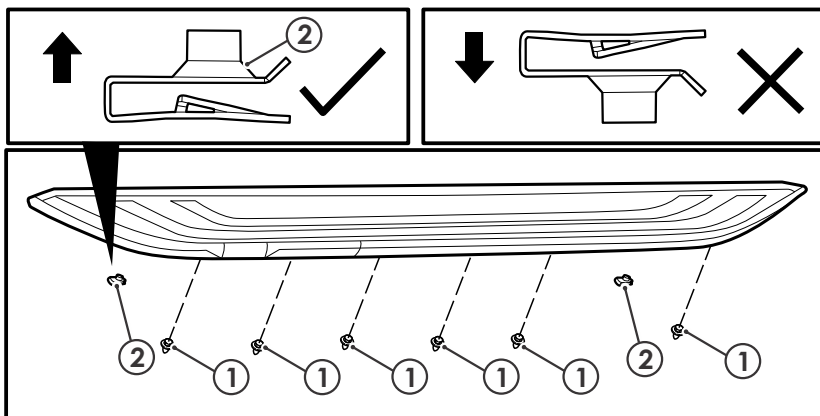

— Step 8

- Ensure front vehicle door is open and rear vehicle door is closed to allow access.
- Install hooks of plastic step into the large holes in the extrusion, then pivot the step downwards. Ensure that the plastic clips align with the small holes in the extrusion.
- Press down on the plastic step until every plastic clip locks into place.
- Install an M6 flange bolt (1) into each U-nut.
- **Torque M6 flange bolt to 6Nm.**

Tools Required:

Torque wrench

10mm socket

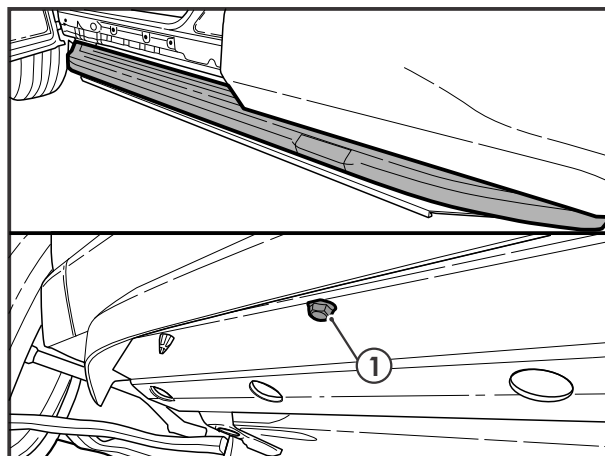

— Step 9

- Repeat all steps for other side of vehicle.

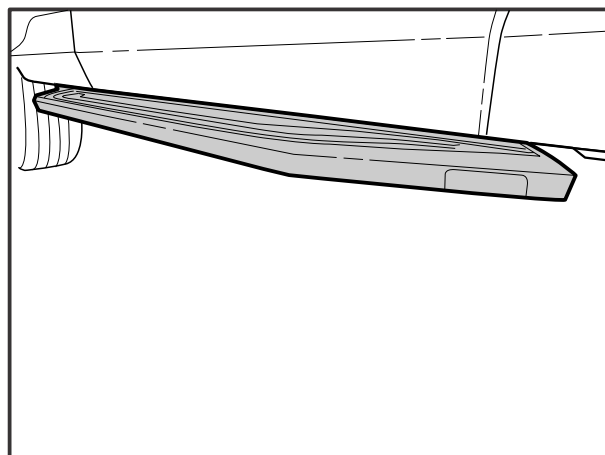

— Step 10 —

- Attach the Jack Warning Label (Item L) to the vehicle jack.
- Ensure the existing label on the jack is NOT covered by the new Jack Warning Label as shown in Figure 10.
- Remove protective film (1) from stainless steel inserts on each side step.

