

**Vehicle model: Toyota Hilux
Year of manufacture: 2020 onwards**

**Dust Defence Kit
With and Without Ute Liner
Installation Instructions**

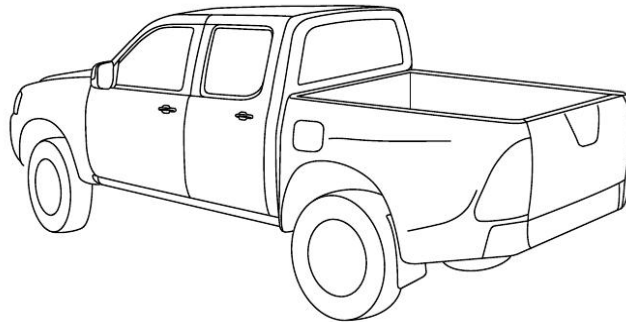

**Accessory Part No. PZQ7D-89A00, PZQ7D-89A01,
PZQ70-89A13, PZQ7D-89A88**

Installation Time:

Approx. 30min Without Ute Liner Fitted
Approx. 1 hour With Ute Liner Fitted

Place these instructions in vehicle's glove box after installation is complete

PLEASE REFER TO PAGE 3 OF THIS INSTRUCTION FOR A LIST OF PARTS AND QUANTITIES

IMPORTANT!

- Read instructions carefully before installation.
- It is strongly recommended that installation is conducted by an authorized dealer.
- This product must be installed exactly as specified in these instructions.
Failure to do so may result in improper fit and/or retention.

RECOMMENDED TOOL LIST - (Not Supplied in Kit)

- Drill and Ø6.5mm & Ø3.5mm Drill Bit
- Sharp Scissors or Sharp Knife
- 8mm Spanner & Socket
- Masking Tape
- Rivet Gun
- Marking Pen
- Centre Punch
- Rubber Mallet
- Torque Wrench
- Torch

Toyota Hilux Dust Defence Kit Installation Steps Flow Chart

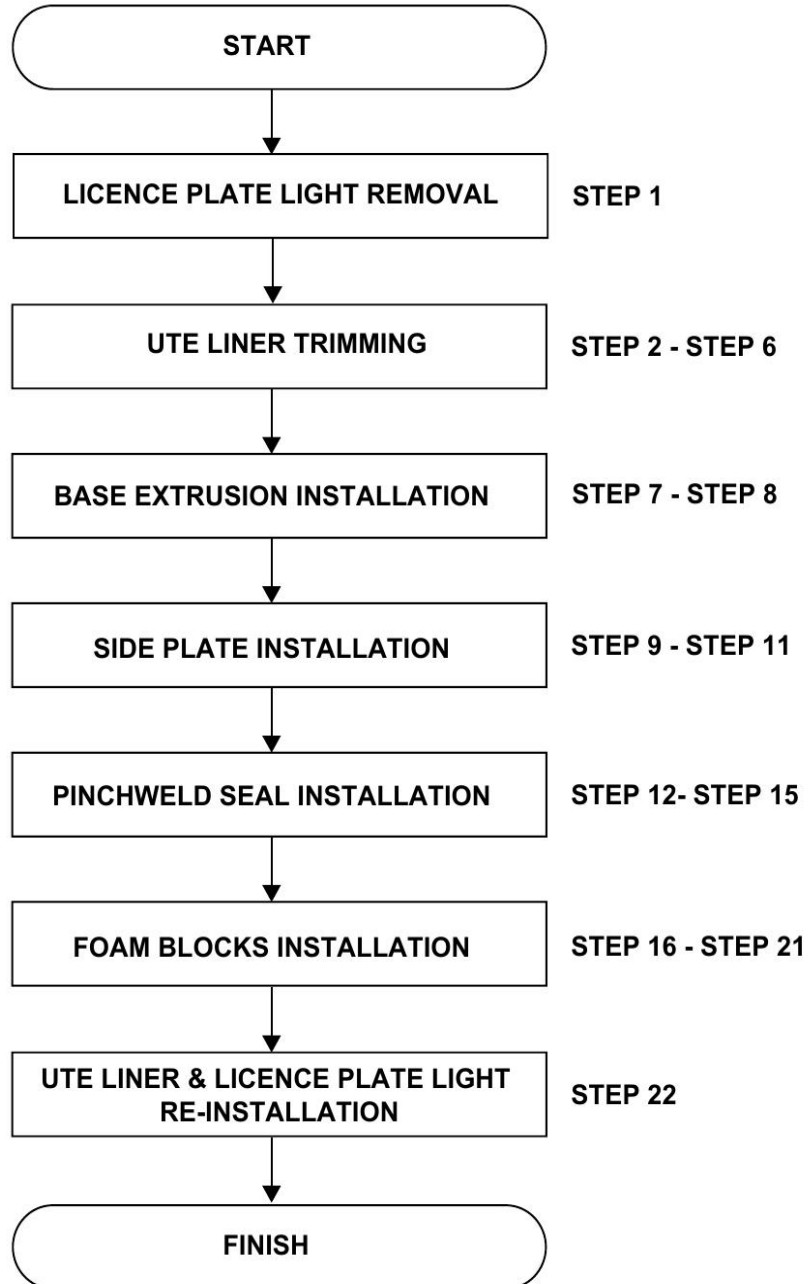

PARTS CHECK SHEET

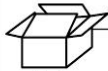

PARTS IN MAIN CARTON

PZQ70-89A13, PZQ7D-89A88

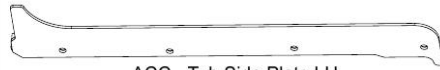

ACC - Tub Side Plate LH
Qty - 1

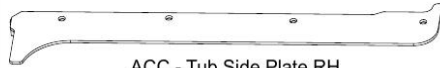

ACC - Tub Side Plate RH
Qty - 1

PZQ7D-89A00, PZQ7D-89A01
(plate with bend on top)

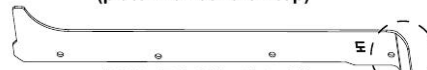

RSB - Tub Side Plate LH
Qty - 1

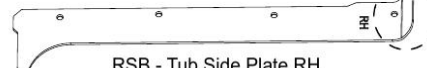

RSB - Tub Side Plate RH
Qty - 1

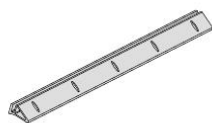

Base
Extrusion
Qty - 1

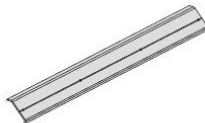

Cover Base
Extrusion
Qty - 1



Pinch-weld
Bulb Seal
Qty - 1



Fitting Kit
Qty - 1



PARTS IN FITTING KIT



Retention Clip
Short
Qty - 2



Retention Clip
Long
Qty - 2



Self-tapping
Screw
Qty - 4



M5 Small
Washer
Qty - 8



Rivet
(large)
Qty - 5



M5x30 Hex
Head Screw
Qty - 8



M5 Nylock
Nut
Qty - 8



Alcohol Wipe
Qty - 2



Primer
Qty - 2



Rust
Inhibitor
Qty - 1

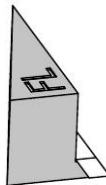

Foam block front left "A"
Qty: 1

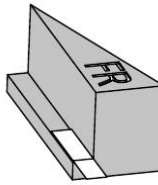

Foam block front right "B"
Qty: 1

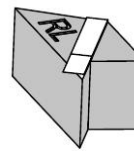

Foam block rear left "C"
Qty: 1

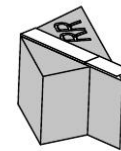

Foam block rear right "D"
Qty: 1

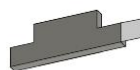

Foam Pad RH
Qty - 1

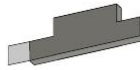

Foam Pad LH
Qty - 1



Foam plug
Qty: 12



M5 Cap
Qty: 8



Fitting
Instruction
Qty - 1

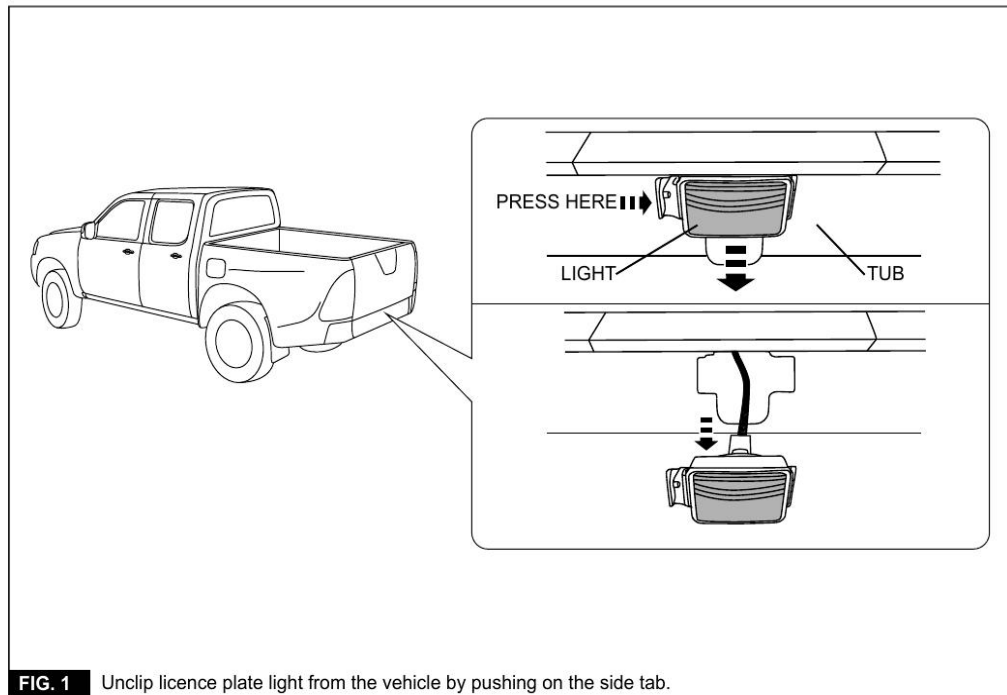

FIG. 1 Unclip licence plate light from the vehicle by pushing on the side tab.

UTE LINER TRIM
(FOR VEHICLES WITHOUT UTE LINER PLEASE GO TO STEP 7)

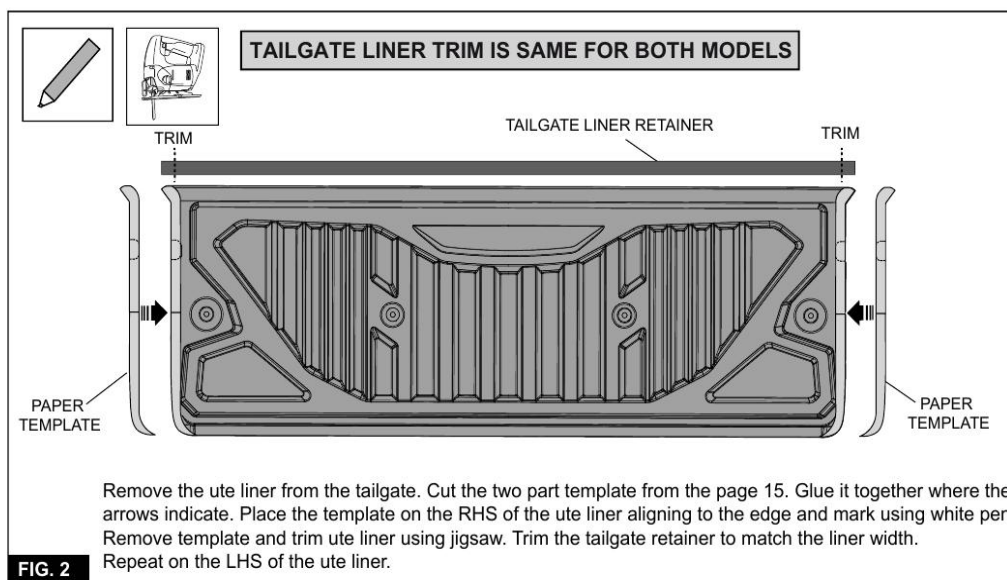

FIG. 2 Repeat on the LHS of the ute liner.

UTE LINER TRIM
(FOR VEHICLES WITHOUT UTE LINER PLEASE GO TO STEP 7)

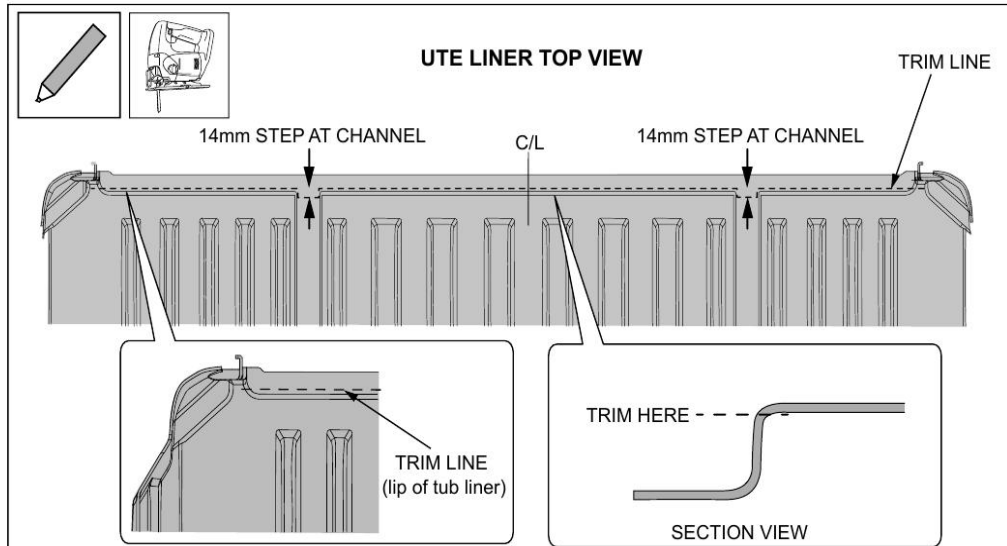

FIG. 3 Remove the ute liner from the tub and retain all the hardware. Trim along the top lip of the ute liner floor.

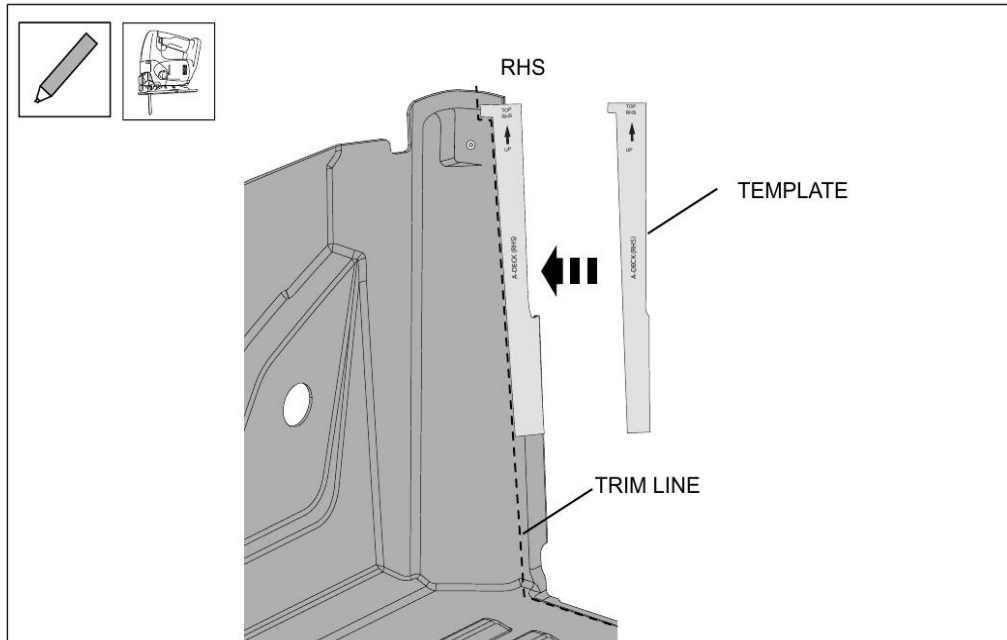

FIG. 4 Cut out the paper template from page 17 and place inside the ute liner rear RHS as shown. Mark the dotted line with white pen and extend the line to the floor until it intersects with the trim line in the previous step. Trim the ute liner with a jigsaw. Repeat on the LHS.

UTE LINER TRIM (GR-S)
(FOR VEHICLES WITHOUT UTE LINER PLEASE GO TO STEP 7)

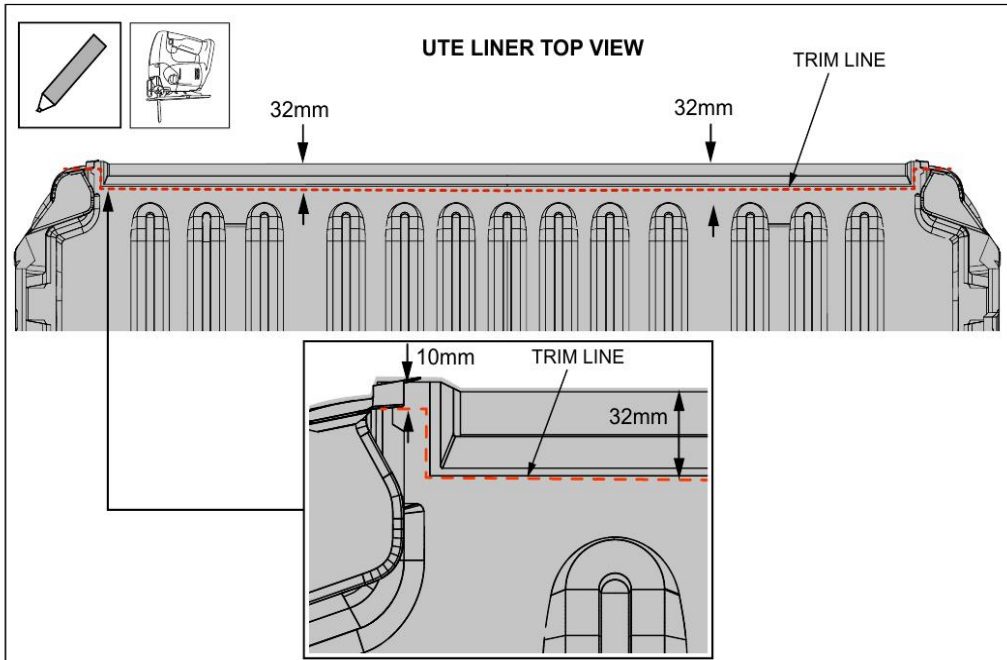

FIG. 5 Remove the ute liner from the tub and retain all the hardware. Trim along the top lip of the ute liner floor. Remove and discard existing ute liner retainer from tub floor.

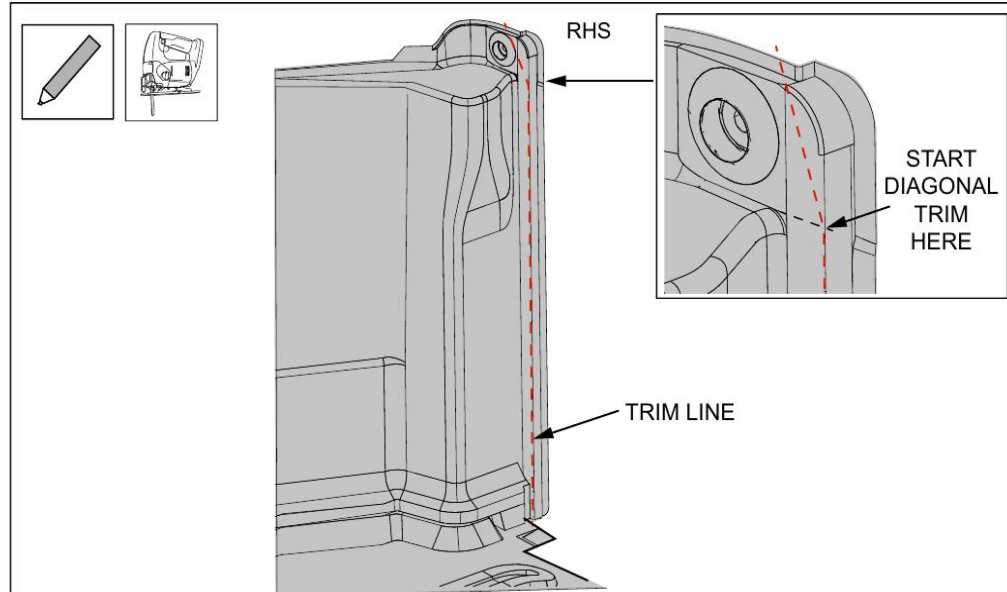

FIG. 6 Mark the dotted line (inside the corner of the liner) with white pen and extend the line to the floor until it intersects with the trim line in the previous step. Trim the ute liner with a jigsaw. Repeat on the LHS.

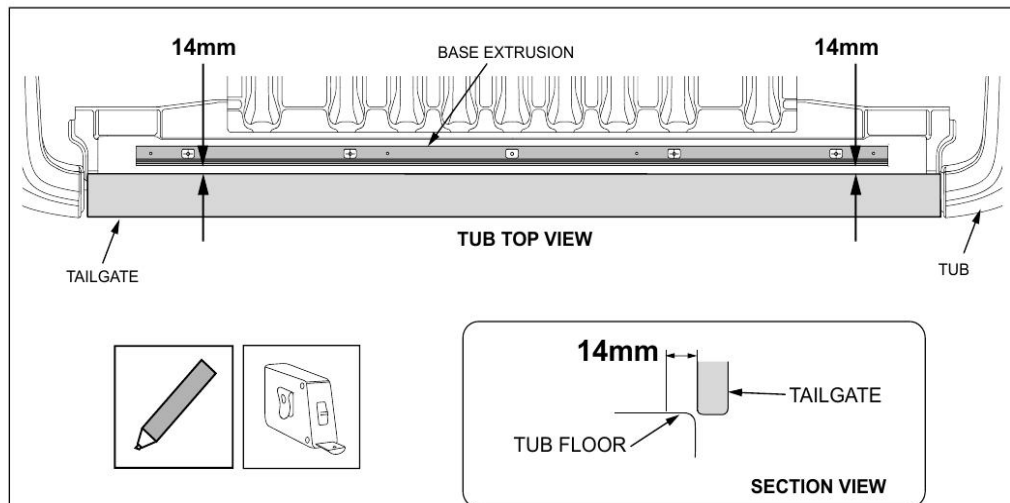

FIG. 7

With the tailgate closed, measure and mark 14mm from the inside edge of the tailgate at 2 or 3 points. Carefully align the base extrusion with the 14mm marks and **centre it between the side plates**. Before drilling carefully close the tailgate and double check that the base extrusion is parallel with the tailgate i.e. there is an even gap between the base extrusion and the tailgate. If in doubt, carefully fit the pinchweld seal (see step 10) temporarily and check the operation of the tailgate is not hindered by the seal.

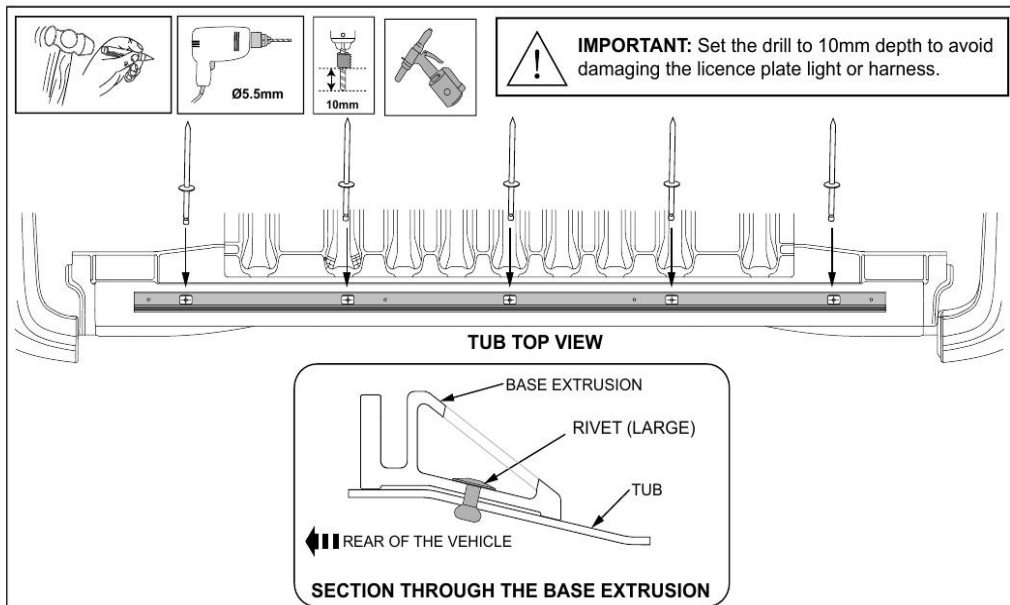
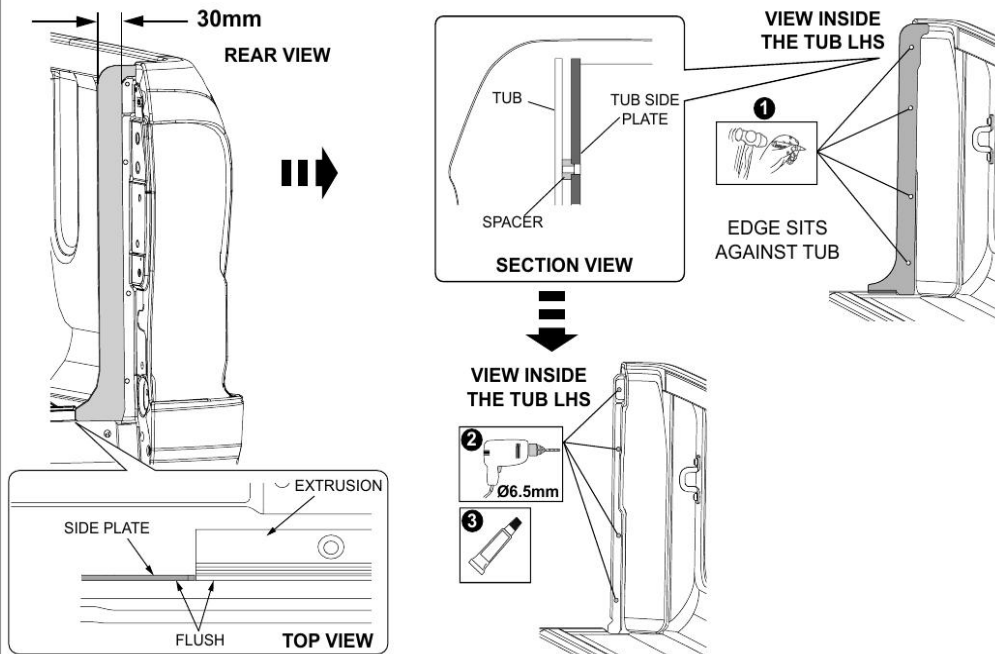

FIG. 8

Using the pre-drilled holes in the base extrusion as a guide, centre punch and drill 5 holes through the centres of the slots in the base extrusion and tub with 5.5mm drill, set to 10mm depth. Apply rust inhibitor. Secure the extrusion to the tub using 5 large rivets.

NOTE: Use the flat Side Plate for the ACC Roller Cover and for the RSB Roller Cover the plate with bend on the top.



Trial fit tub side plates to the inside of the tub with the spacers oriented as shown. The side plate should be 30mm inboard of the tub flange as shown. Mark and centre punch the centre points of four (4) hole positions on each side. Remove the plates and drill $\varnothing 6.5\text{mm}$ holes for each of the eight (8) centre marked locations. Apply rust inhibitor to all drilled holes.

FIG. 9

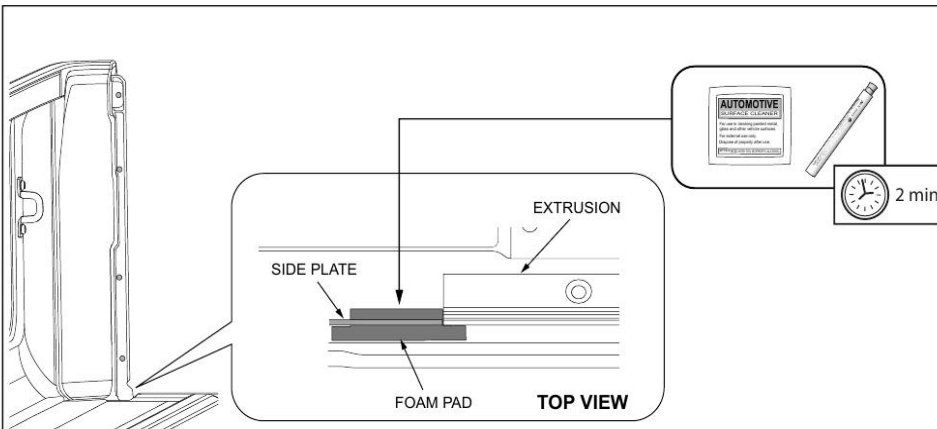

Clean the surface where the foam pad will go with alcohol wipe and apply primer. The foam pad should be applied flush between the extrusion and the tub flange. **Note: The side plates sit on top of the foam pads.**

FIG. 10

NOTE: Use the flat Side Plate for the ACC Roller Cover and for the RSB Roller Cover the plate with bend on the top.

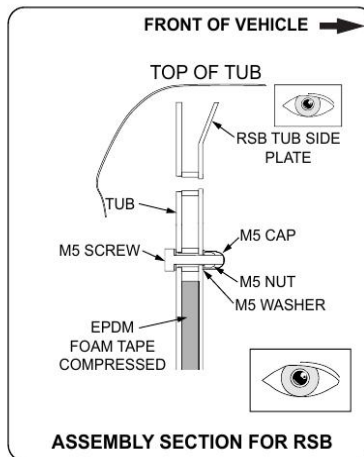
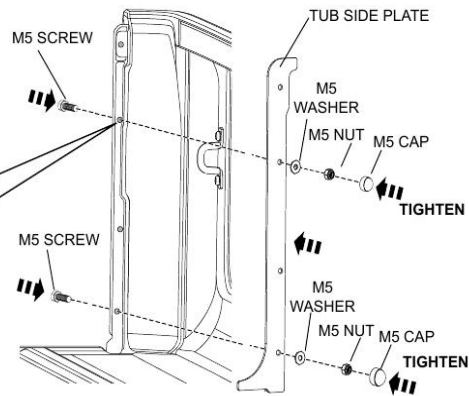
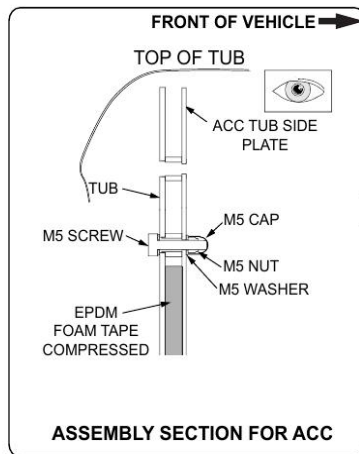

Fit tub side plate to the vehicle tub & align the holes. Secure with M5 screws, M5 washers, M5 nuts and caps. Tighten the screws as shown. **Torque to 5Nm.**

FIG. 11 NOTE: 20x20 EPDM foam tape faces rearward. LHS shown, repeat for RHS.

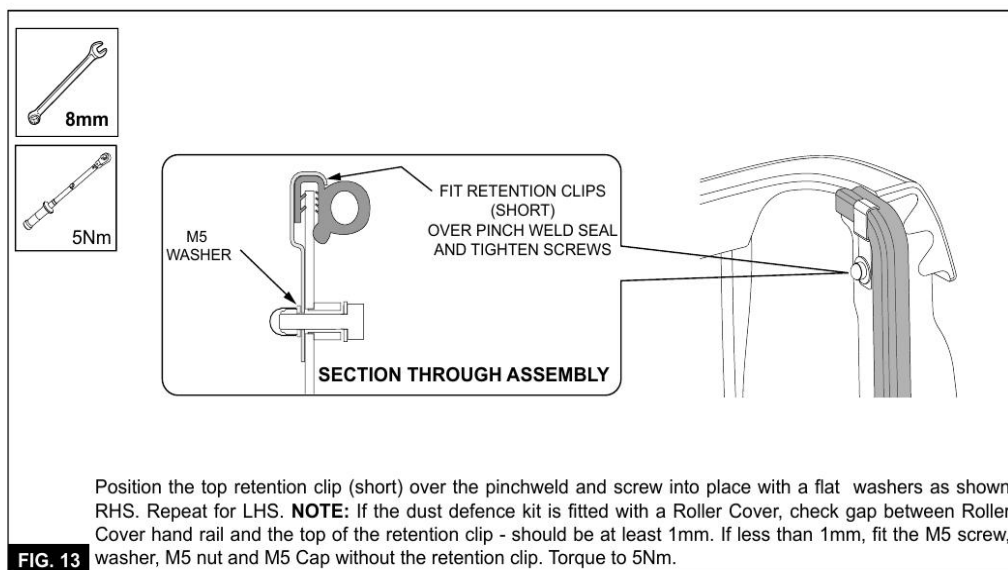
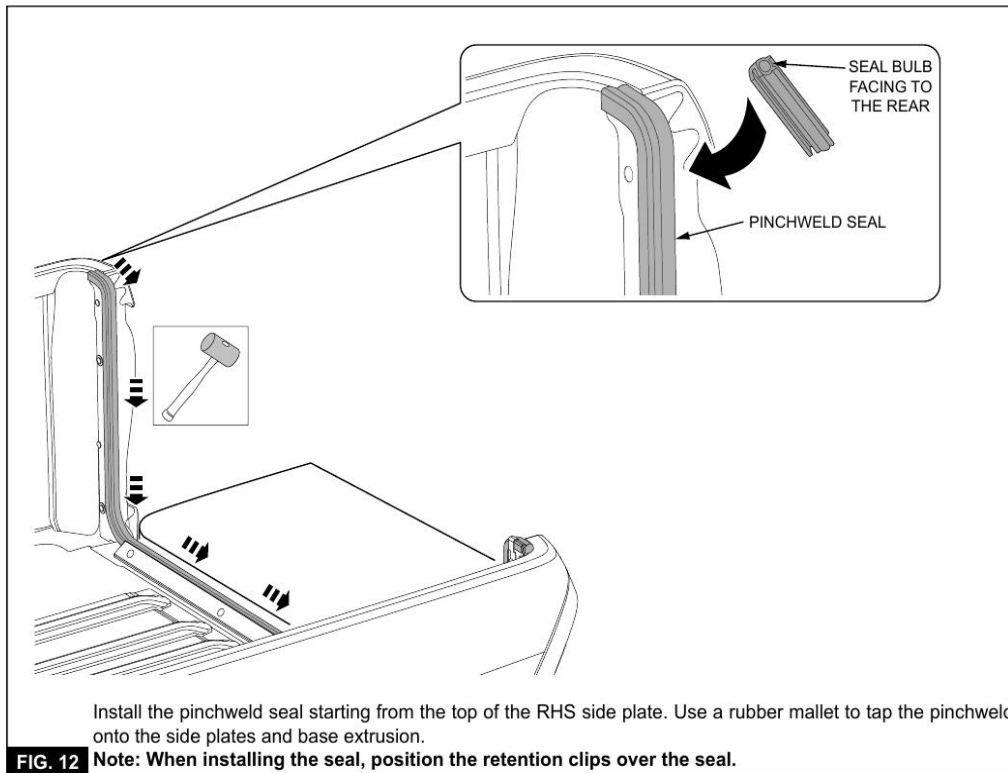

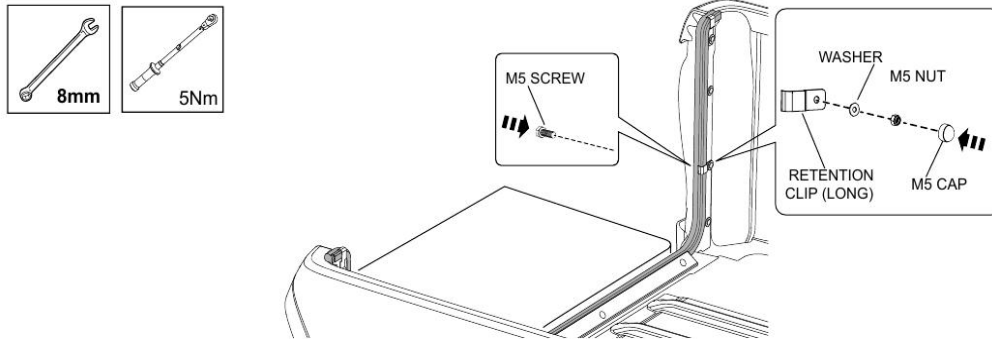
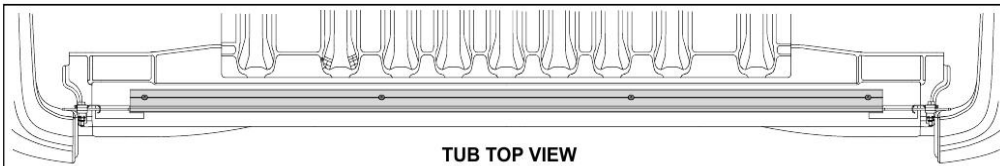

FIG. 14 Position the centre retention clips (long) over the pinchweld and fasten in place using M5 screw, washer, M5 Nylock nut and M5 Cap. **Tighten to 5Nm.** LHS shown, repeat for RHS.



TUB TOP VIEW

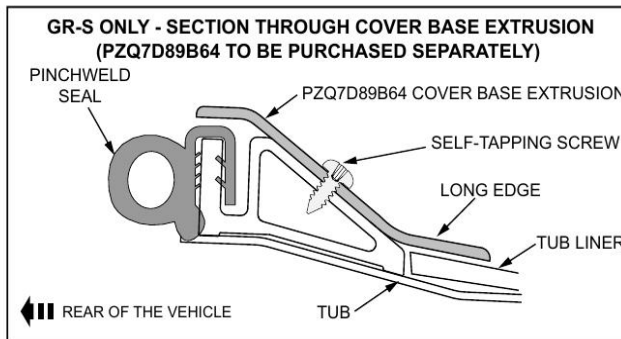
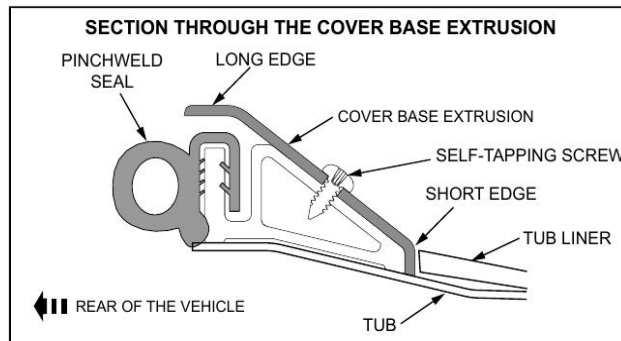
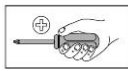

FIG. 15 Fit the base extrusion cover over the pinchweld seal and align the cover with the pre-drilled holes in the base extrusion. Fit the cover into place using the four self-tapping screws.

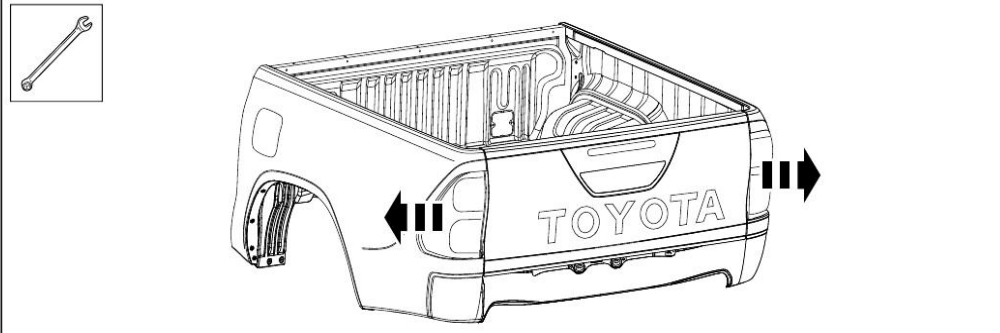

FIG. 16 Remove the taillights and store in a safe place.

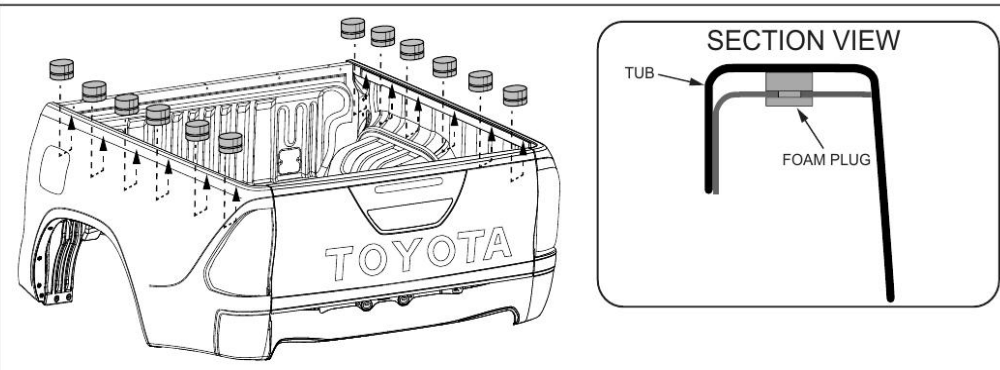

FIG. 17 Fit the 12 foam plugs to the inside of the tub as shown in section view.

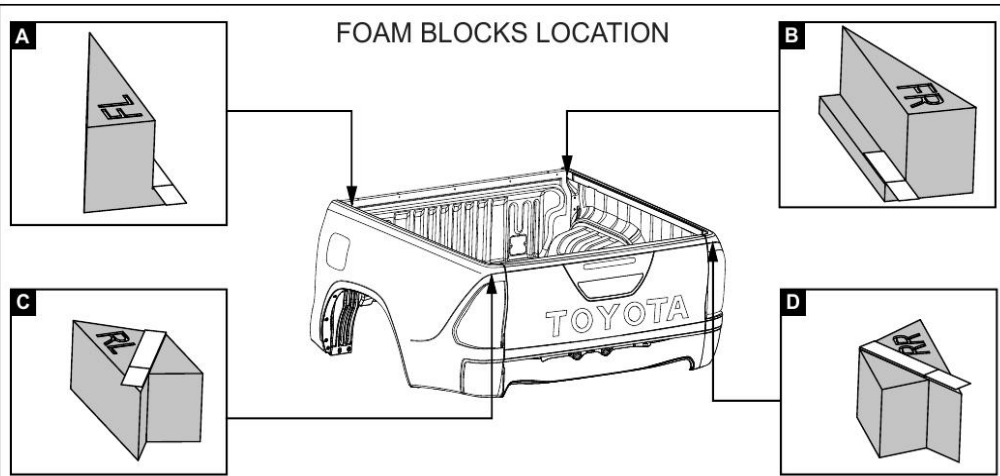

FIG. 18 From the inside of the tub, fit the 4 foam pads and secure with the double sided tape.
Detail fitment in the next steps.

