



**HARDLIDS & ACCESSORIES**

**RAD HARDLID - NAVARA 2014-2020  
STANDARD - FITTING INSTRUCTION**

Vehicle bodies and vehicle installation can vary, so please read the following instructions as they refer to important information which could affect the quality of the final installation.

- If a Bedliner is fitted, there may be some additional trimming required.
- Recommended installation by 2 people.

**1**

- Clean & wiped dry top rails to prepare for the hard lid installation.



**2**

- Clean & wiped dry front wall
- Trim any bedliner down 30mm along the red line.

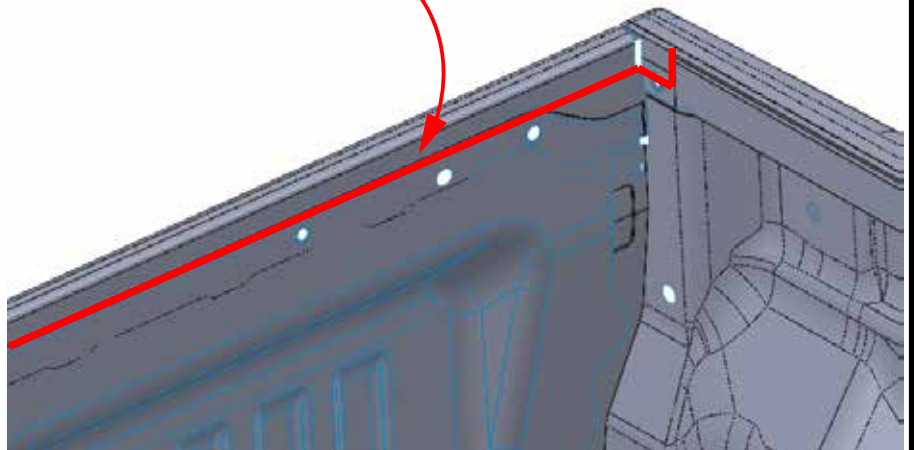

3

- Peel off the backing from the double-sided tape on the front aluminium profile.
- Position it as shown in the diagram, aligning it with the top of the front wall of the tub.
- Press firmly to fix it in place

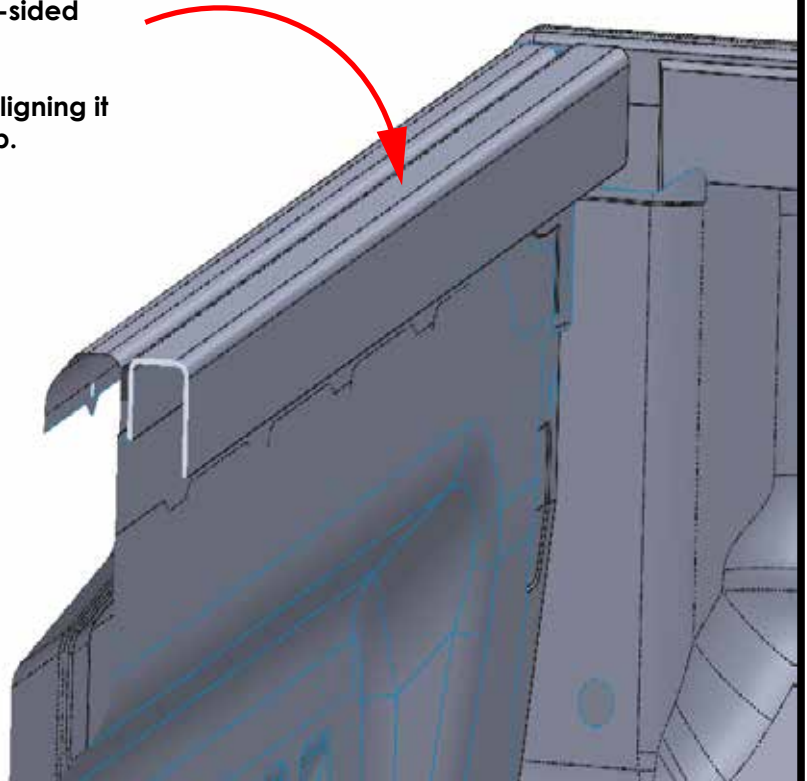

- Use Silicone sealant to seal both ends of the profile.

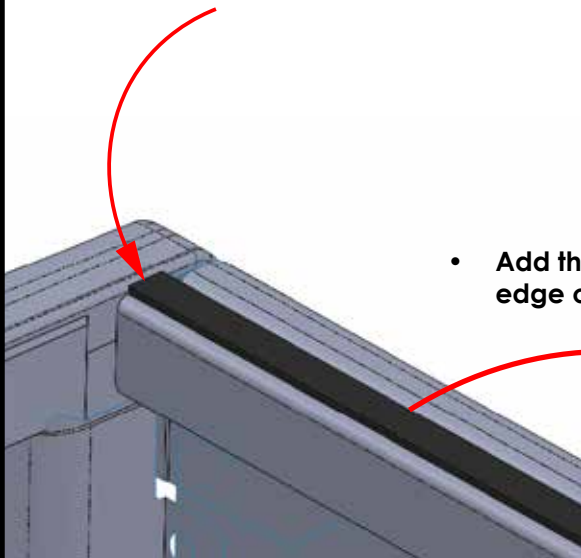

- Add the 3mm foam tape along the whole rear edge of the aluminium profile.

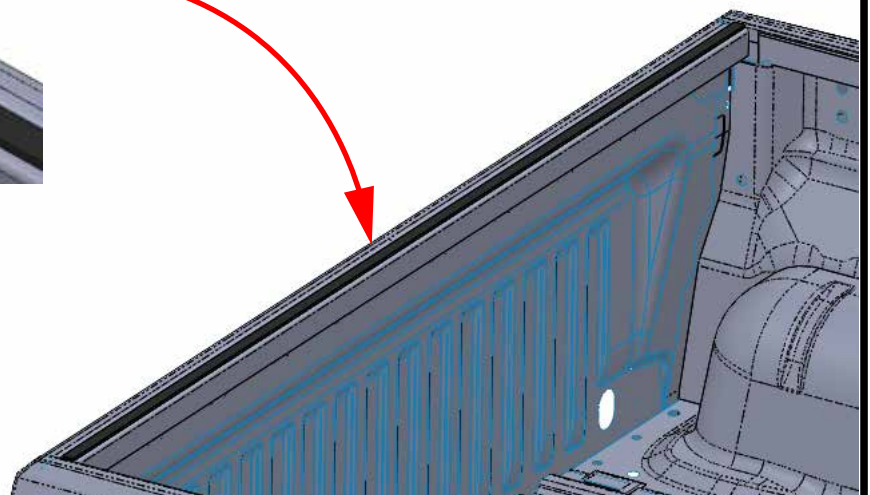

4

- Carefully with two people lift and drop in the Hard lid,
- Drop the front end it first followed slowly by the rear.

**NOTE:** Having the tailgate down helps to avoid hitting it.

Lorem ipsum

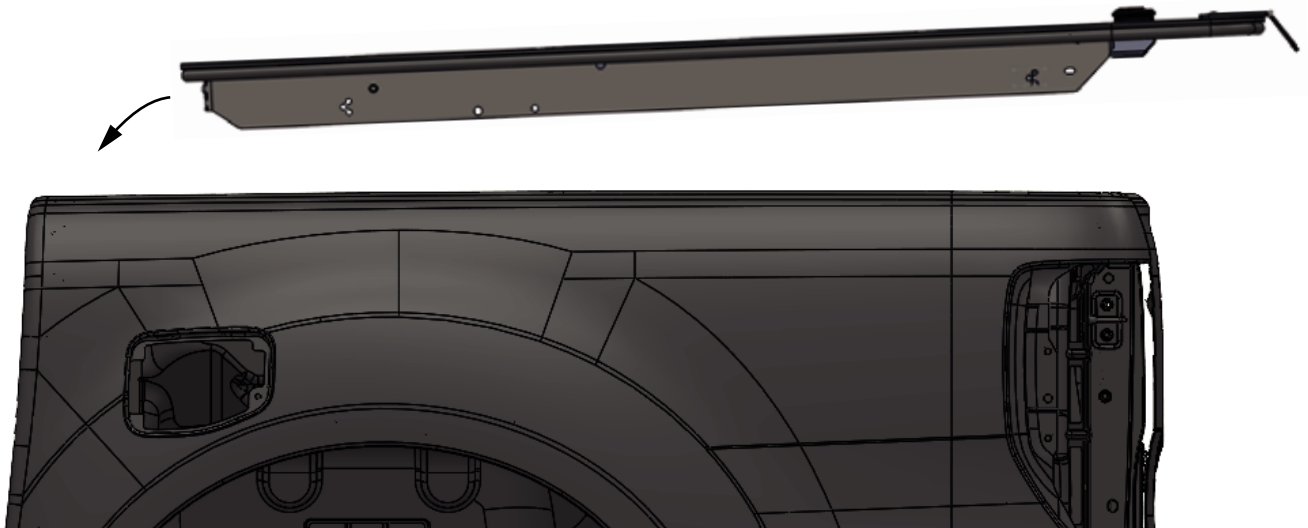

# RAD

## HARDLIDS & ACCESSORIES

5

Ensure the lid is pushed as far forward as possible. Push on both rear corners to make sure both sides are hard up against the front wall of the deck.

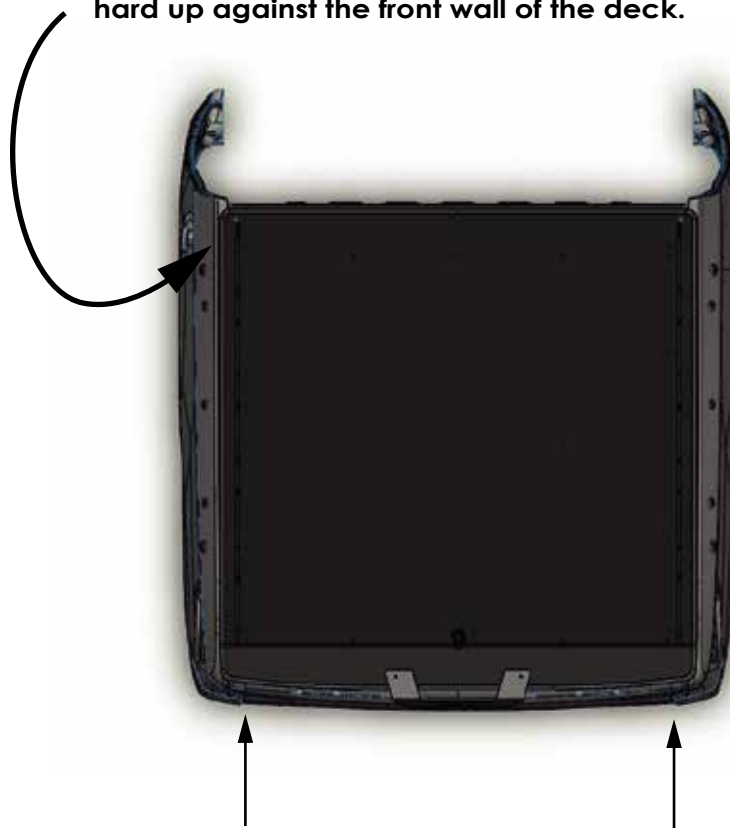

6

- Open lid by twisting handle.
- With one person on each rear corner, lift the lid open.
- While one person holds the lid open, install the gas struts as shown.

Note:  
While opening the lid hold the rails against the deck to stop them slipping off the deck rail.

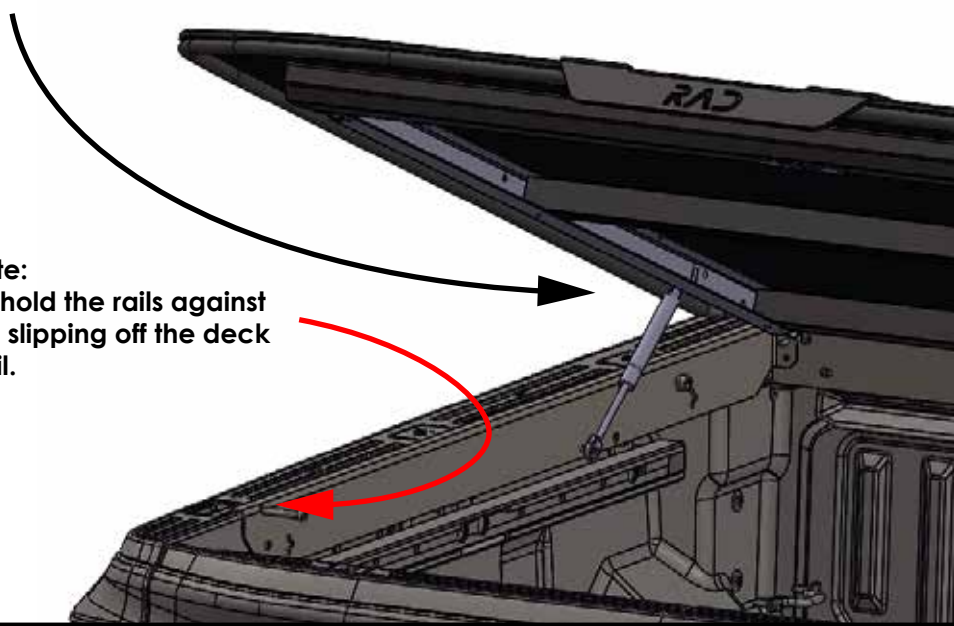

7

**ATTACHMENT BRACKET**  
The attachment bracket needs to have the 45 degree fold at the top.

M8  
WASHER

M8  
SPRING WASHER

M8x40mm

- The attachment brackets are assembled as shown.
- Ensure parts are fitted in correct order as shown.
- Use the hole closest to the bottom of the vehicle rail.

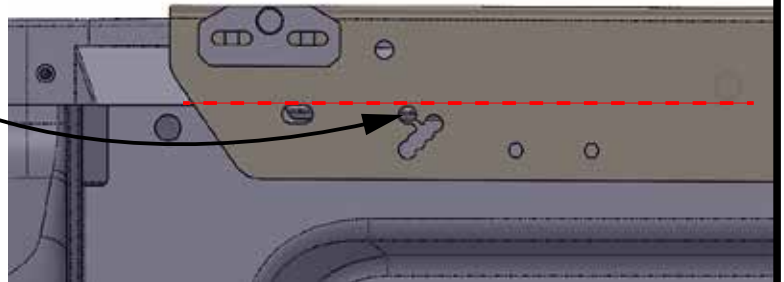

- The attachment brackets go in the 4 corners
- Loosely put all 4 attachment brackets in.
- Push down on the rails and tight the brackets at 1 & 2 first.
- Push down on the rails and tight the brackets at 3 & 4 last.

1 & 2

3 & 4

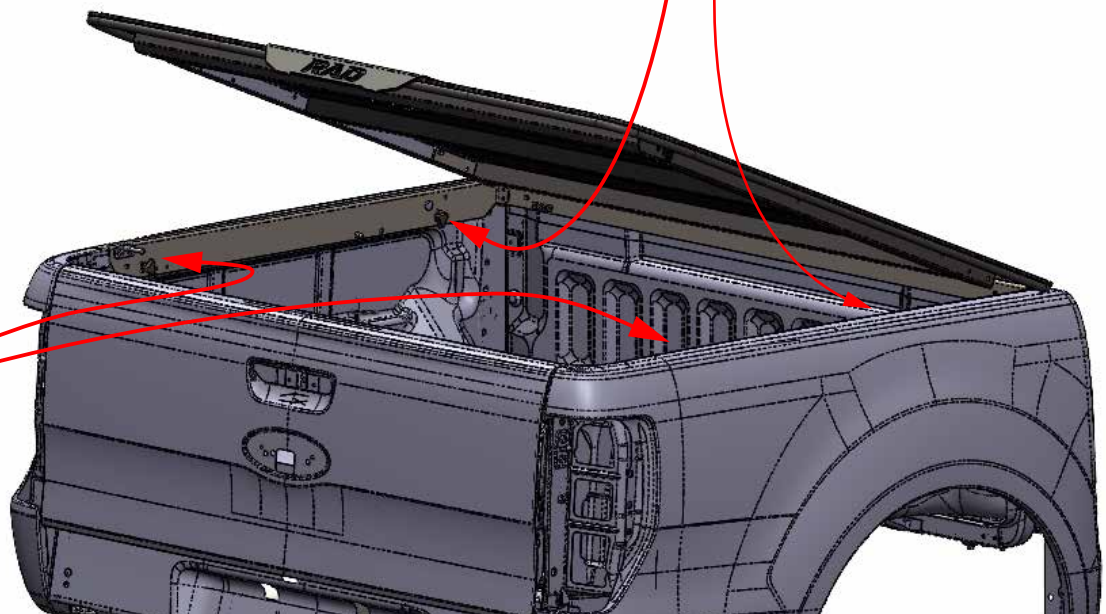



8

- Adjust the latch pin back or forward to have it centred in the latch.
- It is important to make sure it is centred and is not catching on the side of the latch.
- Tighten M6 nuts once it is in place.

The pin needs to not catch on these surfaces.

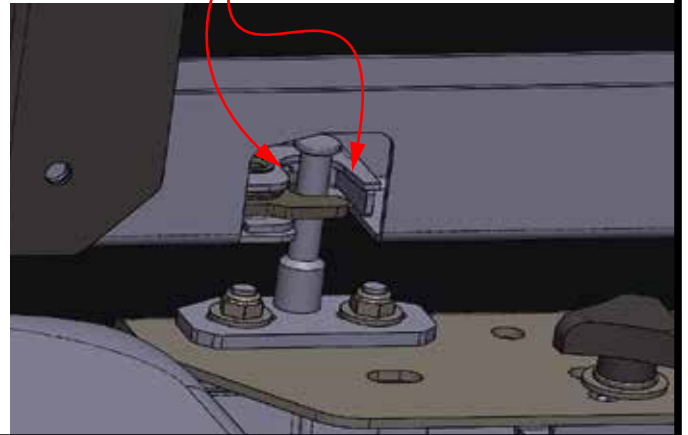
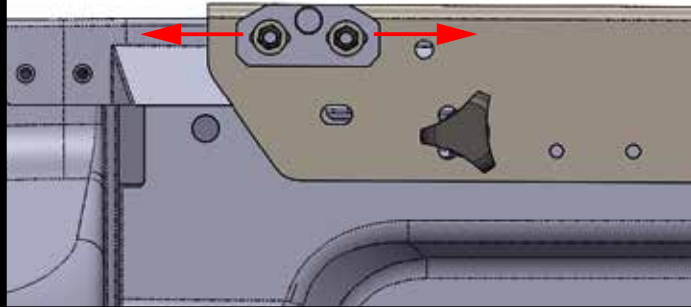

9

- Adjust the latch up and down till the lid latches to the customers liking.
- Ensure the lid seals well around the d-seal.

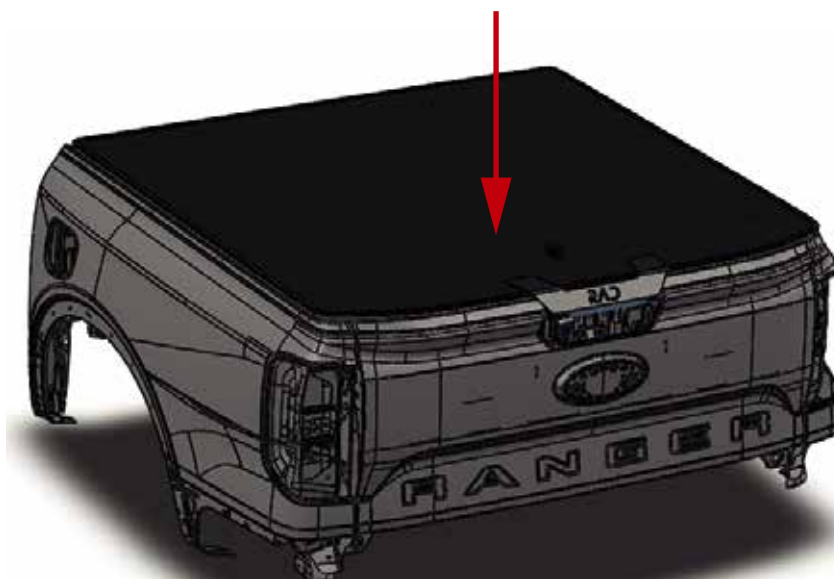
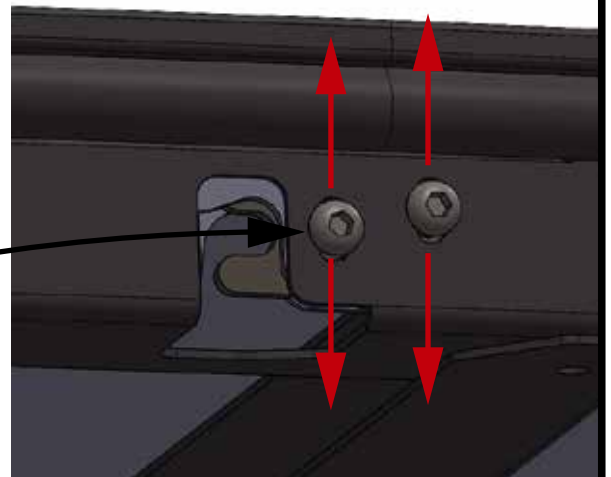

**Thank you for getting**

***RAD***

**FIND US @  
RADHARDLIDS.CO.NZ**