

# Advanced Wireless Foot Pedal 12V Power Cable

**⚠ WARNING:** This product must be installed in accordance with the instructions provided. Failure to do so could result in personal injury, damage to your vessel and/or poor product performance.

**⚠ WARNING:** Performing service or maintenance without first disconnecting the battery can cause product damage, personal injury, or death due to fire, explosion, electrical shock, or unexpected motor starting. Always disconnect the battery cables from the battery before maintaining, servicing, installing, or removing motor components.

## In the box

- 1x 12 V power cable (2 m (6.56 ft), 0.75 mm<sup>2</sup> (18 AWG))
- 1x 3 A fuse

## Tools needed

- #2 Phillips screwdriver
- Torque wrench

## Installation

To remove the existing power cable from your trolling motor:

- 1 Disconnect the existing 12 V power cable from its battery.
- 2 Remove the center clip and FlipSwitch cover, and make sure there are no batteries in the battery compartment.
- 3 If your foot pedal is mounted to your boat, unbolt it.
- 4 Turn the pedal over and use a #2 Phillips screwdriver to remove the eight Phillips screws that secure the base plate.
- 5 Remove the base plate.

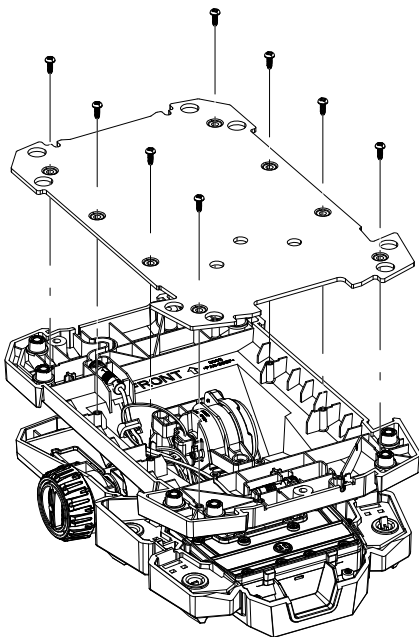

- 6 Remove the existing 12 V cable (A) from the strain relief channel in the pedal. Disconnect the existing 12 V cable from the connector in the foot pedal (B).

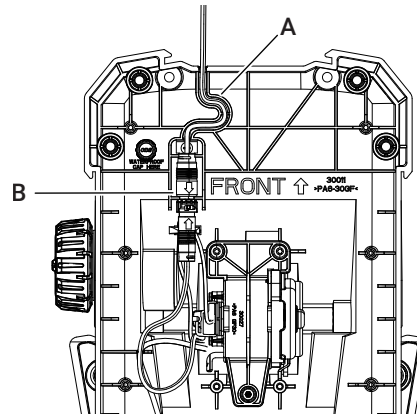

To install the new 12 V power cable:

- 7 Connect the 2-pin end of your new 12 V power cable to the connector (B in the diagram above) and fit the cable into the strain relief channel.
- 8 Replace the base plate and the eight screws that hold it. Tighten to torque 0.9 Nm (8 in-lb).  
→ **Note:** Do not use power tools when tightening to avoid stripping of the plastic screw bosses or fastener head.
- 9 If your foot pedal was mounted to your boat, remount it.
- 10 Install the included 3 A in-line fuse (A) on the foot pedal's positive (+) wire (B).  
→ **Note:** If you need to extend the power cable up to 3 m (10 ft), use 0.75 mm<sup>2</sup> (18 AWG) wire or larger.
- 11 Re-connect the bare end of the 12 V power cable to the battery.

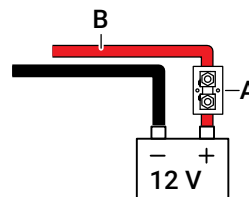

**⚠ WARNING:** You cannot use the same 24 V or 36 V battery system used to power the trolling motor. You need a dedicated 12 V power source. The cranking/electronics battery can be used if it is a 12 V battery.